

Senior Cohousing: A Community Approach to Independent Living

Sponsored by:

AIA **Design for Aging** (DFA) Knowledge Community

Moderator:

Mark Heckman, AIA – Moseley Architects

Presenter:

Charles Durrett, AIA – The Cohousing Company

Design for Aging



The mission of the AIA **Design for Aging** (DFA) Knowledge Community is to foster design innovation and disseminate knowledge necessary to enhance the built environment and quality of life for an aging society.

Continuing education credits

Earn 1 AIA LU

This program is registered with the AIA/CES for continuing professional education. As such, it does not include content that may be deemed or construed to constitute approval, sponsorship or endorsement by AIA of any method, product, service, enterprise or organization.

The statements expressed by speakers, panelists, and other participants reflect their own views and do not necessarily reflect the views or positions of The American Institute of Architects, or of AIA components, or those of their respective officers, directors, members, employees, or other organizations, groups or individuals associated with them.

Copyright notice

This presentation is protected by US and International Copyright laws. Reproduction, distribution, display and use of the presentation without written permission of the speaker is prohibited.

© The American Institute of Architects 2021

Questions?

Submit your questions through the Q&A pod at the bottom of your screen.

Content-related questions will be answered during the Q&A portion as time allows. Any questions not answered during Q&A, will be answered and posted online within two (2) weeks.

Tech support questions will be answered by AIA staff.

Presenter

Charles Durrett, AIA

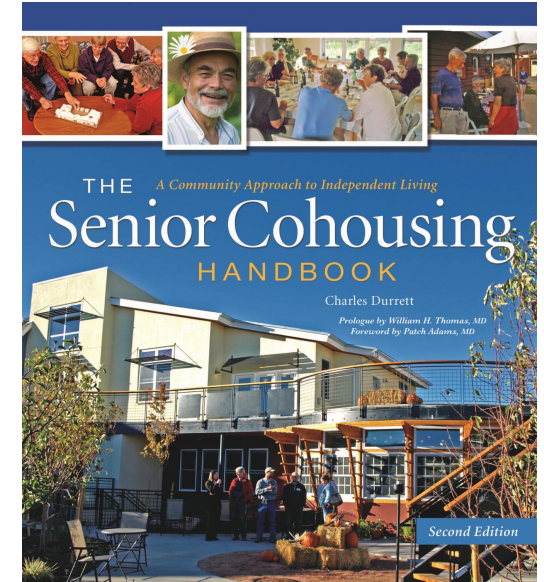
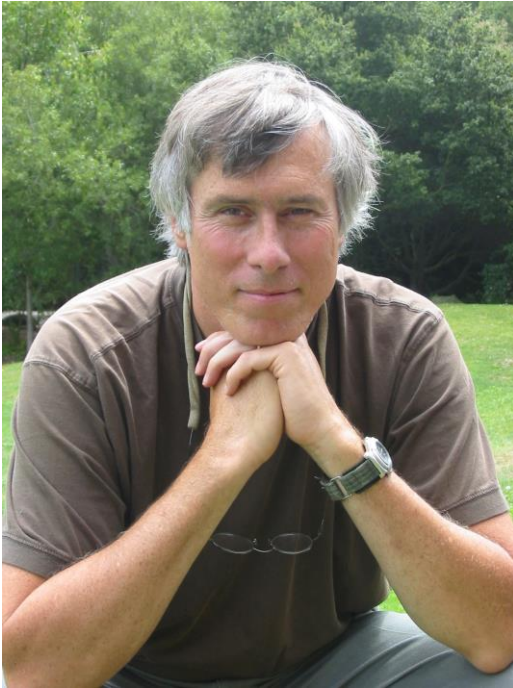



















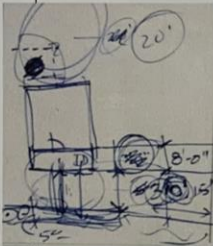

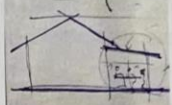

Part 3. Program Places

| Place | Activities | Character | Relationship | Details |
|-------------|---|---|--------------|--|
| Front Porch |  | | | <ul style="list-style-type: none"> 8' front porch 15'-33' door to door |
| Place | Activities | Character | Relationship | Details |
| Front Yard |  |  | | <ul style="list-style-type: none"> 10' deep |
| Place | Activities | Character | Relationship | Details |
| Back Yard |  | | | <ul style="list-style-type: none"> 20' deep |

Part 3. Program Places

| Place | Activities | Character | Relationship | Details |
|--------------------|--|--|---|--|
| Common Terrace | <ul style="list-style-type: none"> Cooking/dining Dancing/music/movies/theater/entertainment Drinking and conversation Games/crafts Raising the flag Enjoying a fire |   | <ul style="list-style-type: none"> Faces south | <ul style="list-style-type: none"> 35 people (based on 2 meals/week) Temporary coverage (deferred) Wind screen (deferred) Radiant heat Pavers Accessible |
| Place | Activities | Character | Relationship | Details |
| Storage (Bikes) | <ul style="list-style-type: none"> Bike storage 0.86/hh (17 bikes now, 14 anticipated in current group) | <ul style="list-style-type: none"> Could be same as a garage Note: different storage shed types | <ul style="list-style-type: none"> Near tools/workshop | <ul style="list-style-type: none"> With electric service for electric bikes |
| (Boats) | <ul style="list-style-type: none"> Kayaks 0.25/hh (4 now) | <ul style="list-style-type: none"> harmonious, attractive, cute | <ul style="list-style-type: none"> Could be on exterior wall of garages | <ul style="list-style-type: none"> 17'-24' long |
| (Garden Shed) | <ul style="list-style-type: none"> Potting | <ul style="list-style-type: none"> Could be same as a garage | <ul style="list-style-type: none"> Near garden Probably near vehicular access | |
| (Shared storage) |  | | | |
| (Personal storage) | <ul style="list-style-type: none"> Other options for personal storage: attics, garages, etc. | |  |  |



NORTH



McCamant and Durrett Architects
SCHEMATIC ARTIST'S RENDERING



TOTAL AREA = 2,910 SF

| REVISIONS | | BY |
|-----------|--|----|
| | | |
| | | |
| | | |
| | | |
| | | |

**PRELIMINARY:
NOT FOR CONSTRUCTION**

McCommet & Durrett Architects
 111 E. Commercial Street, Suite 200, Portland, OR 97239
 Tel: 503.255.1888 Fax: 503.255.1888
 WA Lic: 000-402-308 E-mail: info@mcmetdurrett.com

**QUIMPER VILLAGE
SENIOR COHOUSING**
 F Street, Port Townsend, WA, 98368

**COMMON HOUSE
FLOOR PLAN**

IF SHEET SIZE IS 24X36 DRAWING IS SHOWN AT 100%, IF SHEET SIZE IS 11X17, DRAWING IS SHOWN REDUCED TO 60%

| SCHEMATIC DESIGN | |
|------------------|-------------|
| Date | 12 MAR 2015 |
| Scale | AS NOTED |
| Drawn | GAB |
| Job | PTT |
| Sheet | |













Private



Common



Quimper Village

www.quimpervillage.com



Site Program and Design Criteria

Write-up from Site Planning Workshop
Facilitated by Charles Durrett
Write-up by Erik Bonnett
McCamant & Durrett Architects
Port Townsend, Washington
January 31 - February 3, 2015

www.cohousingco.com
530.265.9980

copyright © 2015 McCamant & Durrett Architects





McCamant & Orrison
241 S. Commercial Street
Norfolk, VA 23510
www.mccamant.com













GROUP HOUSE SECOND FLOOR PLAN
1/8" = 1' - 0" 3,714 SF



GROUP HOUSE FIRST FLOOR PLAN
1/8" = 1' - 0" 3,714 SF

PROGRAM TEST #1, IT'S ONLY ONE POSSIBLE TEST.
MOSTLY IT SUGGESTS THE SIZE OF THE SITE THAT WE MIGHT START PURSUING.
PROGRAM TEST #1 WAS DONE BEFORE THE PROGRAM WAS CONSENSUED MAKING IT CURSORY AT BEST, OR PERHAPS IRRELEVANT FOR ANYTHING BUT SITE SELECTION. THIS IS NOT ARCHITECTURE, THIS IS TESTING THE PROGRAM.



SITE SIZE: 66,706 SF
COMMON HOUSE SIZE PER FLOOR: 3,000 SF

1 TESTING SITE DIAGRAM 1.0
Scale: 1/32" = 1'-0"

| | |
|---|---|
| REVISION | B |
| S | Y |
| 2418 Commercial Street, Nevada City, CA 95959 Tel: 530.266.9800 Fax: 530.266.4000 www.cottolungco.com cotto@cottolungco.com | |
| | |
| PROJECT NAME LINE 1 PROJECT NAME LINE 2 Project Address, City, State Zipcode | |
| TESTING SITE DIAGRAM 1.0 | |
| Date: 6 JAN 2021 Scale: 1/32" = 1'-0" Drawn: JY Job: WELL Sheet | |
| SK1 of 0 sheets | |

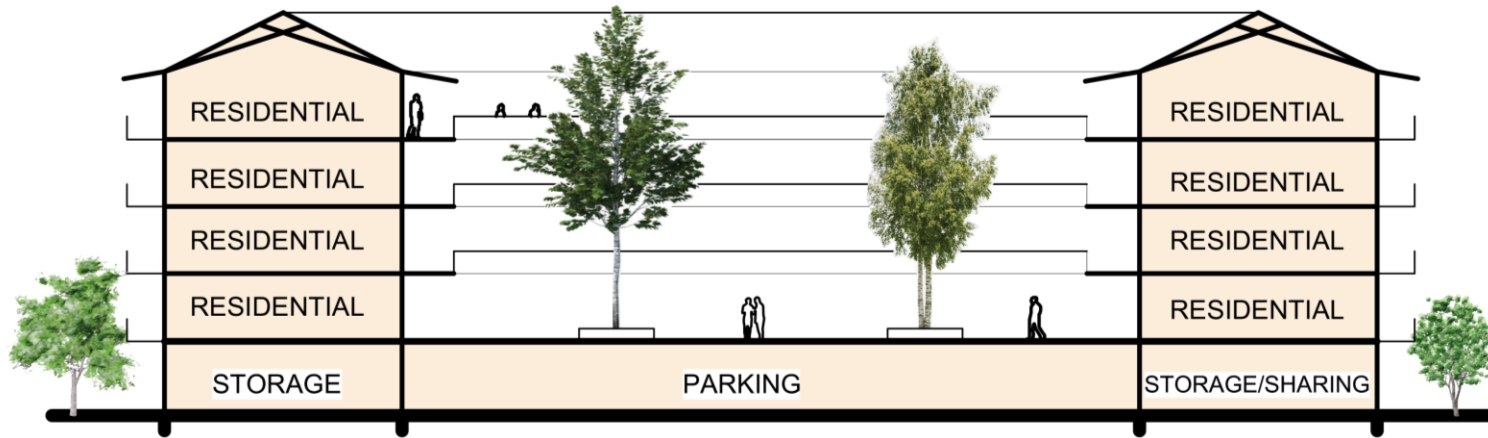

2 **CROSS SECTION DIAGRAM 2.0**
Scale: 1/32" = 1'-0"

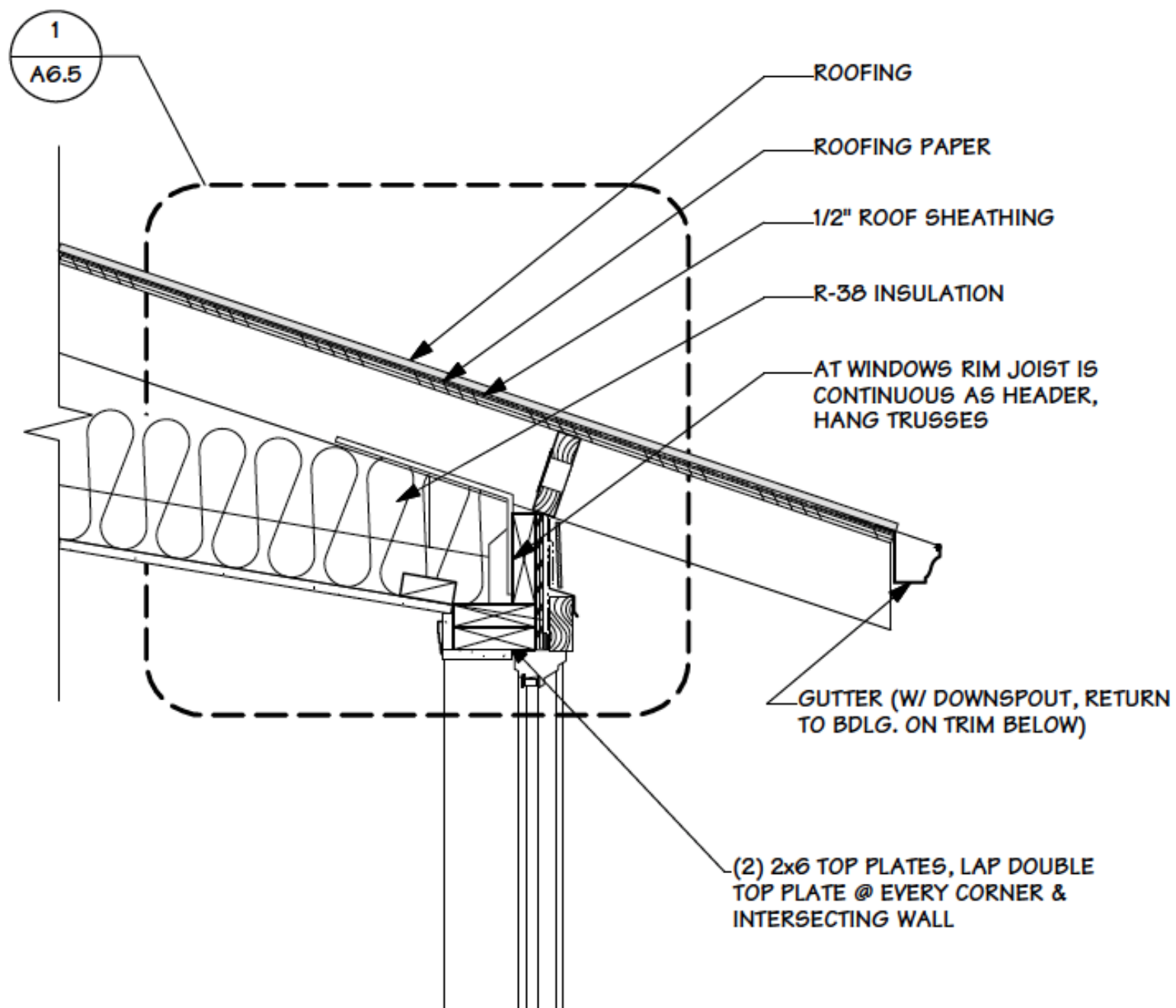











THE *A Community Approach to Independent Living*
Senior Cohousing
HANDBOOK

Charles Durrett

Prologue by William H. Thomas, MD

Foreword by Patch Adams, MD

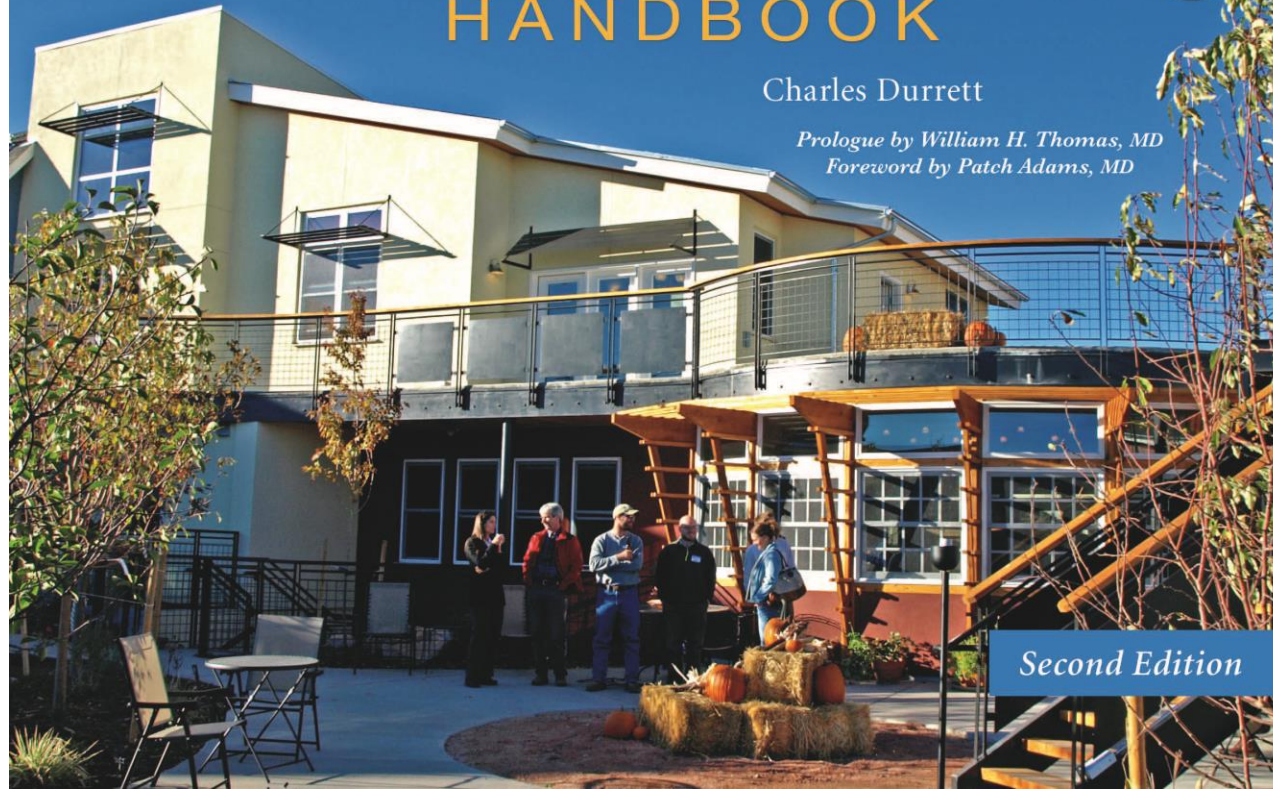

Second Edition

A Solution to Homelessness in Your Town

Valley View Senior Housing, Napa County,
California

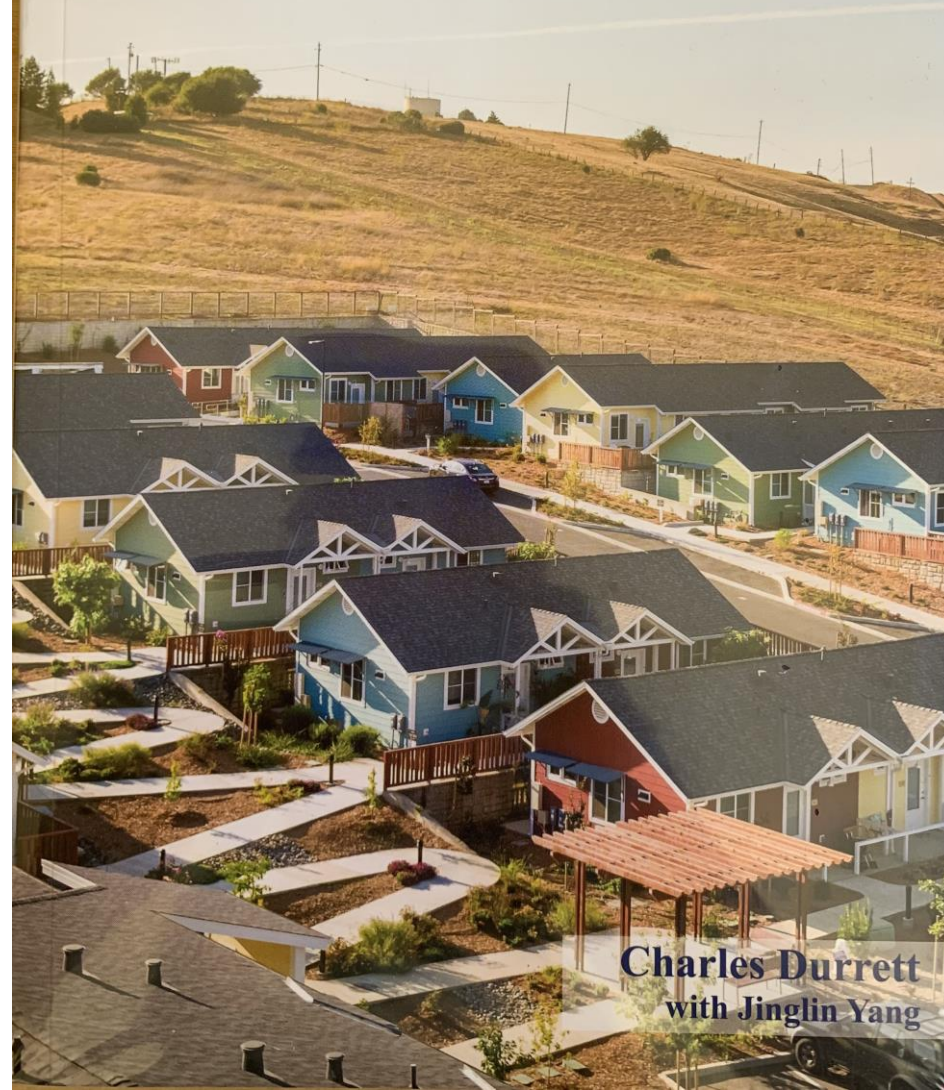

Charles Durrett
with Jinglin Yang

Time for questions and comments

??????

Feedback survey

We encourage all attendees to complete the post course survey at <https://form.jotform.com/211334581858157> by **Friday May 21, 2021**, at 5pm ET.

Please email knowledgecommunities@aia.org if you have any questions.

Thank you!

aia.org/dfa

AIA KnowledgeNet Q Sign in

[Home](#) [Communities](#) [Directory](#) [Events](#) [Browse](#) [Participate](#)

Design for Aging

[Community Home](#) [Discussion 89](#) [Library 114](#) [Blogs 23](#) [Our Events 2](#) [Members 4.3K](#)

[Join our community >](#)

Quick Links

- [Leadership](#)
- [Our History](#)
- [Initiatives](#)
- [Newsletter Archive](#)
- [15th Edition DFA Review Projects](#)
- [Past Review Awards](#)
- [Research](#)
- [Presentations & Whitepapers](#)
- [Local Chapters](#)
- [Sponsorship](#)

Who we are

The mission of the AIA **Design for Aging** (DFA) Knowledge Community is to foster design innovation and disseminate knowledge necessary to enhance the built environment and quality of life for an aging society. This includes relevant research on characteristics, planning and costs associated with innovative design for aging. In addition, DFA provides outcome data on the value of these design solutions and environments.

COVID resources

Strategies for Safer Senior Living Communities
This resource includes strategies for dining facilities, amenity spaces, and individual units. [Download >](#)

Upcoming Events

| | |
|-----------|---|
| 22 Feb | Live course: Senior Housing Design Directions for a Post-Pandemic World Feb 22, 12:00 PM - 1:00 PM (ET) |
| 28 Aug | Environments for Aging Aug 28 - 31, (ET) Chattanooga, TN, United |