



**The American
Institute
of Architects**

Academy of
Architecture for Health

an **AIA** Knowledge Community

Big Ideas for Small Facilities: Innovations in Rural Hospital Design

November 12, 2019
Amy Douma, HGA



**The American
Institute
of Architects**

Academy of
Architecture for Health
an AIA Knowledge Community

Big Ideas for Small Facilities: Innovations in Rural Hospital Design

November 12, 2019

Moderated by: Yvonne Nagy





The American
Institute
of Architects

Academy of
Architecture for Health

an AIA Knowledge Community

Case Study Series

As part of the Academy's multi-channel, on-line approach, these sessions provide emerging and experienced professionals with convenient and economical opportunities to develop their chosen area of interest.

The **Case Study Series** is intended to introduce members of healthcare-centric practices, in all stages of professional development, to case studies of relevant content, providing access to data and critical analysis of elements critical to the project's success.



**The American
Institute
of Architects**

Academy of
Architecture for Health

an **AIA** Knowledge Community

Copyright notice

This presentation is protected by US and International Copyright laws. Reproduction, distribution, display and use of the presentation without written permission of the speaker is prohibited.

© The American Institute of Architects 2019



The American
Institute
of Architects

Academy of
Architecture for Health

an AIA Knowledge Community

Compliance Statement

“AIA Knowledge” is a Registered Provider with The American Institute of Architects Continuing Education Systems (AIA/CES). Credit(s) earned on completion of this program will be reported to AIA/CES for AIA members. Certificates of Completion for both AIA members and non-AIA members are available upon special request.

This program is registered with AIA/CES for continuing professional education. As such, it does not include content that may be deemed or construed to be an approval or endorsement by the AIA of any material of construction or any method or manner of handling, using, distributing, or dealing in any material or product.



**The American
Institute
of Architects**

Academy of
Architecture for Health

an **AIA** Knowledge Community

AIA/CES Reporting Details

In order to receive 1 AIA LU/HSW credit, each attendee must complete the webinar survey at the conclusion of the presentation.

A link will be provided in the chat box and included in a follow-up email one (1) hour after the webinar to the individual who registered your site.

Questions?

Submit a question to the moderator via the chat box.

Content-related questions will be answered during the Q&A portion, at the end of the presentation, as time allows. Any questions not answered during Q&A, will be answered and posted online within two (2) weeks.

Tech support questions will be answered by AIA staff promptly.

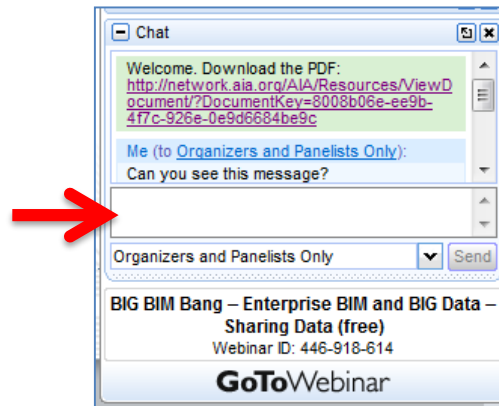



**The American
Institute
of Architects**

Academy of
Architecture for Health

an **AIA** Knowledge Community



Amy Douma



Kara Freihoefer



Virginia Riffle





AGENDA

- Challenges of Rural Care
- Innovation Case Studies
- Implementation Challenges & Tools
- Questions / Discussion



CHALLENGES OF RURAL CARE



FINANCIAL STRUGGLES

- 44% of rural hospitals operate at a loss; 30% operate below a -3% margin
- Rural hospitals have absorbed \$318M in government funding cuts, resulting in a loss of 7,129 community healthcare jobs

A scenic photograph of a rural landscape. In the foreground, there is a field of tall, golden-brown grass. In the middle ground, a small, rustic wooden barn with a stone chimney stands on the right. The background features a range of mountains, some with patches of snow, under a blue sky with scattered white clouds.

WORKFORCE SHORTAGES

- 77% of rural U.S. counties are designated as Health Professional Shortage Areas
- Nearly 30% of rural PCPs are at or nearing retirement age; practitioners under 40 account for 20% of workforce
- Only 11% of physicians practice in rural America; 8400 additional PCPs are needed



Results: Access Challenges

- Rural Americans comprise 16% of the population, but reside in 95% of the U.S. land area
- In an emergency, rural patients travel twice as far as urban patients; 60% of trauma deaths occur in rural America
- Over 1/3 of rural hospitals considered vulnerable or in danger of closing



Results: Design Implications

- Necessity to leverage resources
- Highly unpredictable volumes
- Creative problem solving & spirit of collaboration

A wide-angle photograph of a lush green field at sunset. The sun is low on the horizon, casting a warm, golden glow across the sky and the field. A line of trees is visible in the distance, and a dirt path leads from the foreground towards the horizon. The text "INNOVATION CASE STUDIES" is overlaid in white, bold, sans-serif font in the lower right quadrant.

INNOVATION CASE STUDIES

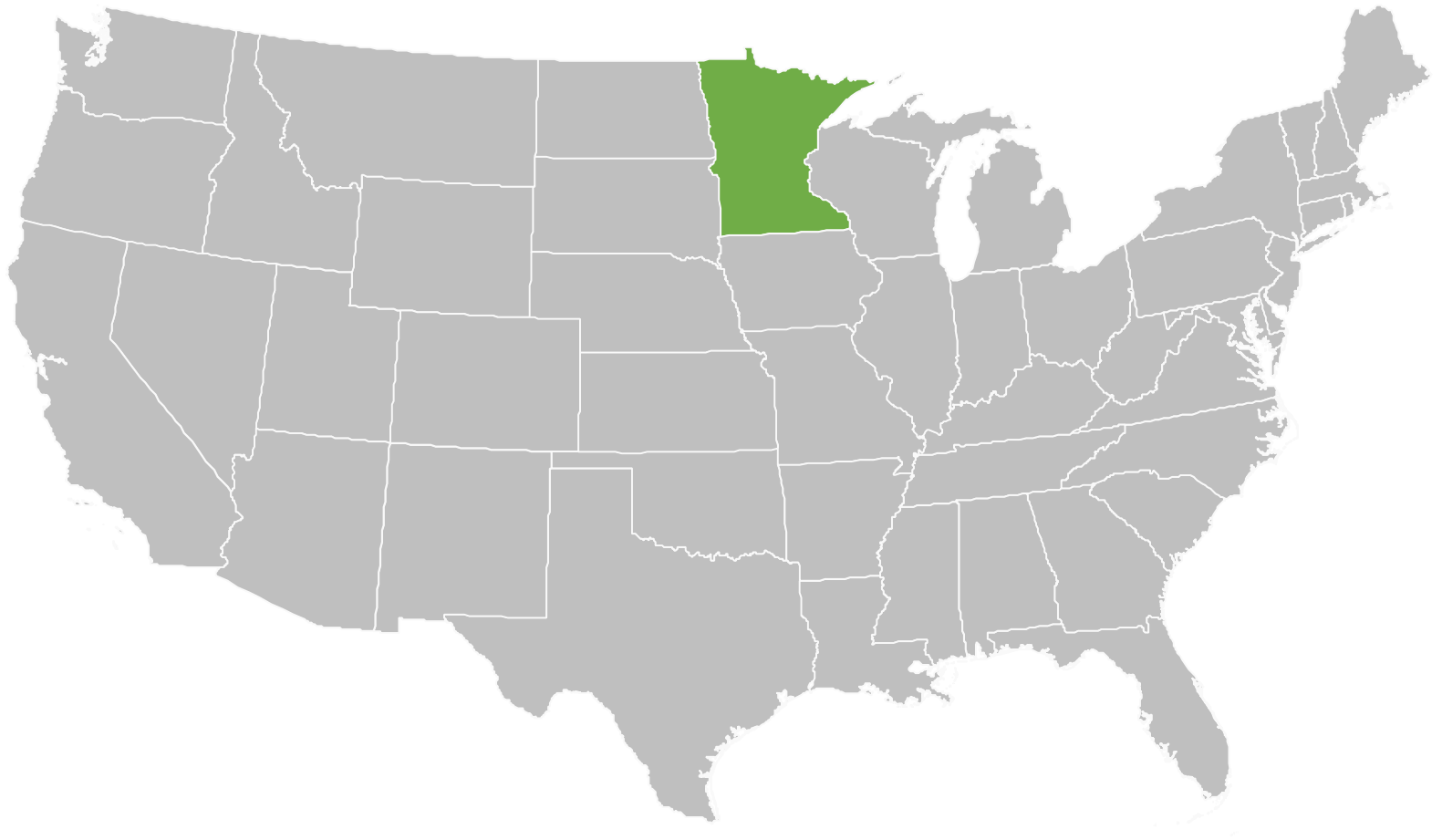

CentraCare Health System

CentraCare Health System

- Largest healthcare provider in central Minnesota
- Central hub campus with five Critical Access Hospitals

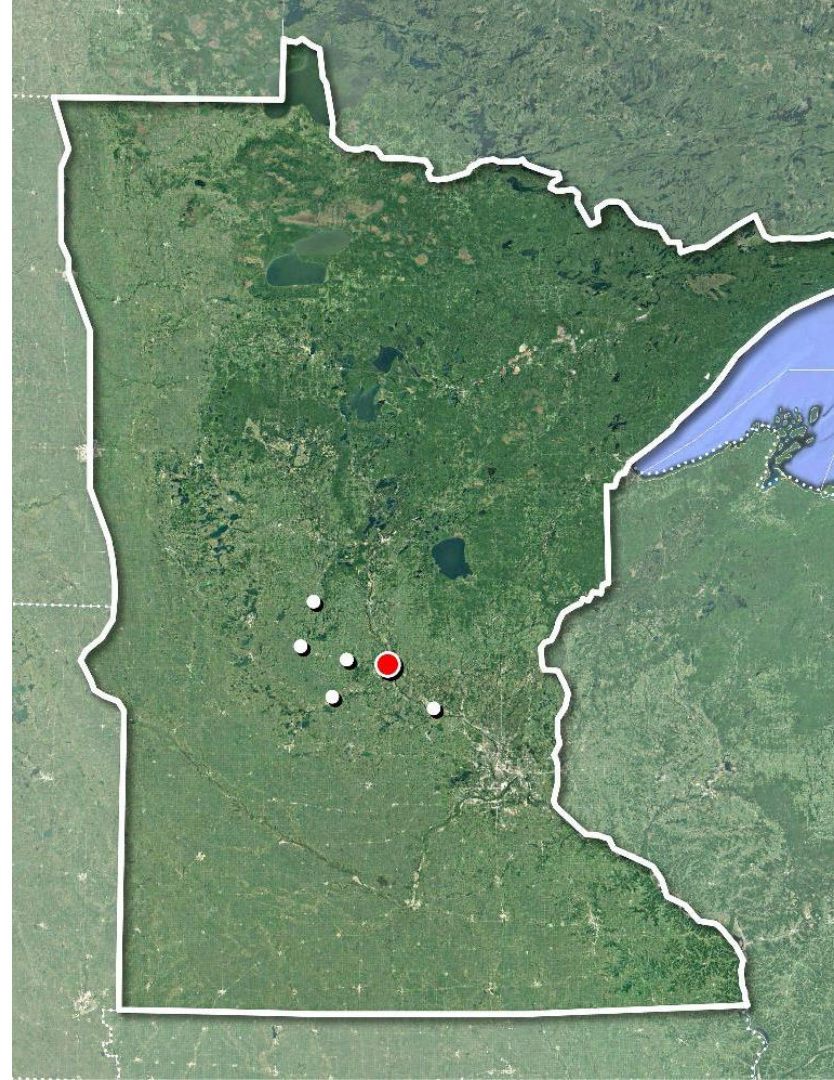

Challenges

- Financial, staffing – efficiency
- Long-term flexibility to respond to changing demographics and market pressures



Universal Care Platform

- Group of flexible rooms that serves multiple departments
- Departments with different peak volumes share space

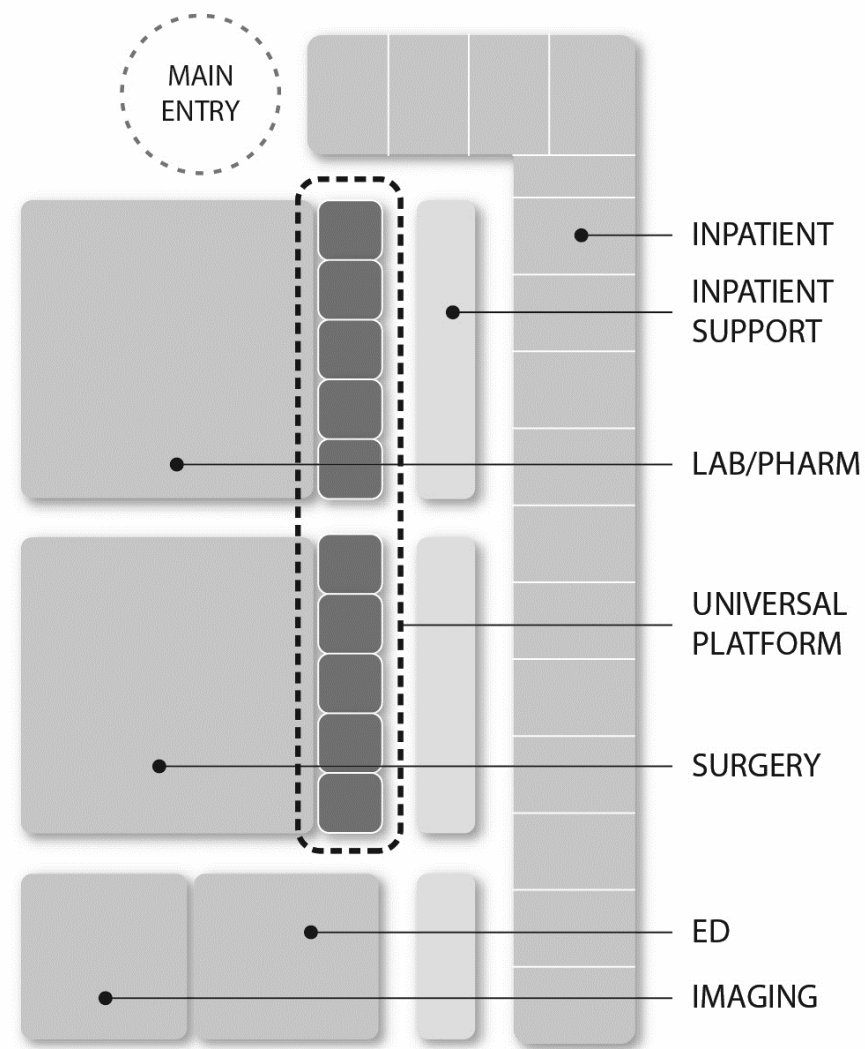

Current Time

2:00 pm

Observation

Surgery

ED



Current Time

5:00 pm

Observation

Surgery

ED



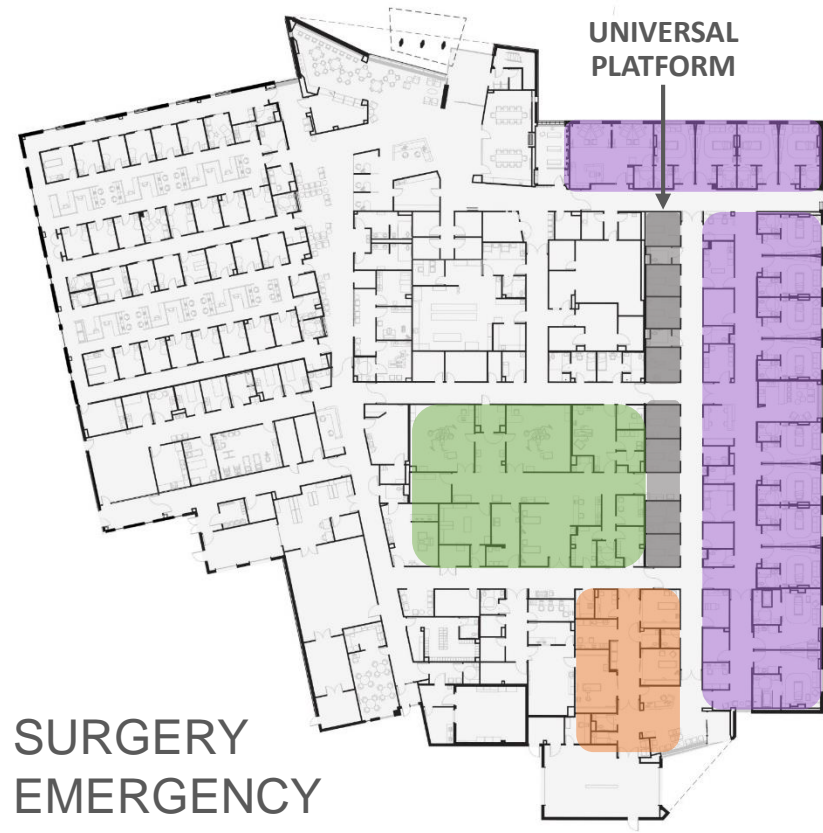
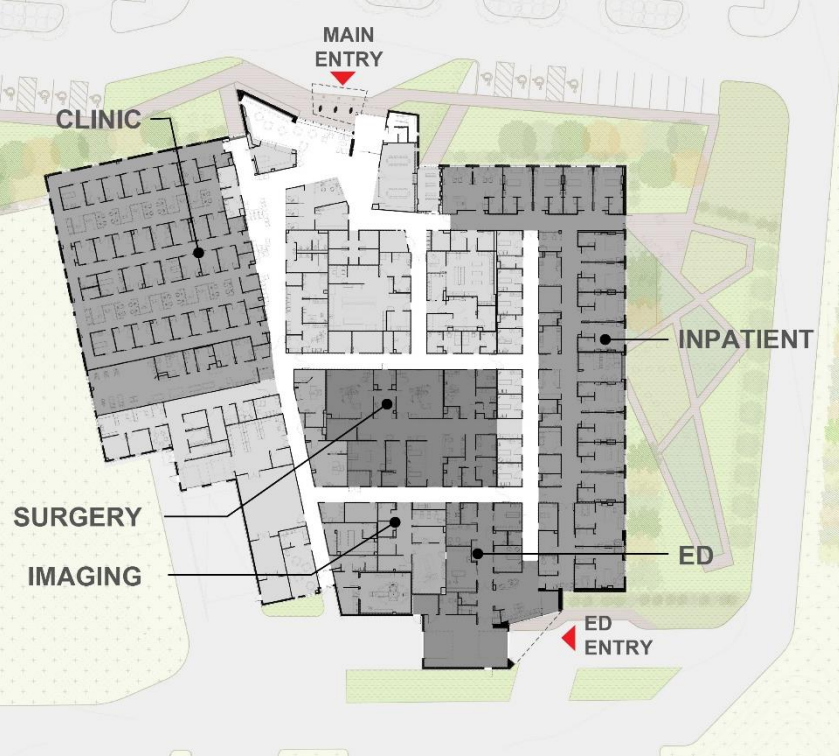

- SURGERY
- EMERGENCY
- OBSERVATION
- INPATIENT

LONG PRAIRIE



Results

- Flexible space for daily volume spikes, long-term service line shifts
- Staffing flexibility – cross-trained to serve variety of patient types as needed from central location
- Cost-savings – reduction of 2500 sf, \$1M in construction costs alone

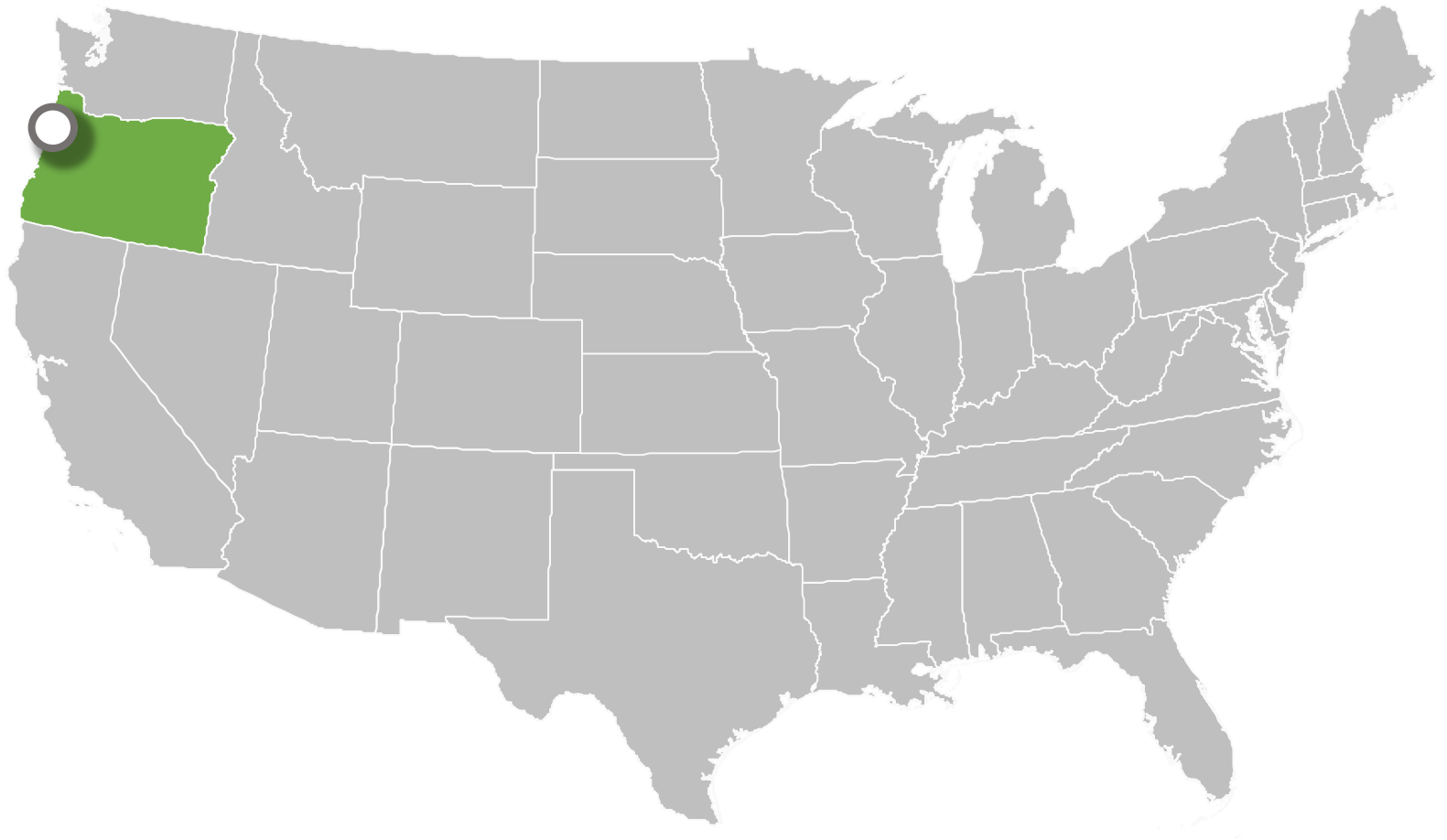

Samaritan Health Services

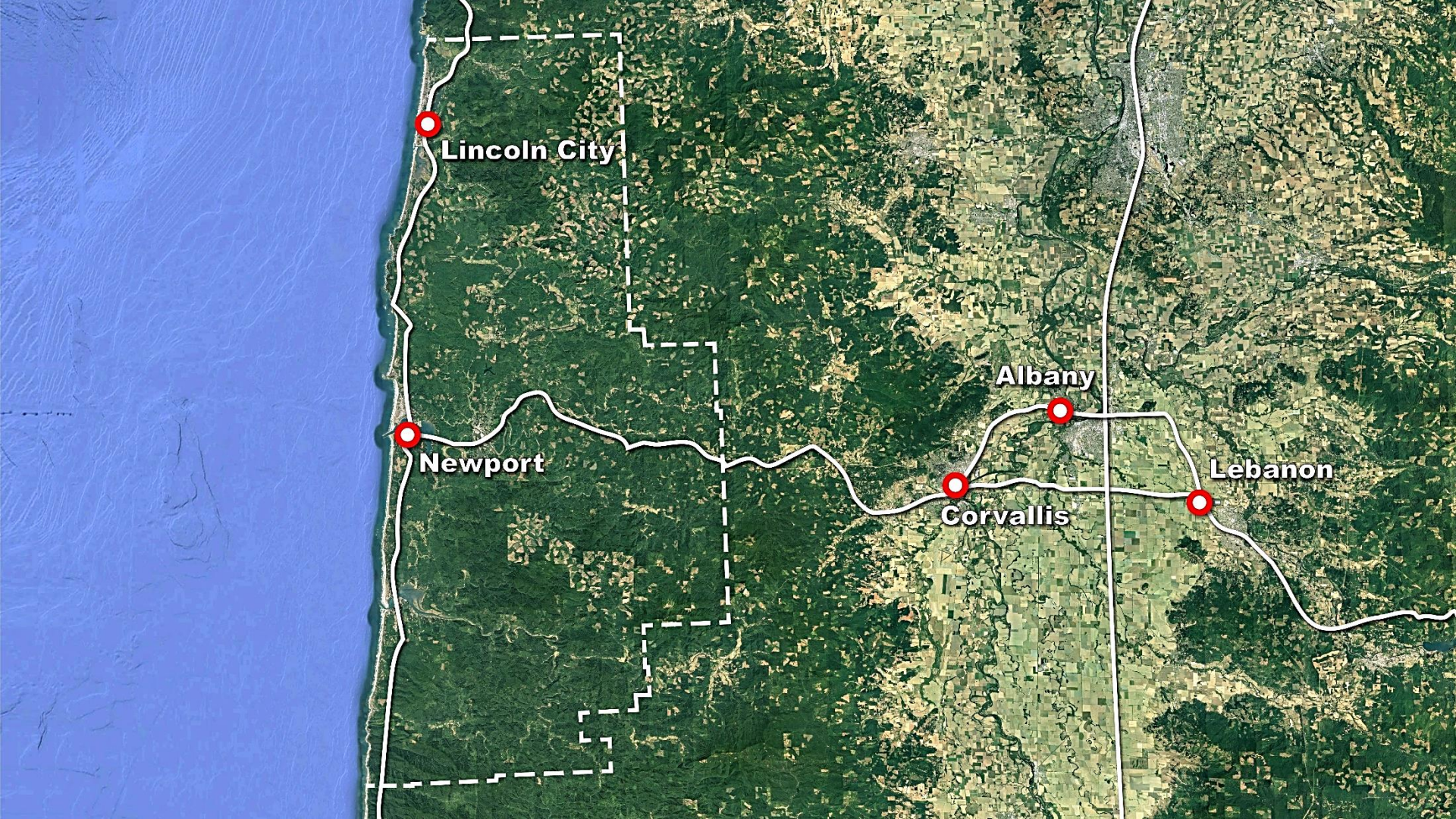

Lincoln City



Newport



Albany



Corvallis



Lebanon





Context: Lincoln County

- 38% of household have resident 65 years of age or over
- 18% have some form of disability
- 49% of households earn less than basic cost of living for state
- Health Professional Shortage Area
- Ranked 34th of 36 counties in 2018 health outcomes

Original Hospital

- Majority of construction from 1967
- Wood construction
- Many infrastructure issues
- Inefficient operations due to incremental expansion



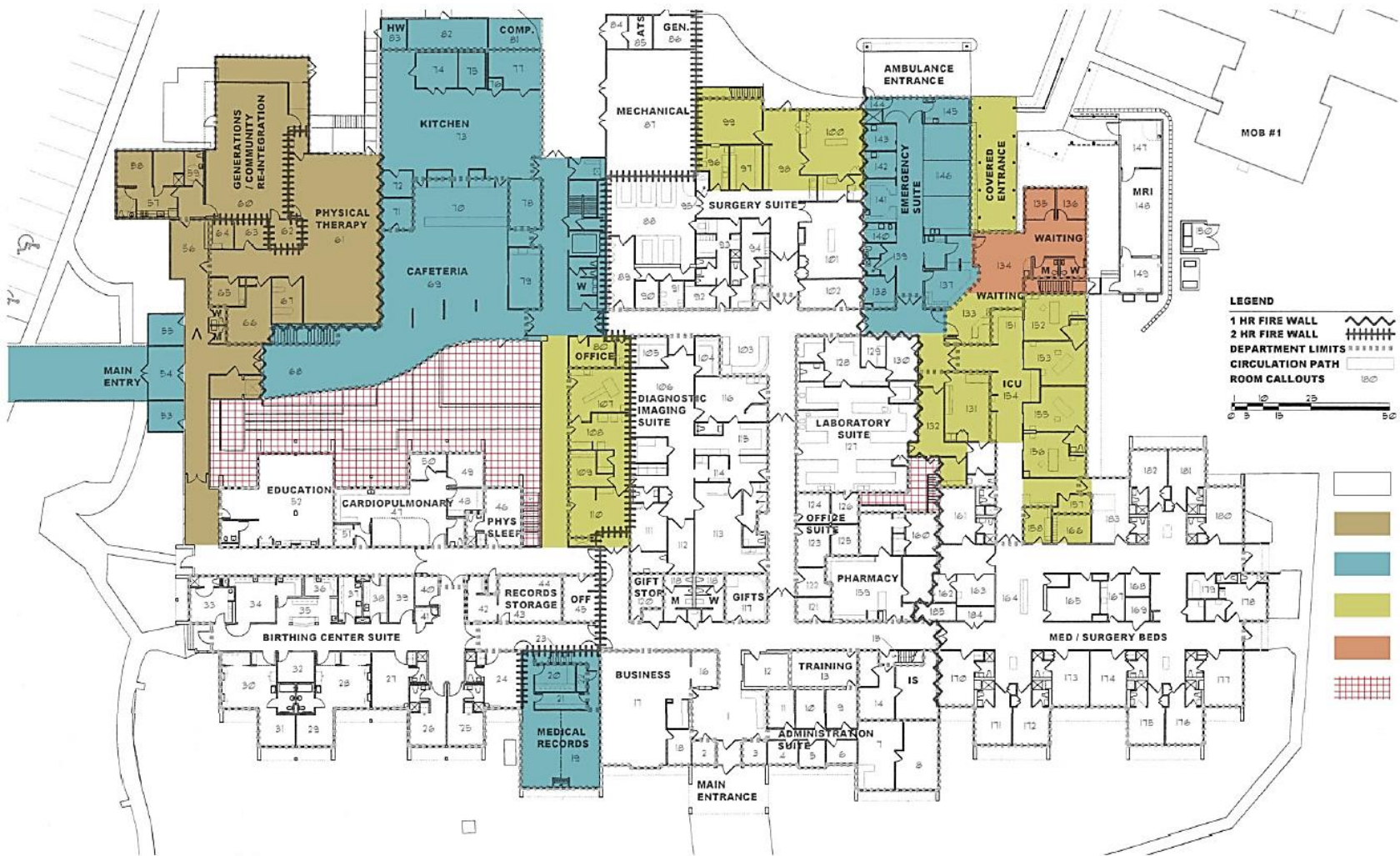

- 1967 (EKKT)
- 1975 (Arch. Unknown)
- 1980 (ZGF)
- 1990 (ZGF)
- 2001 (Architects Four)
- Courtyard



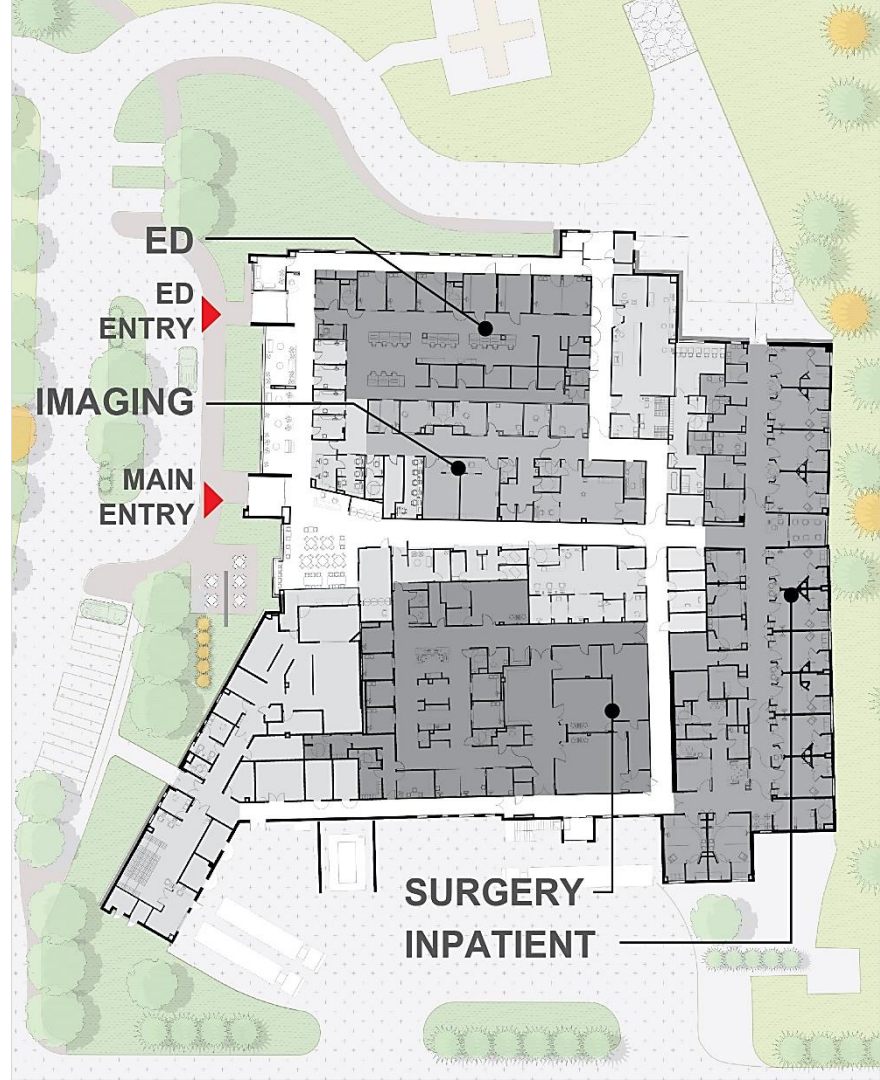

- Convenient location for lab draws, surgical consults, etc.
- Staff come to patients
- Adjacent to Main Entry



Outpatient Services

- ED surge accommodated by unusual flexibility between departments

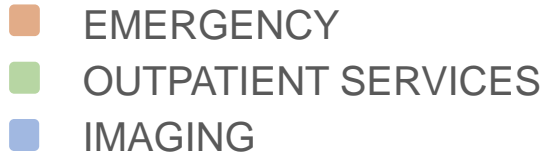

ED Flexibility

- ED surge accommodated by unusual flexibility between departments
- Outpatient Services rooms convert to ED treatment

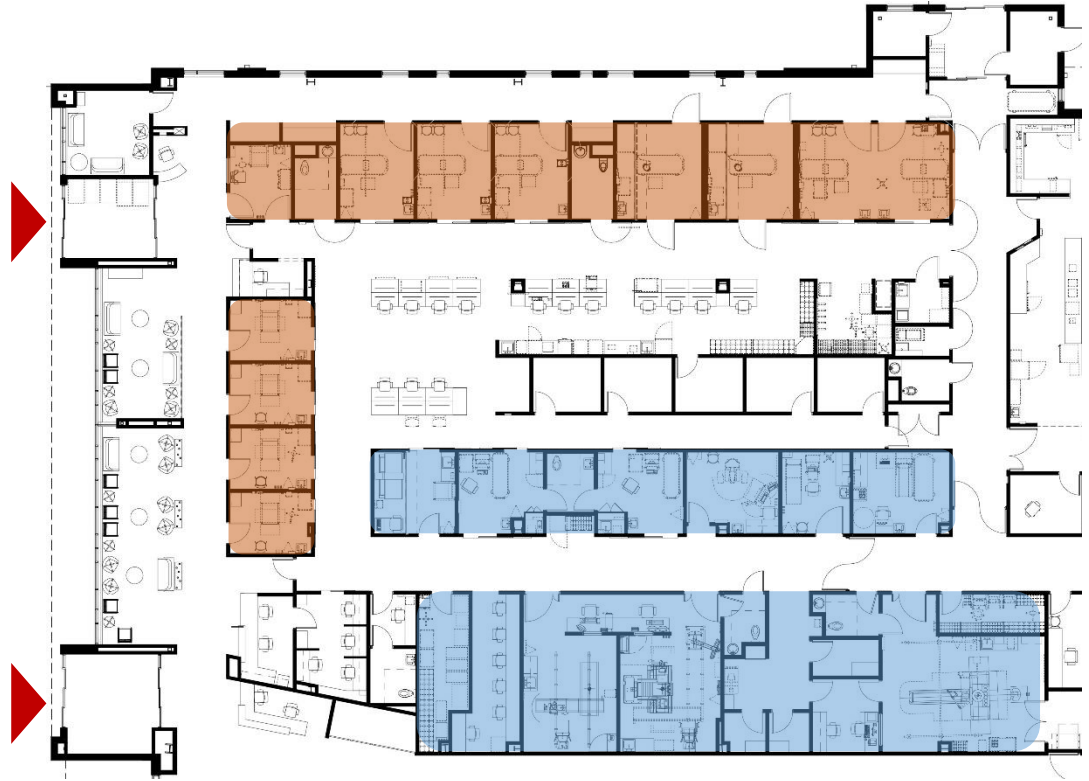
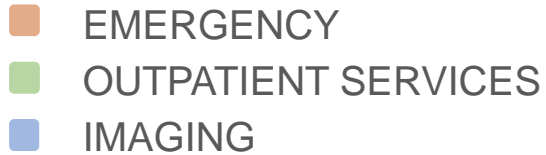

ED Flexibility

- ED surge accommodated by unusual flexibility between departments
- Ultrasound and DEXA convert in case of ED surge
- Creates on-stage / off-stage Emergency Department

- EMERGENCY
- OUTPATIENT SERVICES
- IMAGING



ED Flexibility

DAY – TYPICAL



EVENING – TYPICAL



ED SURGE



- Number of ED treatment spaces doubles from 7 to 14 – seamlessly

ED Flexibility

- Flex rooms serve Acute Care / CCU & Labor / Delivery (Post-partum)
- Immediate access from LDR to OR
- Inpatient staff monitor Observation Unit

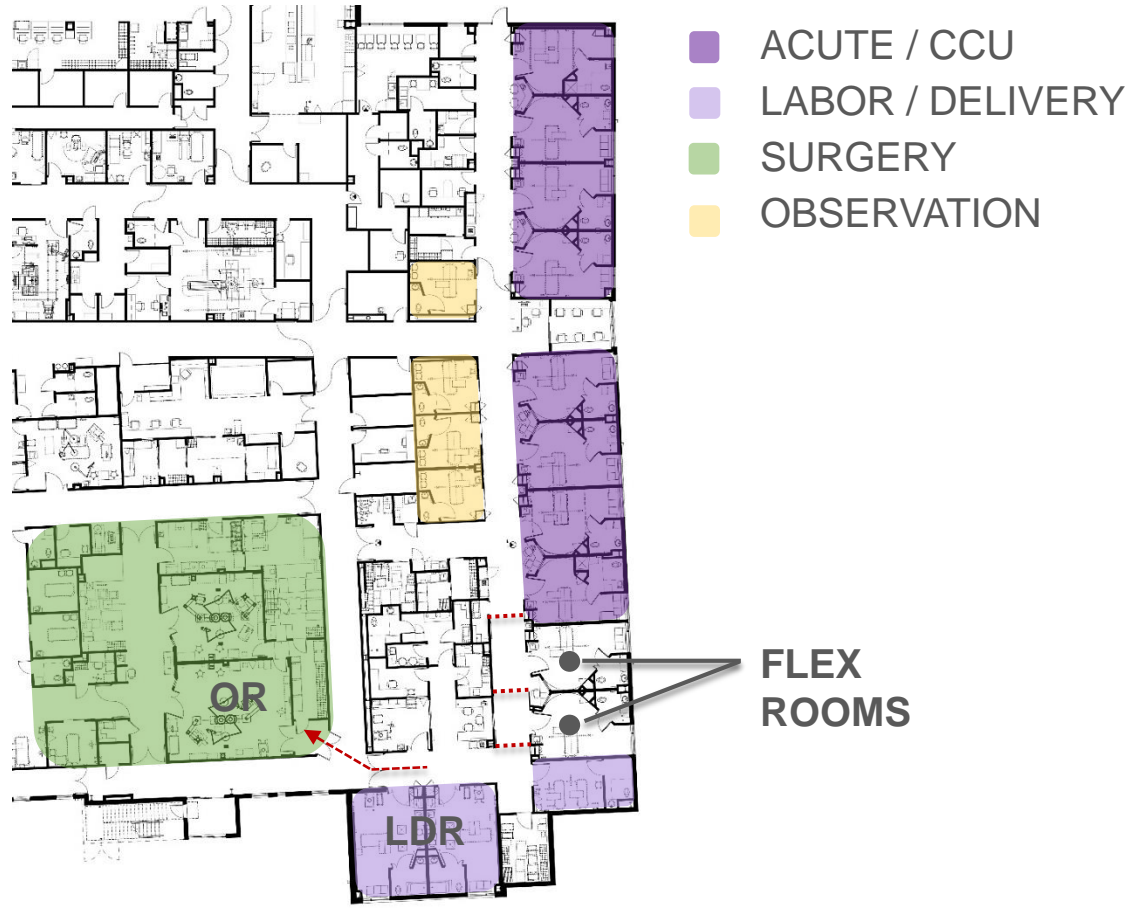

Inpatient Flexibility

- Gift shop is kiosk that expands into public space when open



Public Spaces

- Dining doubles as lobby seating
- Conference room acts as dining overflow



Public Spaces

- Potential growth departments (ED, Surgery, Inpatient) configured for future expansion

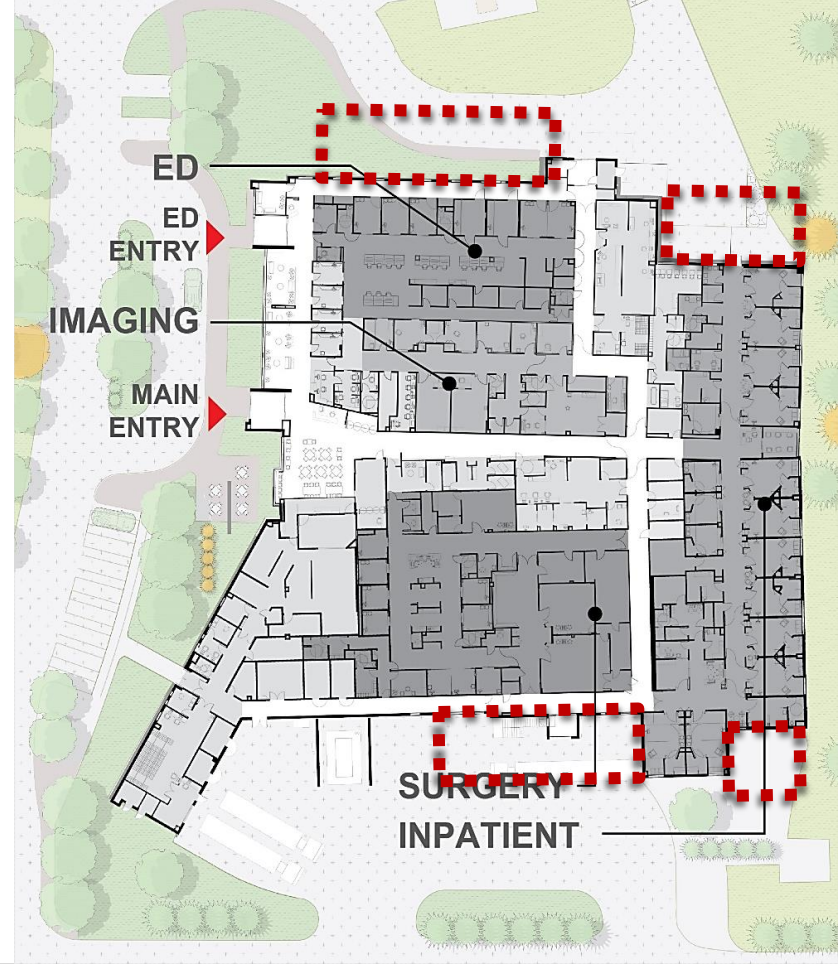

Future Growth



Results

- Flexible space for daily volume spikes, long-term service line shifts
- Cost-savings – \$1M in construction costs alone; additional equipment and operational savings



The American
Institute
of Architects

Academy of
Architecture for Health
an AIA Knowledge Community

Question Reminder

Submit your questions and comments
via the chat box.

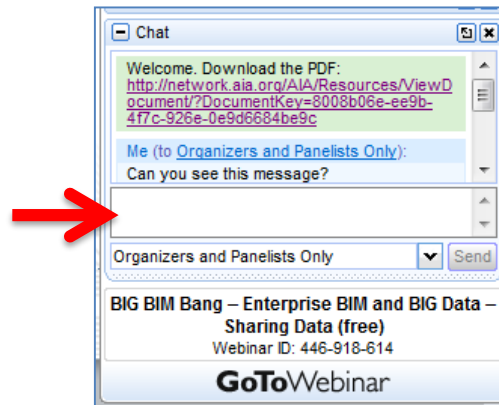

An aerial photograph of a rural farm scene. In the upper center, there is a cluster of farm buildings including several large white barns, a red barn, and several tall white and blue silos. A large, dark, circular pond is situated to the left of the main building complex. The foreground and middle ground are dominated by large, curved, and irregularly shaped fields of green crops, likely corn, which are separated by narrow dirt roads or paths. The overall lighting suggests a bright, sunny day, casting soft shadows across the landscape.

IMPLEMENTATION CHALLENGES & TOOLS

Challenges

- Code / Regulatory Issues

- EMERGENCY
- OUTPATIENT SERVICES
- IMAGING

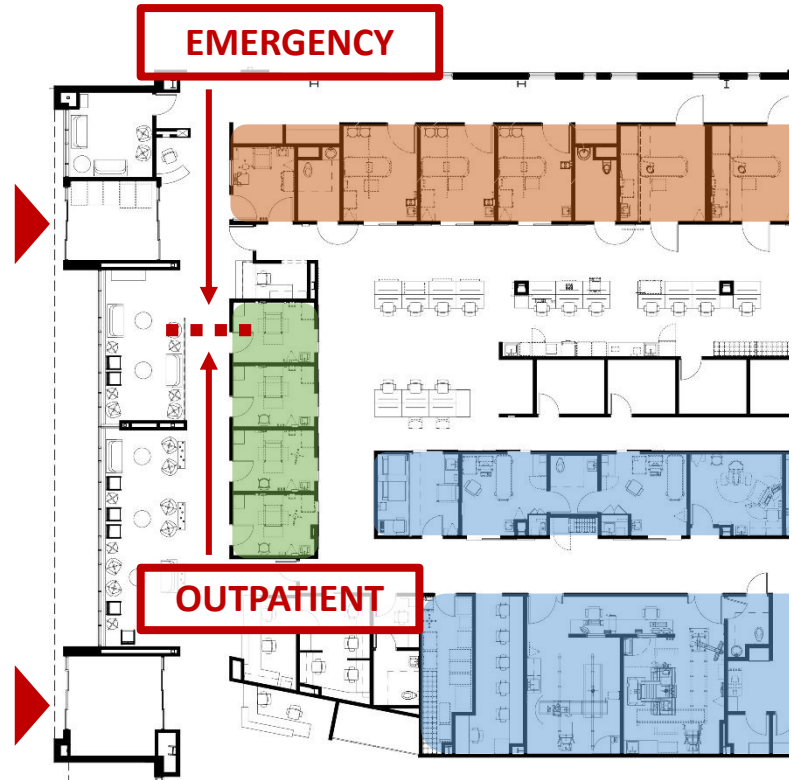

Challenges

- Patient Experience
 - Wayfinding
 - Access to natural light
 - Room designed for multiple acuity levels



Challenges

- Cultural Silos / Staff Buy-In
 - Role of leadership
 - Building staff support



Early Market

Mainstream Market

People who want newest ideals
and innovations

People who want complete
solutions and convenience

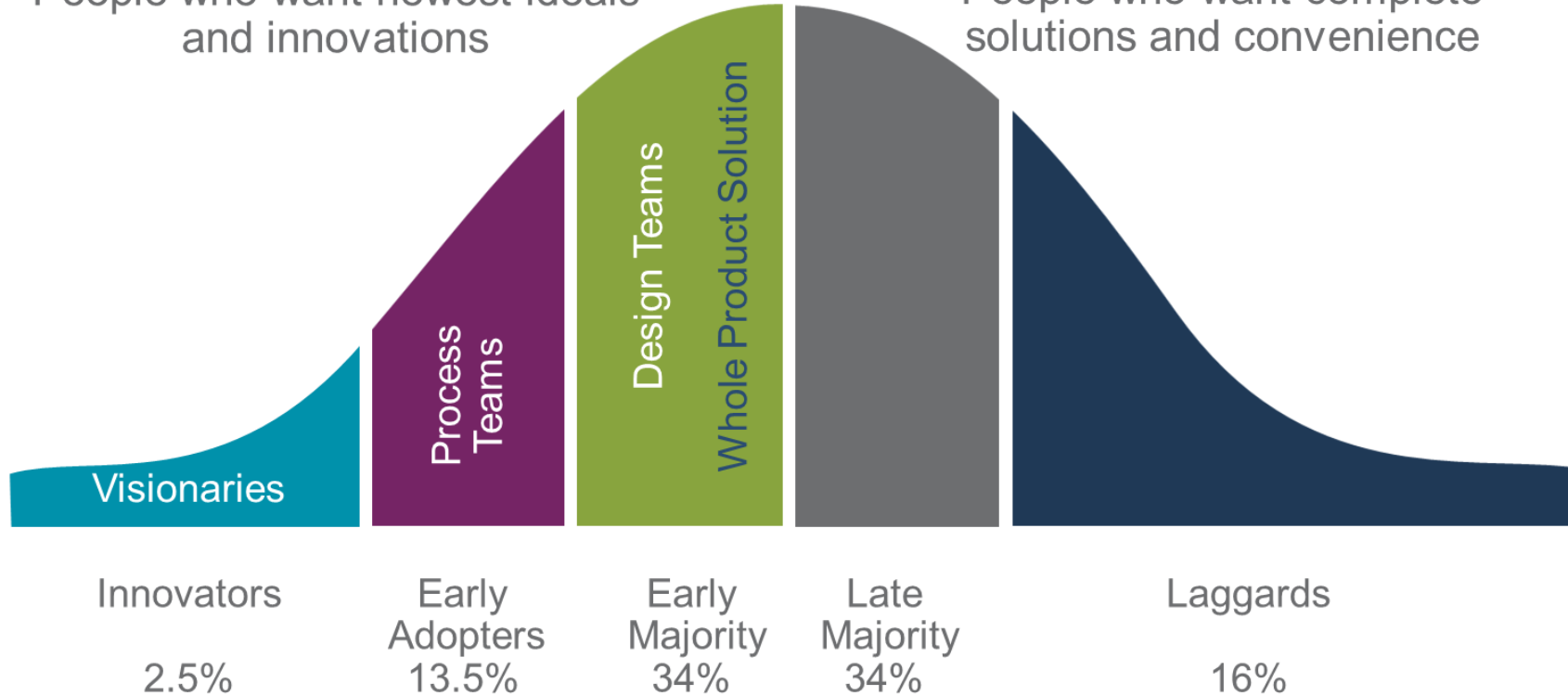

Process and Tools

It takes a village...

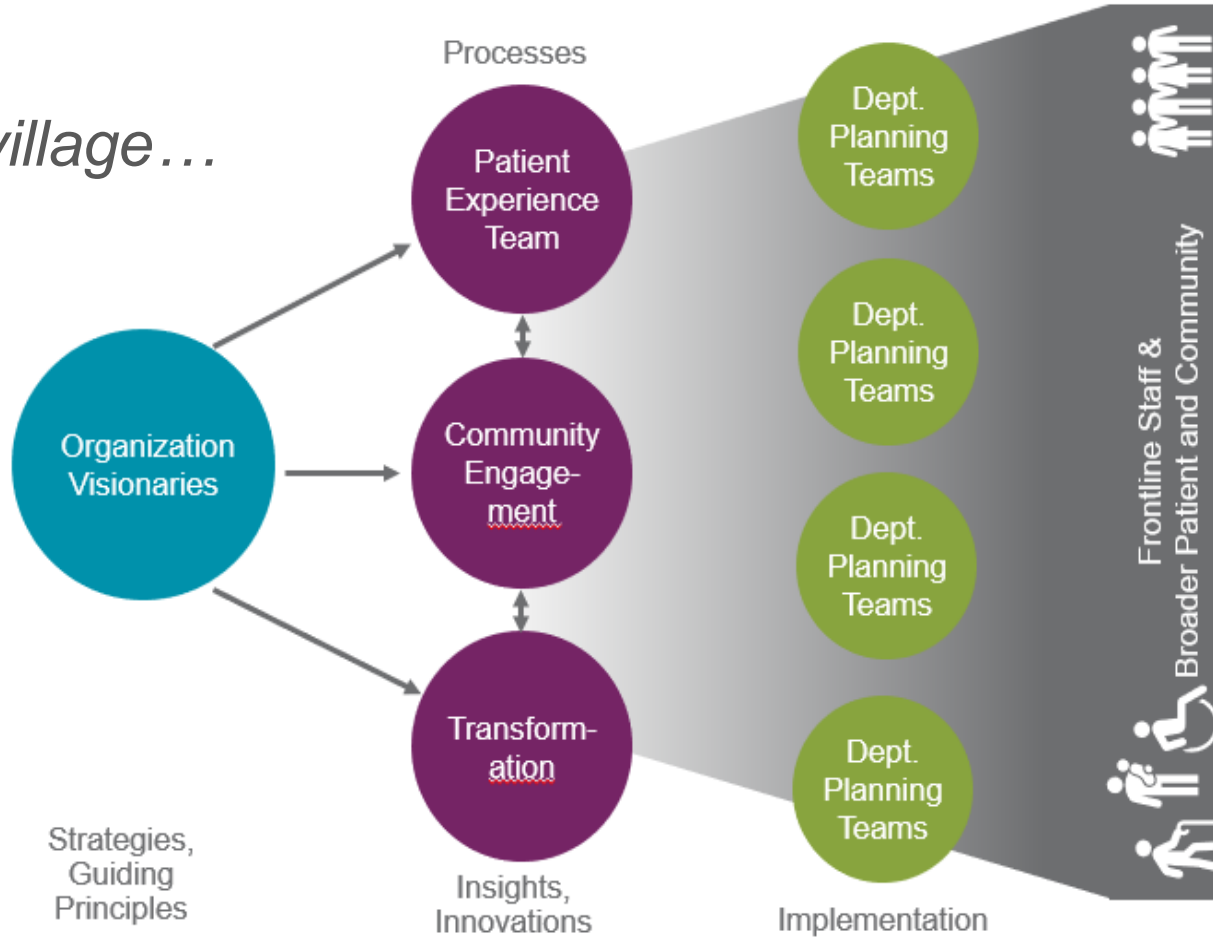

Process and Tools

GEMBA WALKS

Step 1: Engage

- Gain deep understanding of current conditions and challenges

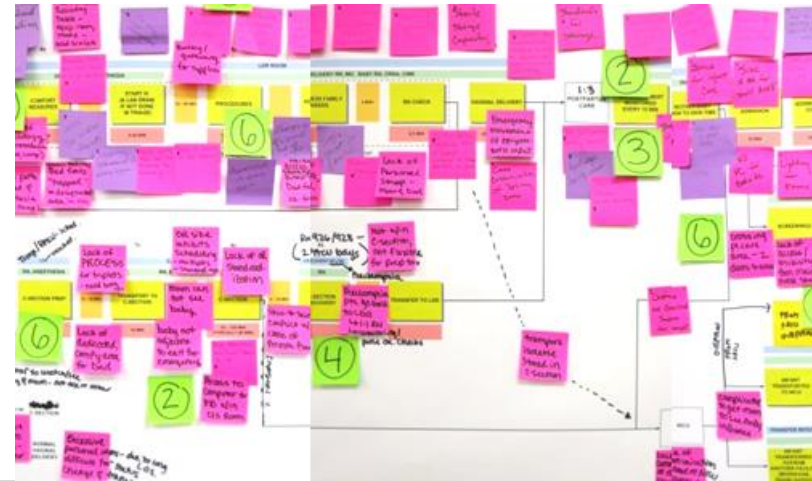

VALUE STREAM MAPS

Process and Tools

Process and Tools

- [illegible]

Step 3: Explore

- Brainstorm potential solutions
- Research innovative practices within and outside of industry



Step 4: Investigate the Details

- Mock up and refine potential solutions
- Identify process changes and staff training needed for successful implementation



Step 5: Apply and Test

- Pilot process improvements
- Evaluate and refine approaches

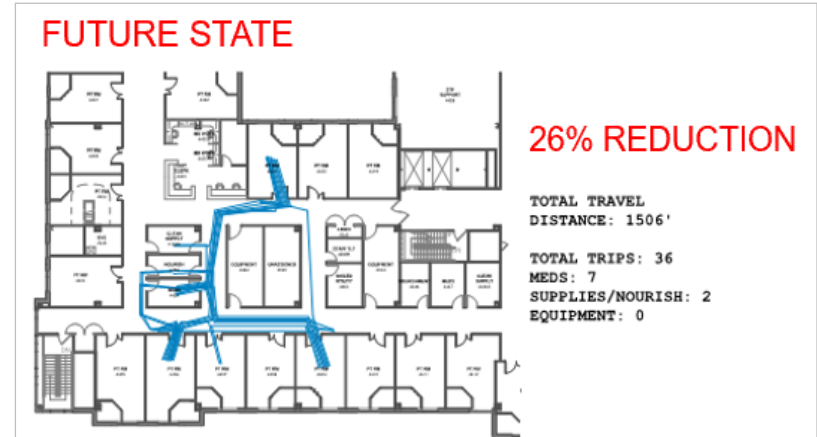
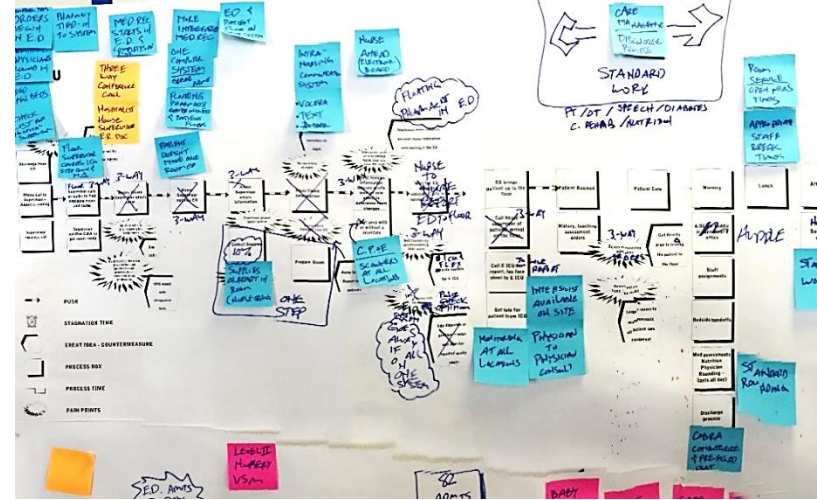

Post Occupancy Evaluation

Nurses' Average Frequency of Trips

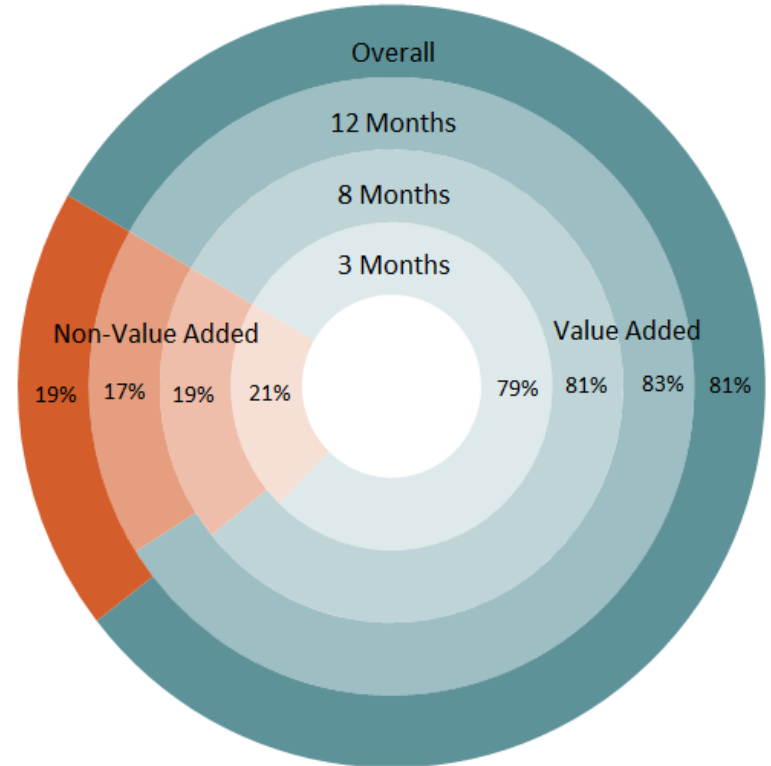
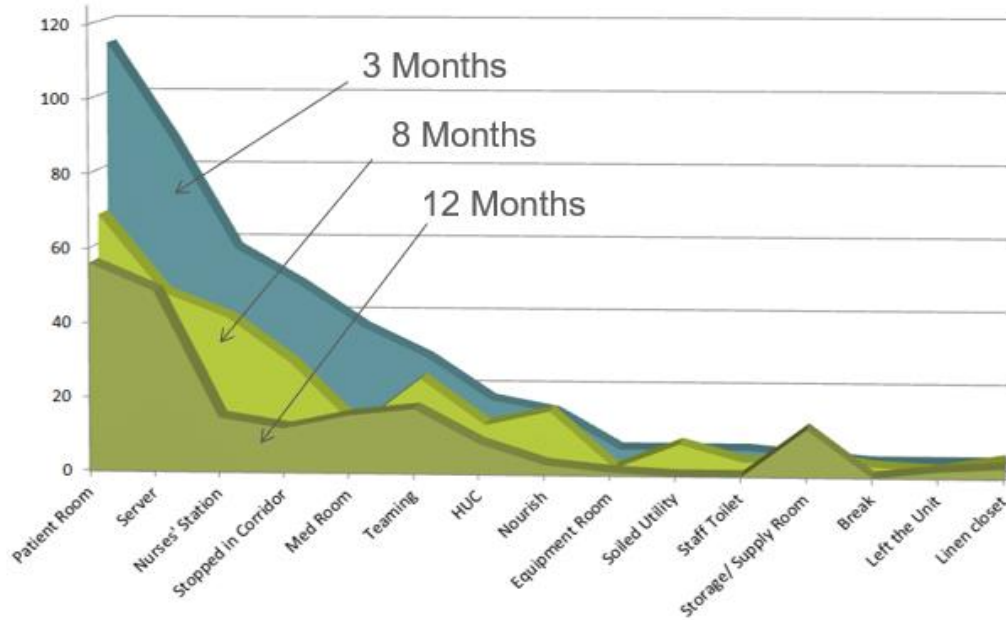

Process and Tools



Goal: Culture of Continuous Improvement





**The American
Institute
of Architects**

Academy of
Architecture for Health
an AIA Knowledge Community

Time for Questions and Comments





The American
Institute
of Architects

Academy of
Architecture for Health
an AIA Knowledge Community

CES Reminder

The URL to the webinar survey <https://www.research.net/r/AAH1910> will be emailed to the individual who registered your site.

The survey closes **15 November 2019** at 12:30am ET.

For questions, please email knowledgecommunities@aia.org



The American
Institute
of Architects

Academy of
Architecture for Health
an **AIA** Knowledge Community

Join the Academy of Architecture for Health

www.aia.org/aah

AIA KnowledgeNet

[AAH Home](#) • [Discussion](#) • [Library](#) • [Blogs](#) • [Events](#) • [Directory](#) • [Participate](#) • [Communities](#) •



Academy of Architecture for Health

an **AIA** Knowledge Community

[AAH Board/Committees](#) | [Components](#) | [Webinar Resources & Archives](#) | [Healthcare Design Awards](#) | [Pillars of Health Care Architecture](#) | [Member List](#) [Twitter](#) [LinkedIn](#)

[Edit Carousel](#)



**INTERNATIONAL SUMMIT & EXHIBITION ON
HEALTH FACILITY PLANNING, DESIGN & CONSTRUCTION**

MARCH 17-20, 2019 | PHOENIX, AZ

Join this knowledge community >

About the Academy

Announcements [Add](#)

U40 List: Healthcare Design's Best Under 40 [✓](#) [B](#)

The U40 List is nomination oriented recognition to celebrate individuals making a significant contribution to the advancement of health facilities design. Each year up to two individuals will be selected to have their names added to the distinguished U40 List. The individuals will receive a travel stipend to attend the Summer Conference.



**The American
Institute
of Architects**

Academy of
Architecture for Health
an AIA Knowledge Community

Upcoming Webinars

| Date | Series | Topic |
|----------|-------------------|---|
| 12.10.19 | Master's Studio | End-of-Life Care Environments |
| 02.11.20 | Beyond the Basics | The “Not-So-Connected” Building |
| 03.10.20 | HC-101 | Exam, Procedure, and Operating Rooms: Planning advice based on the FGI Guidelines |

Dates & topics are subject to change