



JUSTICE IN DESIGN



NADAAA



OUR MISSION + BELIEFS

At Van Alen Institute, we believe design can transform cities, landscapes, and regions to improve people's lives.

We collaborate with communities, scholars, policymakers, and professionals on local and global initiatives that rigorously investigate the most pressing social, cultural, and ecological challenges of tomorrow.

Building on more than a century of experience, we develop cross-disciplinary research, provocative public programs, and inventive design competitions.



OUR MISSION + BELIEFS

We believe that all aspects of our lives are shaped by our environments. Our work is inspired by two fundamental questions:

- How do cities impact our minds and bodies?
- And in turn, how do we impact the environment?

We want to learn more about these complex relationships through the lens of design.



JUSTICE IN DESIGN TEAM

DAN GALLAGHER, AIA, NADAAA

NADER TEHRANI, NADAAA; DEAN, IRWIN S. CHANIN SCHOOL OF ARCHITECTURE AT THE COOPER UNION

SUSAN GOTTESFELD, OSBORNE ASSOCIATION

KAREN KUBEY, URBANIST

SUSAN OPOTOW, JOHN JAY COLLEGE OF CRIMINAL JUSTICE AND THE GRADUATE CENTER OF CUNY

JAYNE MOONEY, JOHN JAY COLLEGE OF CRIMINAL JUSTICE AND THE GRADUATE CENTER OF CUNY

**VAN
ALAN**

INSTITUTE

**The Independant
Commission for
New York City
Criminal Justice and
Incarceration Reform**

What role do architects and designers play in the change making process?



JUSTICE HUBS

Justice Hubs are a new model for detention in New York City. Located in each of the boroughs near existing courts and municipal buildings, these new facilities offer an innovative opportunity for a justice system that is fair and responsive to different communities throughout New York City. Rikers Island is an isolated, violence-plagued, fiscal drain on the city. The Hubs' locations and state-of-the-art design offers:

1. Reduced time and resources needed for individuals to move to and from courts.
2. Modern facilities that are safe on the inside and reflect the look and feel of the neighborhood on the outside.
3. Increased accountability and community connection.
4. Improved court efficiency that eases strain on inmates and staff.
5. More effective and efficient programming and services that address mental health and criminal justice issues that ultimately lower the jail population.
6. The creation of a civic resource, integrated into the neighborhood providing communities with much needed services and facilities.

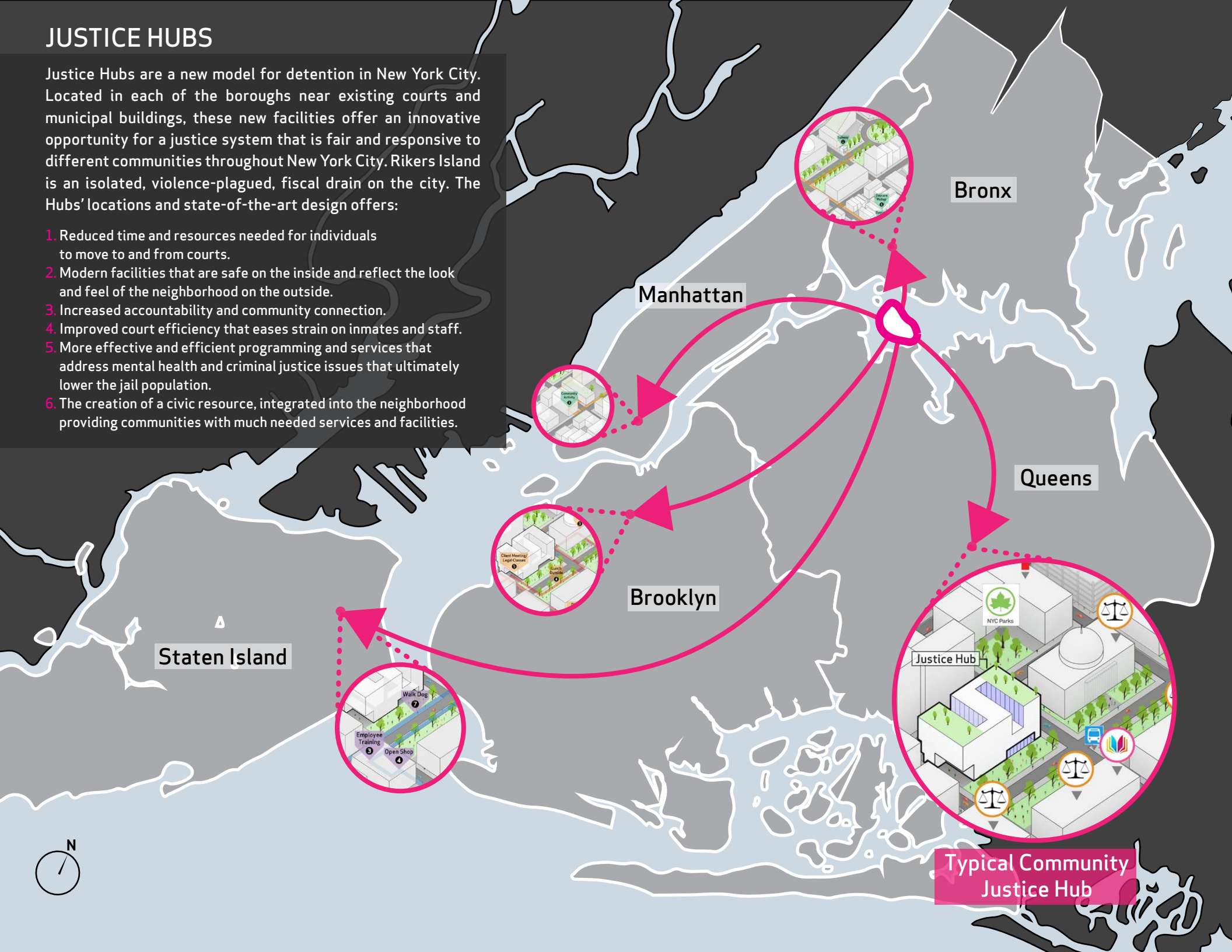

DESIGN PRINCIPLES AND OPPORTUNITIES
INTERIOR SPACES

MULTISTORY PODULAR LAYOUT WITH OUTDOOR SPACE

Direct Supervision
Day Room
Local Group Room
Adjacent Program Office
Video Connectivity Space
Dayroom With View
Program Area
Daylight & Air

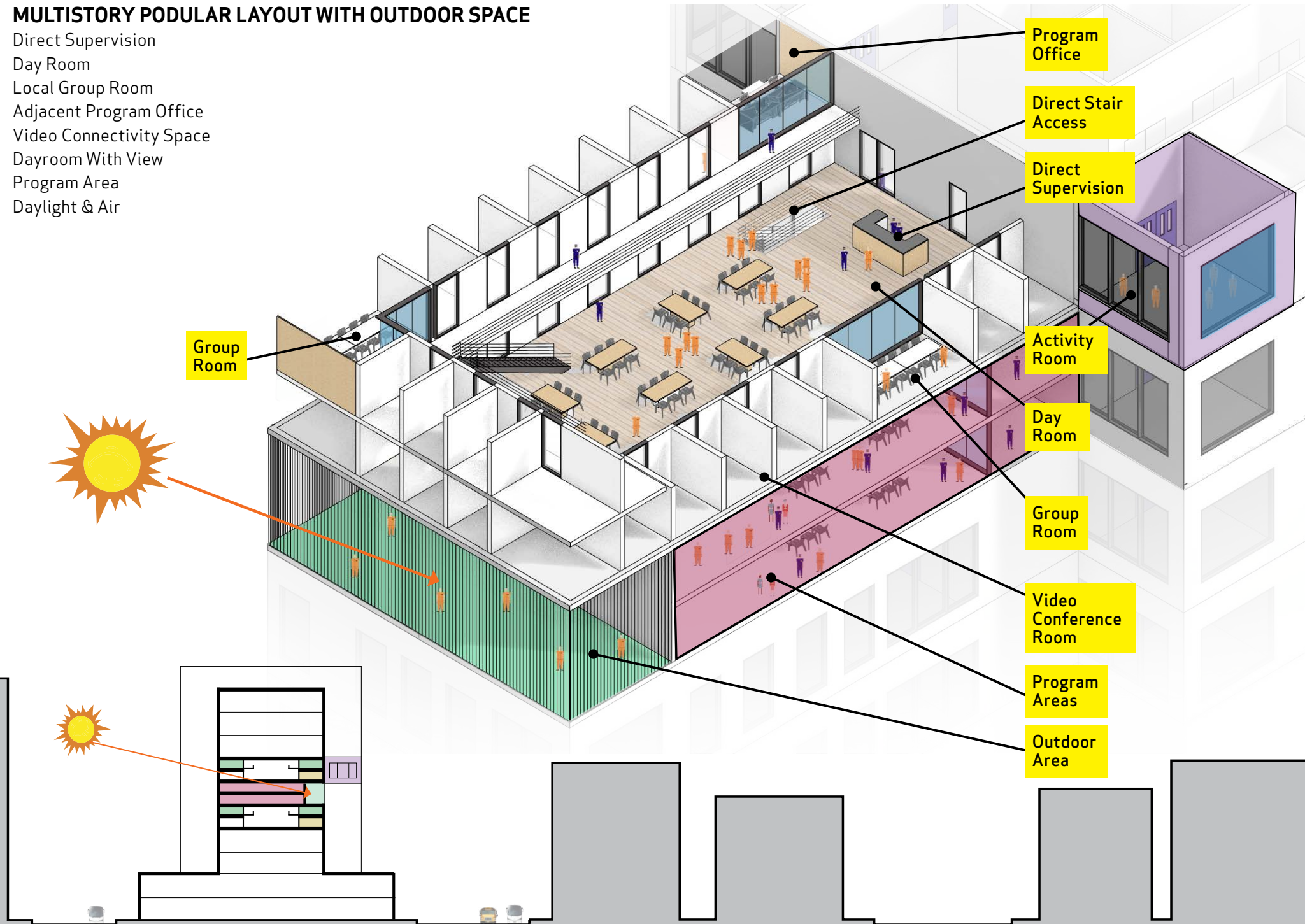

OFFICER & ACTIVITY BREAK SPACES WITH OUTDOOR SPACE

Material & Finish Varieties

Furniture Variety

Conference Room

Daylight & Air

Outdoor Space

Views

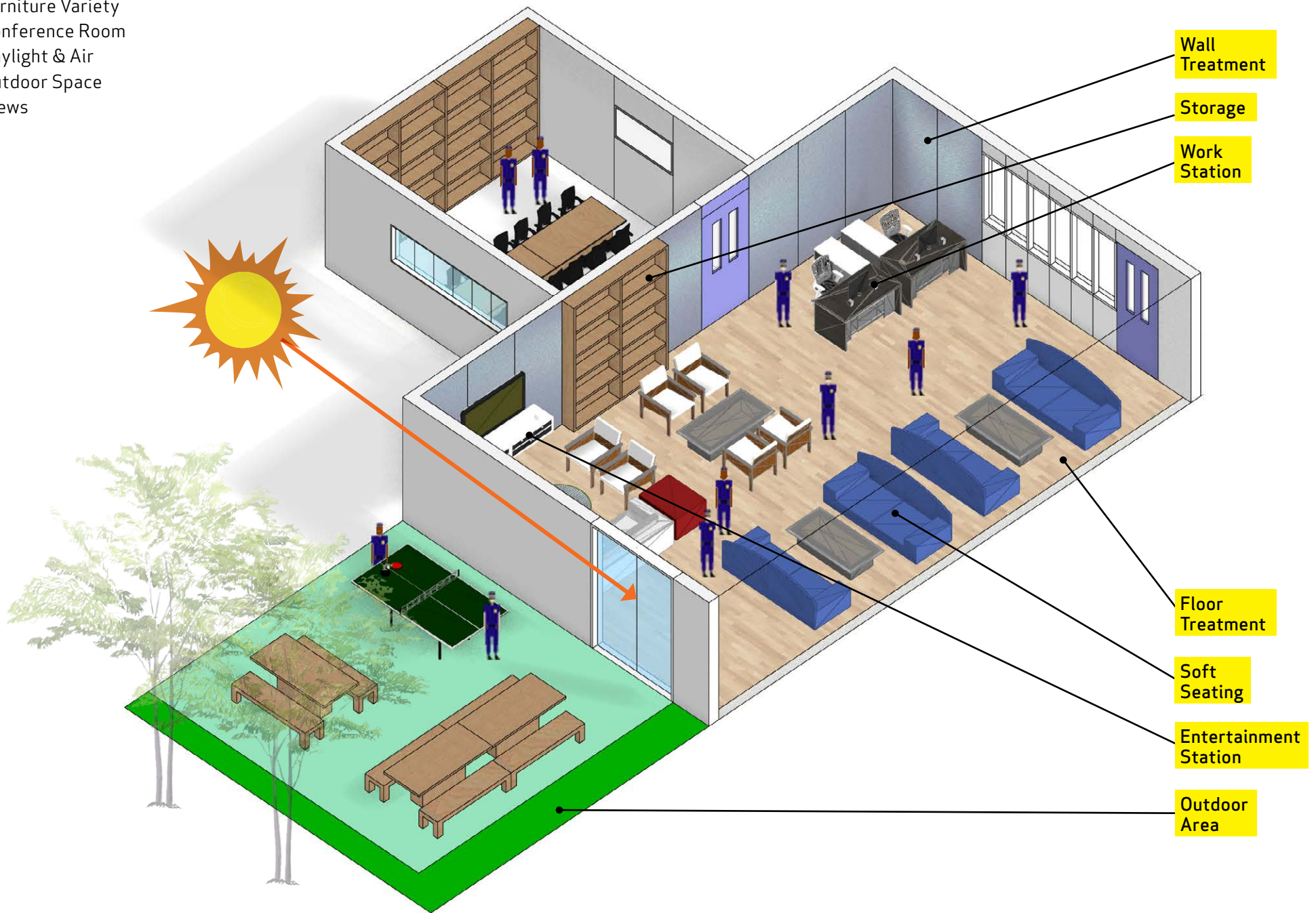

VISITOR EXPERIENCE

Material & Finish Varieties
Comfortable Space
Children's Area
Daylight & Air
Outdoor Area
Views

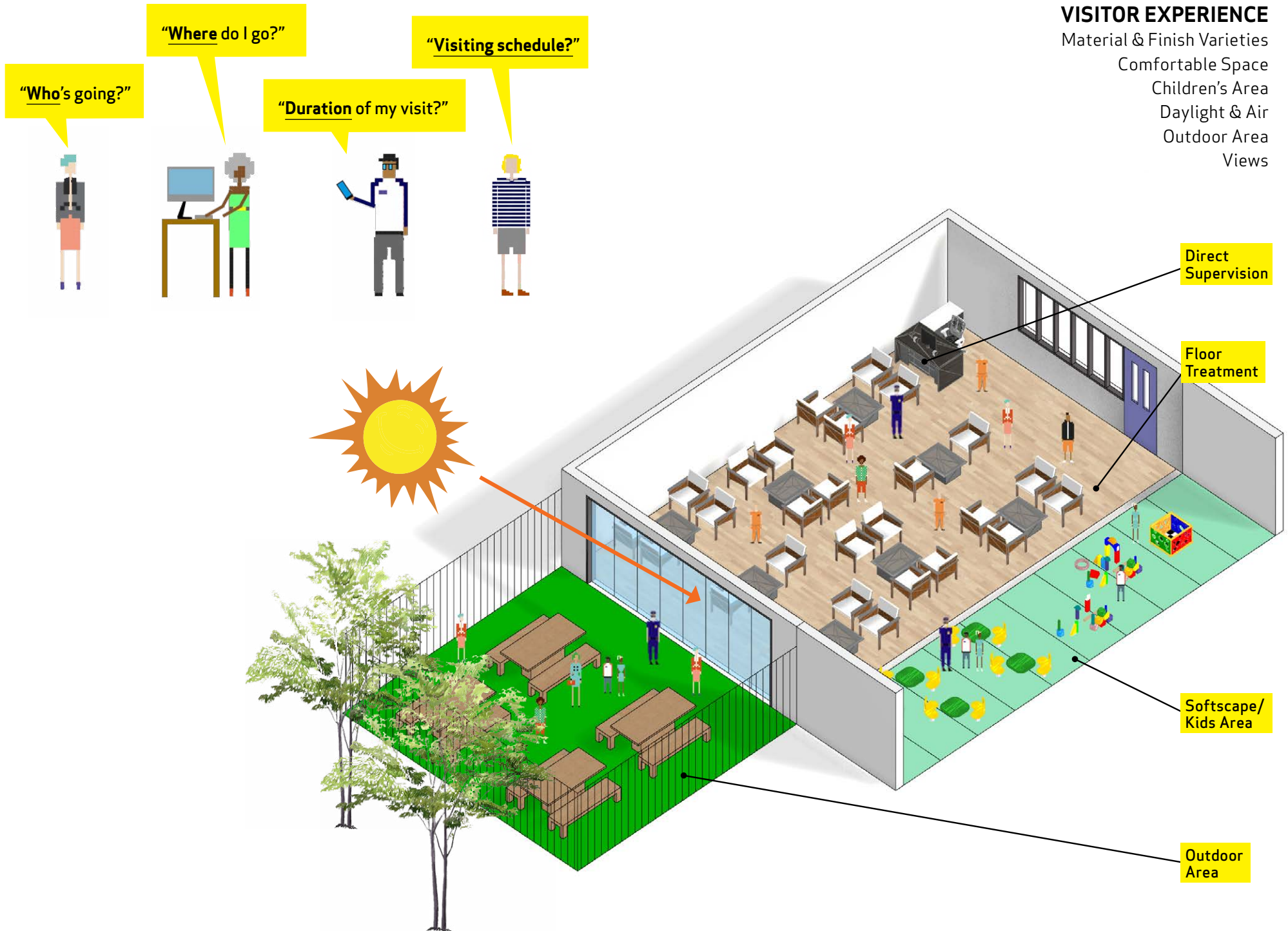

CITY PEOPLE / DIVERSE NARRATIVES

Communities are defined by a diversity of people utilizing an array of places and programs in the City. The location, programming and services provided at a Justice Hub will benefit detainees, their families, jail staff and the broader community.

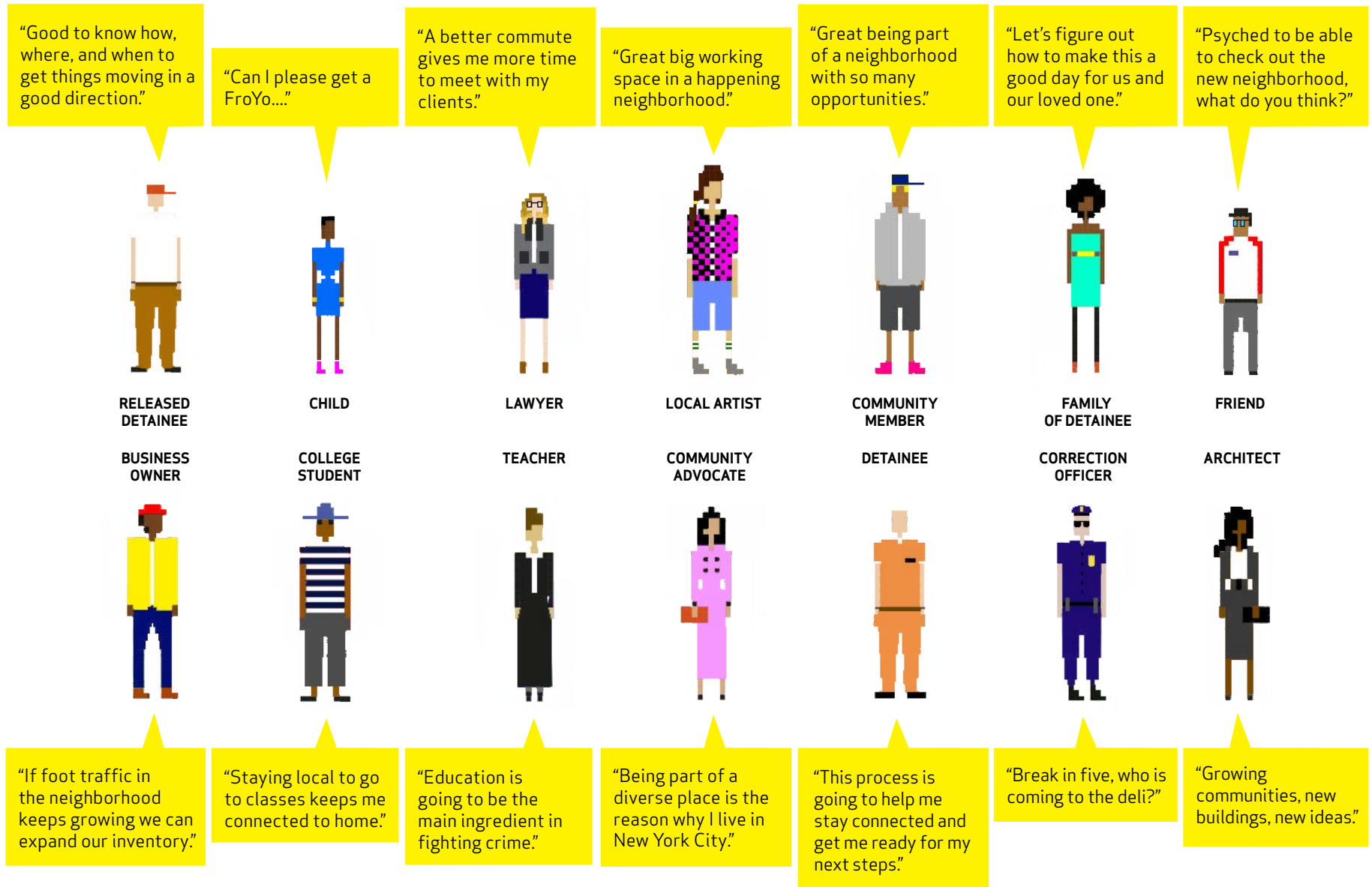

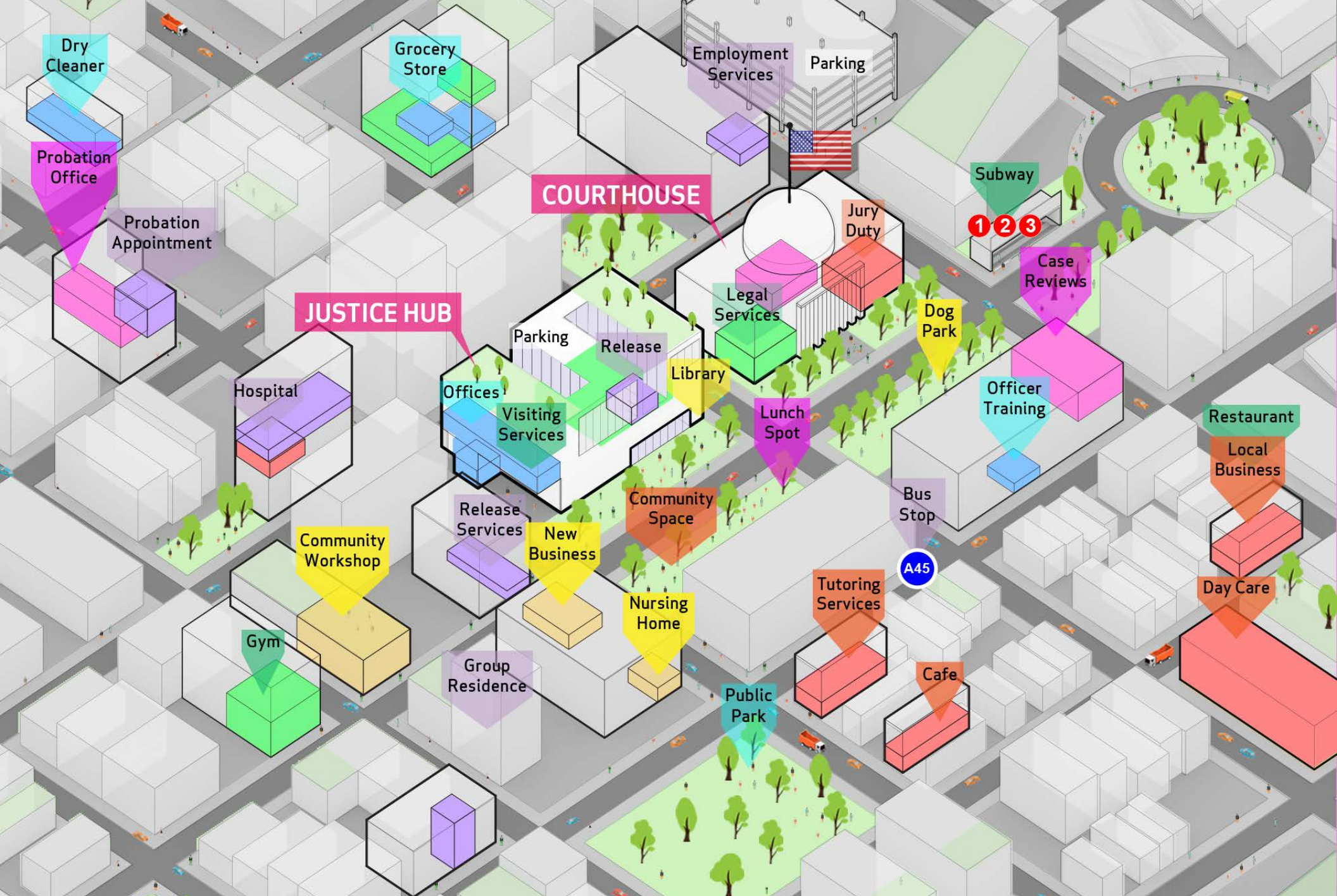

The Justice Hub offers a diversity of opportunities in the neighborhood and fosters healthy experiences. Its presence in the community enables a higher standard of local accountability for the criminal justice system. It not only supports a more just and efficient judicial process, but cultivates positive civic identity and understanding.

CITY LIVING: A DAY IN THE LIFE

DETAINEE

"This process is going to help me stay connected and get me ready for my next steps."



A **Justice Hub** benefits the detainee by providing a faster judicial process, better access to health services and programming, more frequent access to family visits and legal support, and more calming living spaces.

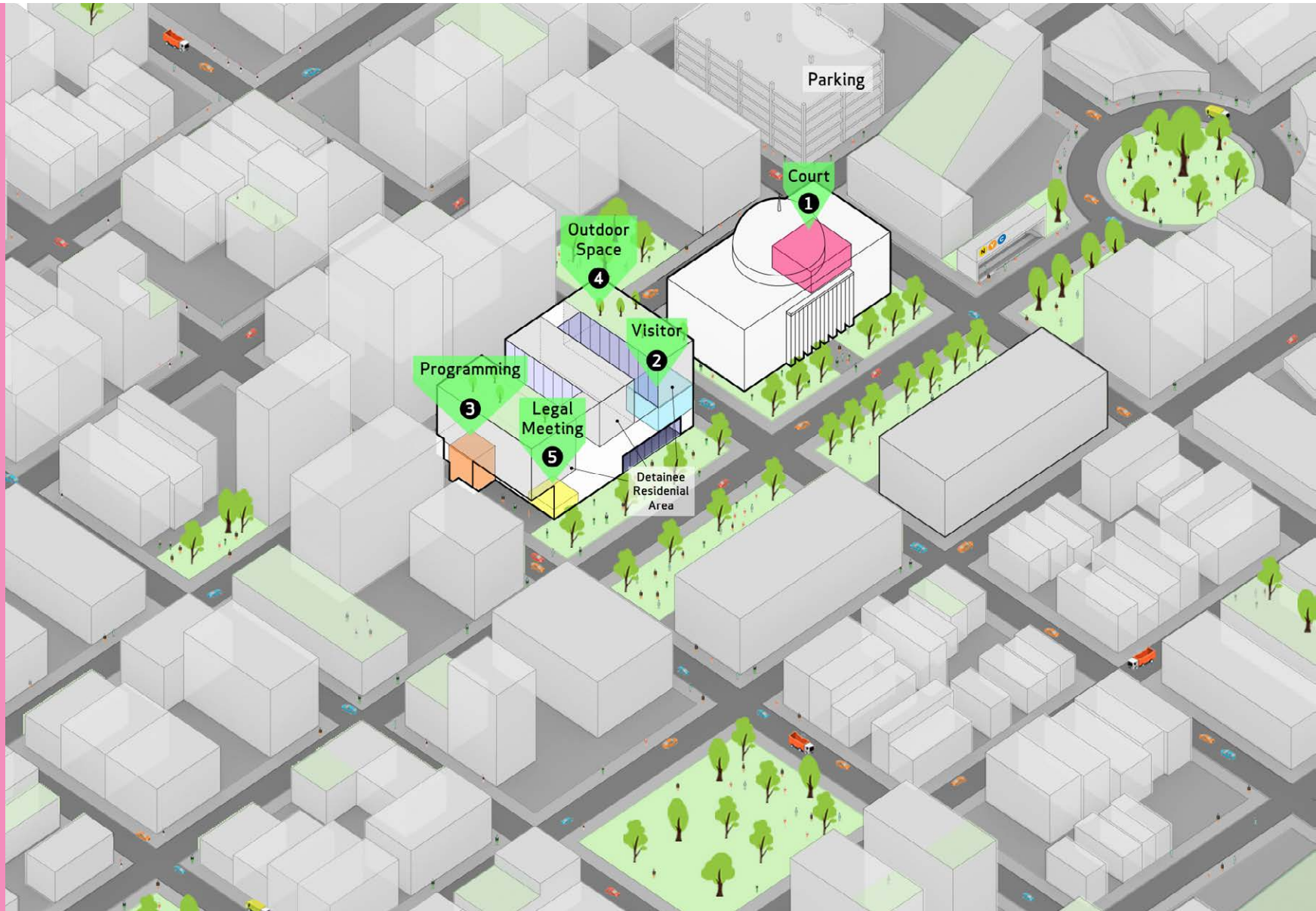

CITY LIVING: A DAY IN THE LIFE

COMMUNITY MEMBER

"Great being part of a neighborhood with so many opportunities"



A **Justice Hub** benefits community members by offering new programming spaces and public services.



CITY LIVING: A DAY IN THE LIFE

CORRECTION OFFICER

"Break in five, who is coming to the deli and eating outside?"

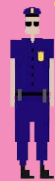

A **Justice Hub** is more accessible to officers, providing dedicated parking, safer work spaces, and access to local amenities.

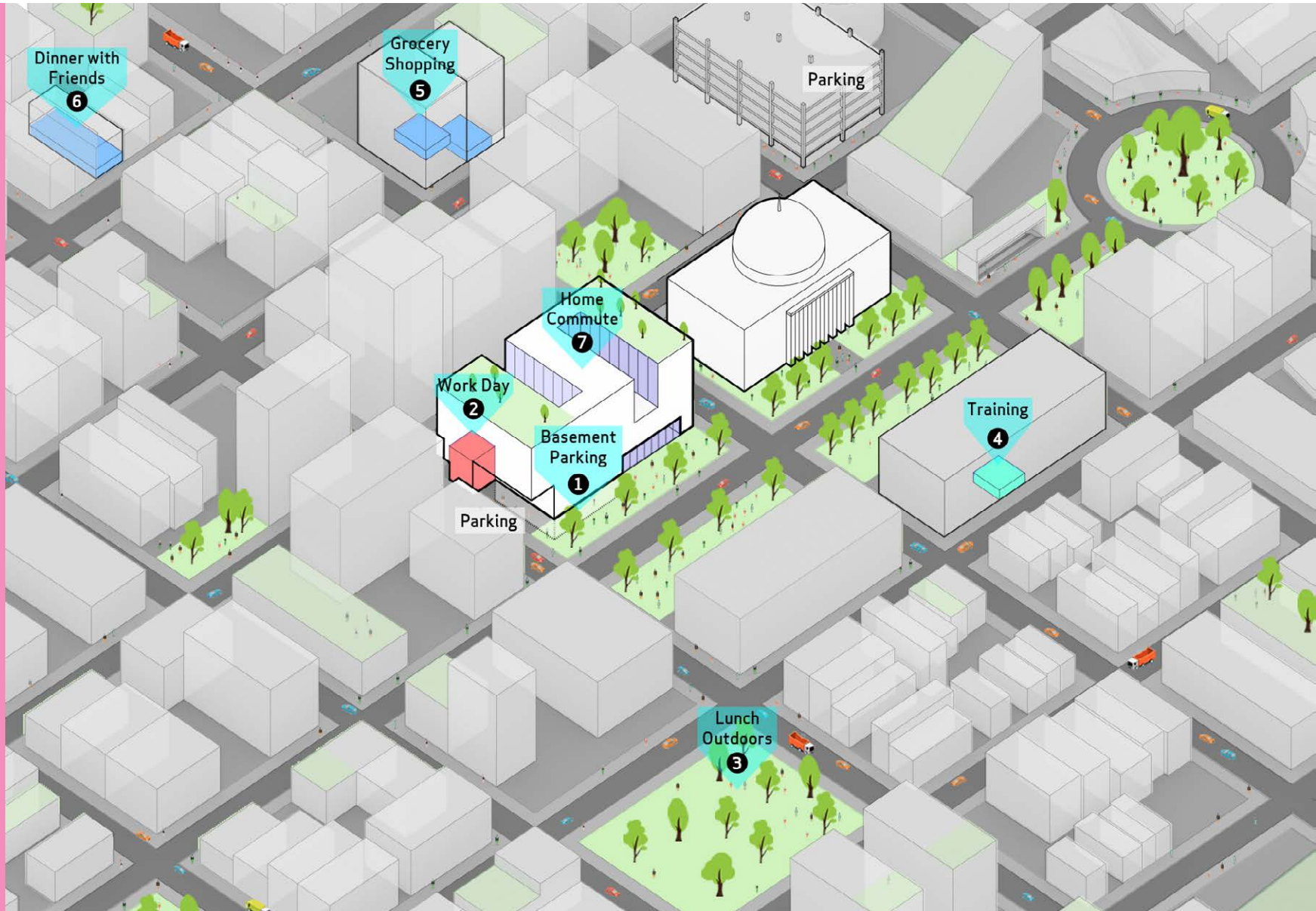

CITY LIVING: A DAY IN THE LIFE

BUSINESS OWNER

"If foot traffic in the neighborhood keeps growing we can expand our inventory"



A **Justice Hub** makes all public infrastructure an integrated part of the community, catalyzing more economic opportunity through the jobs it creates and the new public space it offers. Thereby becoming a benefit to local community members and business owners.

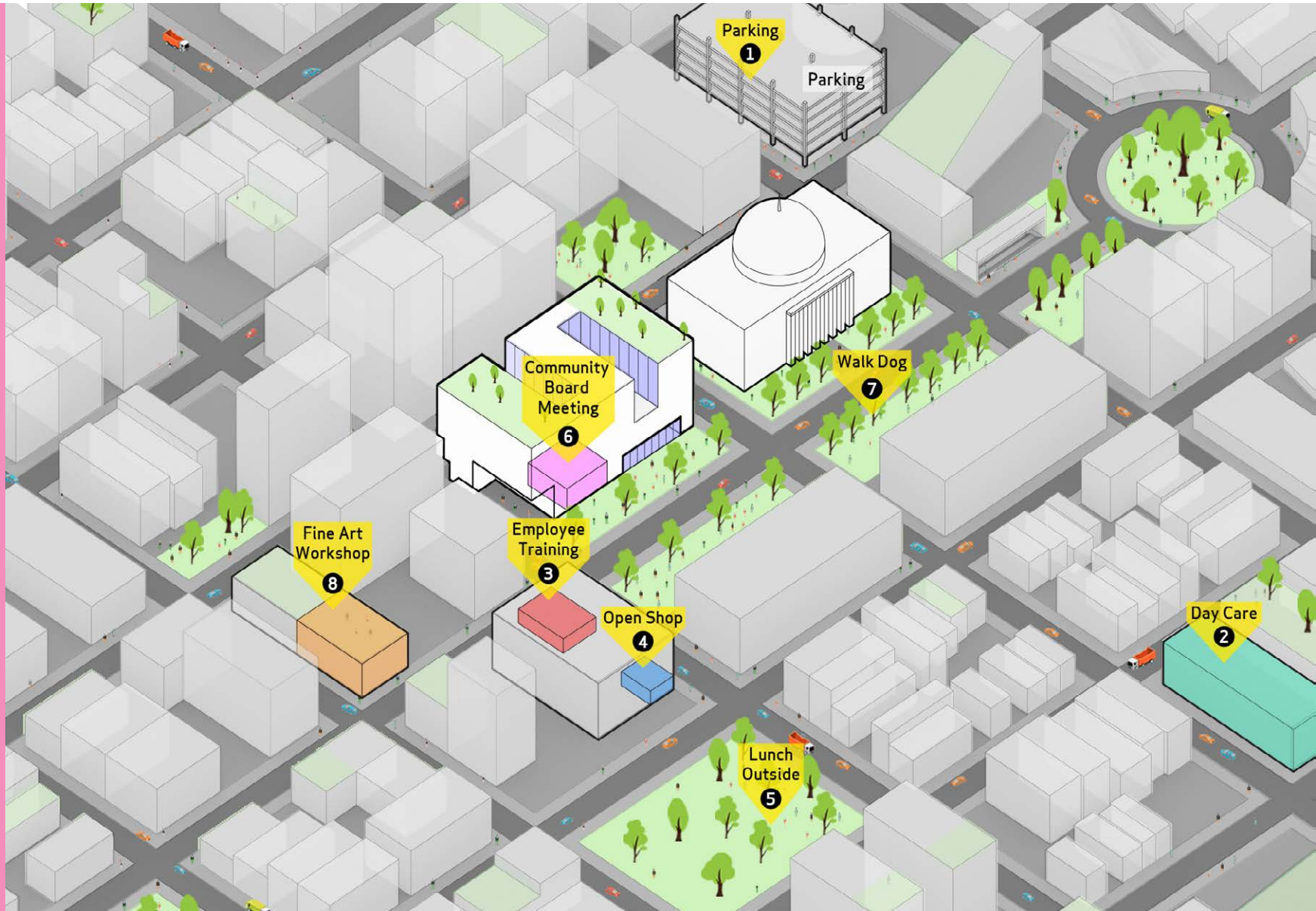

CITY LIVING: A DAY IN THE LIFE

FAMILY OF DETAINEE

"Let's figure out how to make this a good day for us and our loved one."



A **Justice Hub** enables family members of detainees and inmates the opportunity to see loved ones without traveling long distances, and creates a safe and friendly environment for visitation.



CITY LIVING: A DAY IN THE LIFE

RELEASED DETAINEE

"Good to know the how, where, and when to get things moving in a good direction."



A **Justice Hub** benefits a released detainee by offering a supportive community and network of services for rehabilitation.

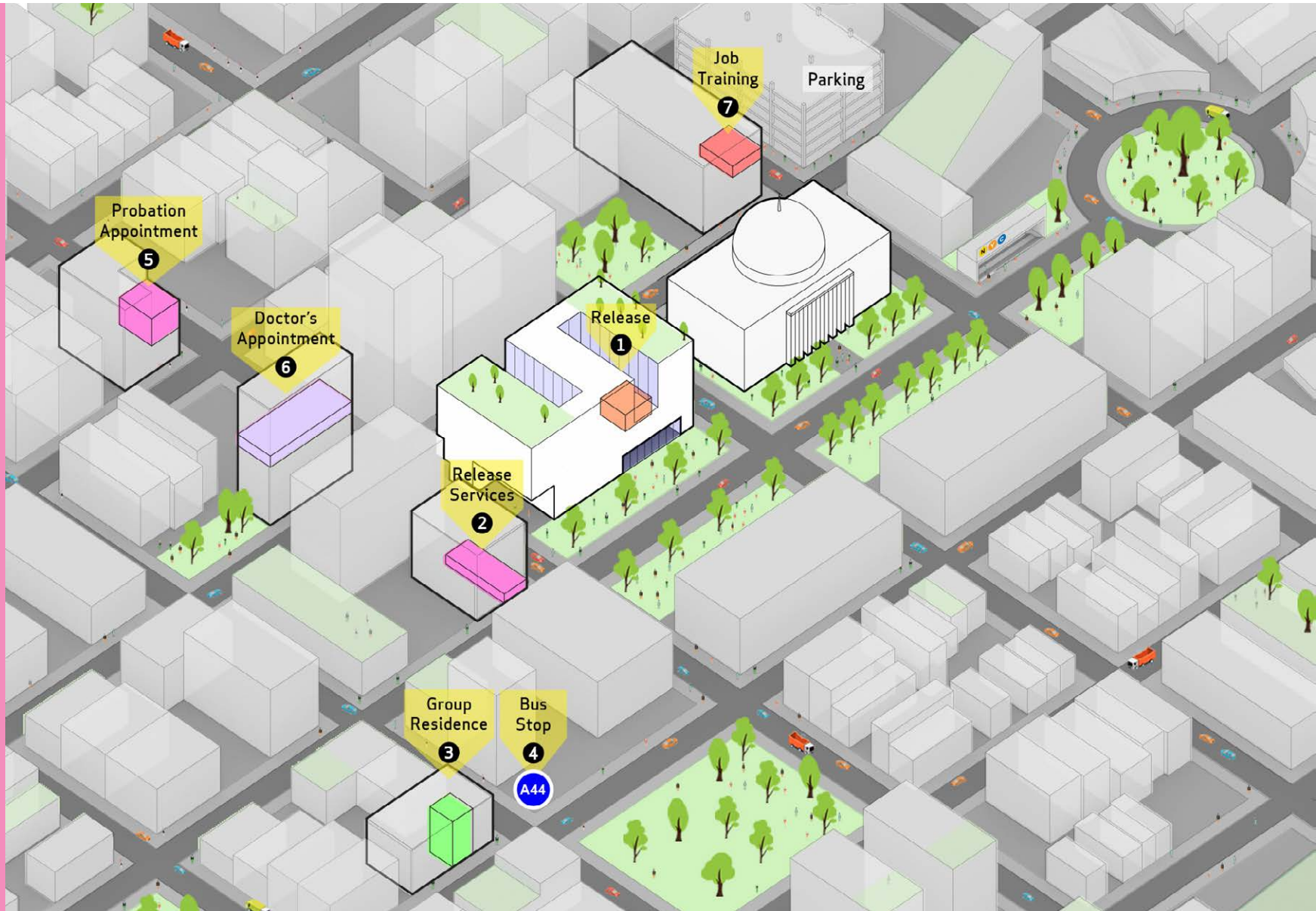

CITY LIVING: A DAY IN THE LIFE

LAWYER

"A better commute gives me so much more time to help my clients."



A **Justice Hub** benefits legal professionals by affording more direct and productive access to clients, courts, programs, and activities.

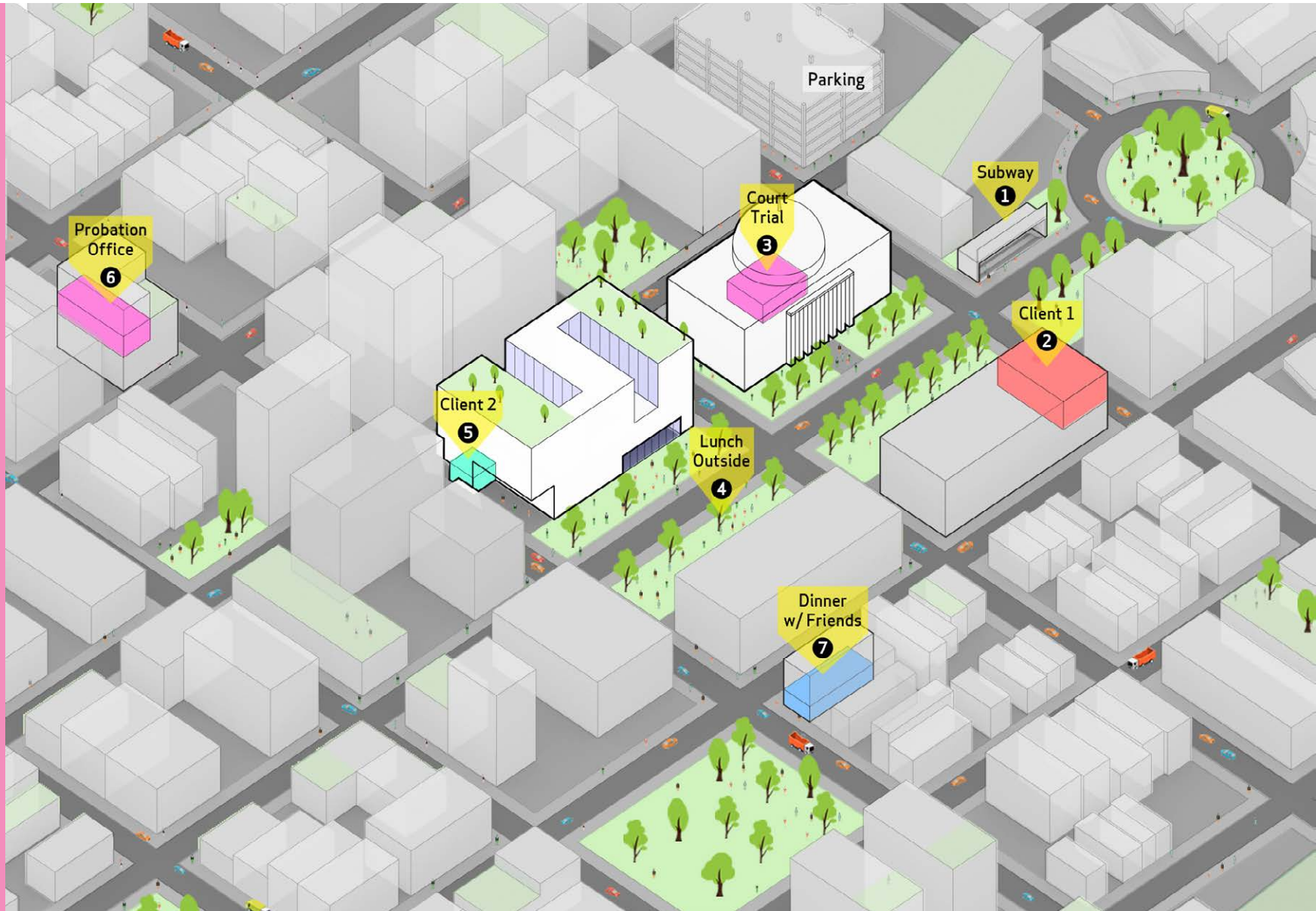

Back to Go



TOP: RIKERS ISLAND, 2011
AP PHOTO / BEBETO MATTHEWS

RIGHT: RIKERS ISLAND, 2015
AP PHOTO / SETH WENIG





2016 RALLY IN NEW YORK CITY
PHOTO BY [DAVID ETHERIDGE-BARTOW](#)

A MORE JUST NEW YORK CITY

Independent Commission on New York City
Criminal Justice and Incarceration Reform



Independent Commission on NYC Criminal Justice and Incarceration Reform

- Rethinking Incarceration
- Imagining the Island
- Future of jails



Program Design and Visuals

How do you design a program that creates innovative ideas around the future of jail infrastructure?

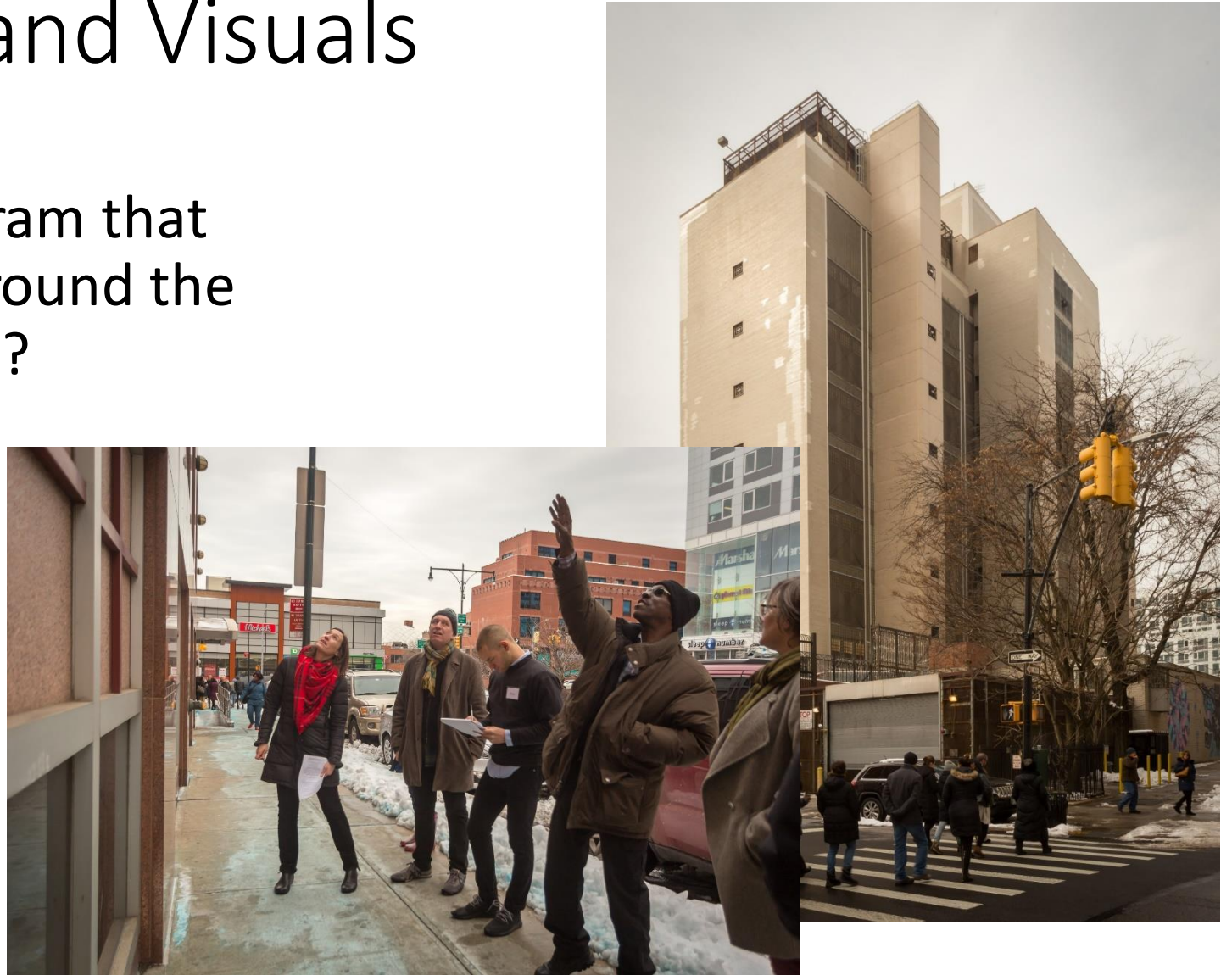

Goals

- Programmatic and design guidelines
- Innovative, realistic and progressive
- Consideration for interior and exterior



Outputs

Report

- Outline **existing challenges** with jail design
- Opportunities to **improve jail interiors** for different stakeholders
- Design solutions to improve **relationship between jails and surrounding community**
- **Programmatic** opportunities
- Research **limitations** and **future explorations**



Inquiry

- How can we create designs that are more **healthy, rehabilitative, and respectful** to those in jail and the communities that interact with them?
- What impact does a jail have on the community it is in and how can the design of a **decentralized jail system** improve any negative effects?
- What social services and programming can we include that will help inmates **re-enter** the community?
- What site elements are important to include in the design of a **community-based jail**?
- What types of **neighborhood services and amenities** can be offered that will complement the community?

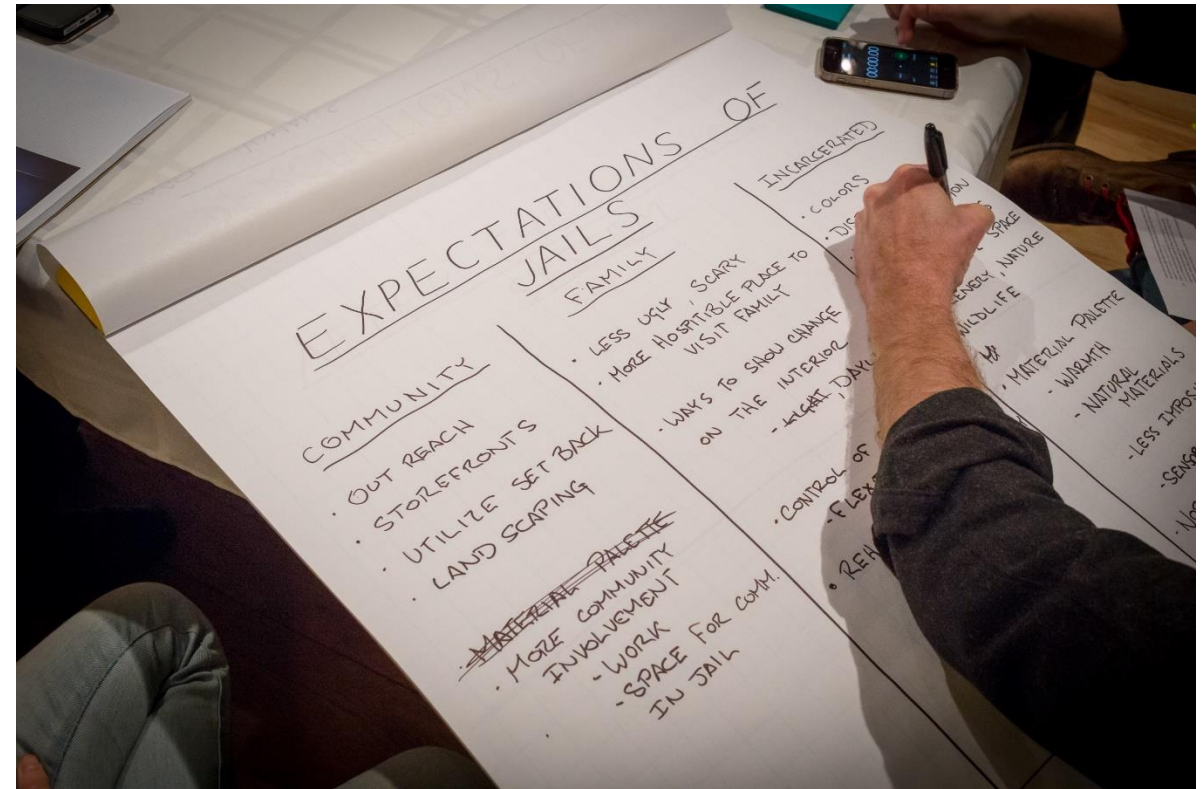

Jurors

- **Courtney Bryan**, *Director of Criminal Justice Operations*, [Center for Court Innovation](#)
- **David Chapin**, *Architect and Professor, Ph.D. Program of Environmental Psychology*, [CUNY Graduate Center](#)
- **Mylan Denerstein**, *Partner*, [Gibson, Dunn & Crutcher](#)
- **Alta Indelman**, *Principal*, [Alta Indelman Architect](#)
- **Michael Jacobson**, *Executive Director*, [CUNY Institute for State & Local Governance](#)
- **Jessica Lax**, *Director of Competitions*, [Van Alen Institute](#)
- **Stanley Richards**, *Senior Vice President*, [The Fortune Society](#)



Team Selection



JUSTICE IN DESIGN
REQUEST FOR QUALIFICATIONS
JANUARY 2, 2017

NADAAA

DANIEL GALLAGHER, AIA
PRINCIPAL OF NADAAA
212.243.2845
DGALLAGHER@NADAAA.COM

NADER TEHRANI
DEAN, IRWIN S. CHANIN SCHOOL OF ARCHITECTURE
THE COOPER UNION
& PRINCIPAL OF NADAAA

WITH THE OSBORNE
ASSOCIATION,
& SUSAN OPOTOW
OF JOHN JAY COLLEGE OF CRIMINAL JUSTICE
& KAREN KUBEY

4 TEAM MEMBERS

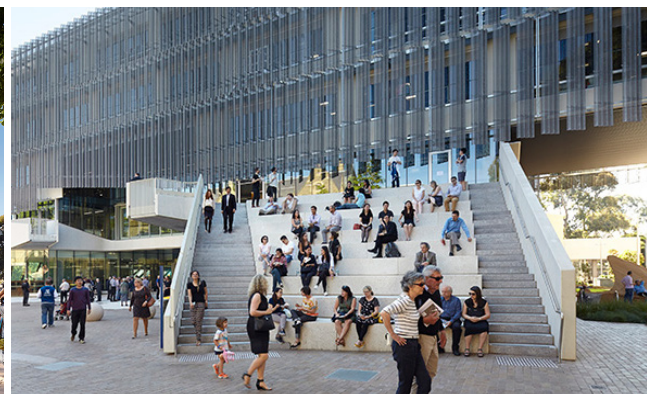

THE NEW MSD BUILDING CONTINUES THE SEQUENCE OF OUTDOOR ROOMS ARRAYED ACROSS URBAN NEIGHBORHOOD, AND INVITES THE PUBLIC IN THROUGH IT'S OPEN AND INTERACTIVE FAÇADE.

JUST & OPEN: URBAN ROOMS

The MSD building and its plazas respond to the urban context and enhance the open spaces on all four sides. Public courts were designed by **NADAAA** surrounding the building to serve as “living rooms” for the campus where exposed building details teach about design and sustainability. The project continues the sequence of outdoor rooms arrayed across the campus, linking circulation routes that surround the site through the building on its internal “Street”. The building’s porous exterior was designed to invite the public in through discreet views of Studio Hall, and opening up workshops and galleries at the entry level for all to view ongoing work. The social/sharing drivers of this project

are significant and have made the building the most popular study location for students from all over campus and from all disciplines. The MSD also teaches the public about sustainable strategies by way of visible examples and informational plaques. For example one of the primary sustainable features of the building is the modulating solar screen that morphs as it wraps around the building to match the particular performance requirements that each solar orientation demands. This is made visible at the building’s corners where perforated/corrugated metal panels peel and stand off from the precast concrete surface.



EDUCATION & ASSEMBLY

INNOVATIVE SPACES OF LEARNING

NADAAA designed the Melbourne School of Design where problems of pedagogy come face to face with a physical environment that is inhabited and tested daily by an audience of experts, teachers, and students, the very protagonists of the medium. It is perhaps one of the few occasions where the audience is engaging with the building and its authors at a higher level, making it an added challenge to speak to architectural and social questions with a greater degree of nuance. The building is active in the education of its occupants and visitors through its clarity of materials, tectonics, and organization and expresses the complexities of contradicting architectural, urban, and social pressures. The design foresaw some critical

changes in architectural education that are the result of interdisciplinary work, and how spaces of pedagogy can react to and accommodate a platform for various fields to come together and form something larger than the sum of their parts for the good of its students and their future contributions to society. In a time of both economic crisis and ecological vulnerability, the building addresses the use of resources, challenges conventional means and methods of project delivery, and considers the life cycle implications of the building. It's innovative maker spaces have opened up fabrications and job training possibilities for students who leave the school fully prepared for the design studio.

MAKER SPACES & JOB TRAINING

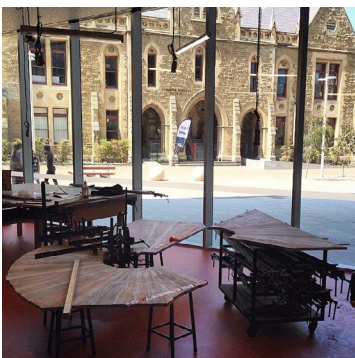

SAFETY FIRST

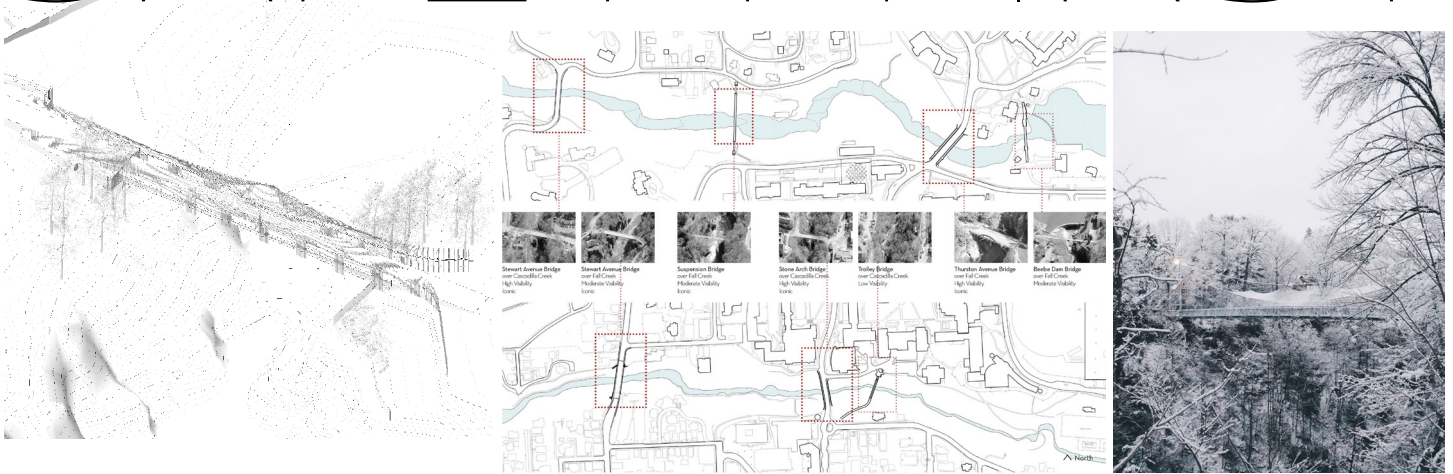

NADAAA DESIGNED SAFETY SOLUTIONS FOR SEVEN BRIDGES CROSSING THE GORGES SURROUNDING CORNELL UNIVERSITY. WORKING WITH THE CITY OF ITHACA, CORNELL UNIVERSITY, AND MENTAL HEALTH EXPERTS THE SUBTLE AND SENSITIVE WORK CREATED SAFETY MEASURES FOR SUICIDE PREVENTION.

SPACE FOR REPOSE & RESTORATION IN AN URBAN CONTEXT



OUTDOOR COMMUNITY GATHERING AREAS WERE DESIGNED BY NADAAA FOR THE NEW MACALLEN BUILDING AND THE RENOVATION OF THE NEXT DOOR COURT SQUARE RESIDENTIAL BUILDING THAT HAVE A BUFFER FROM THE URBAN ACTIVITY AROUND THE BUILDINGS.

STAKEHOLDER ENGAGEMENT

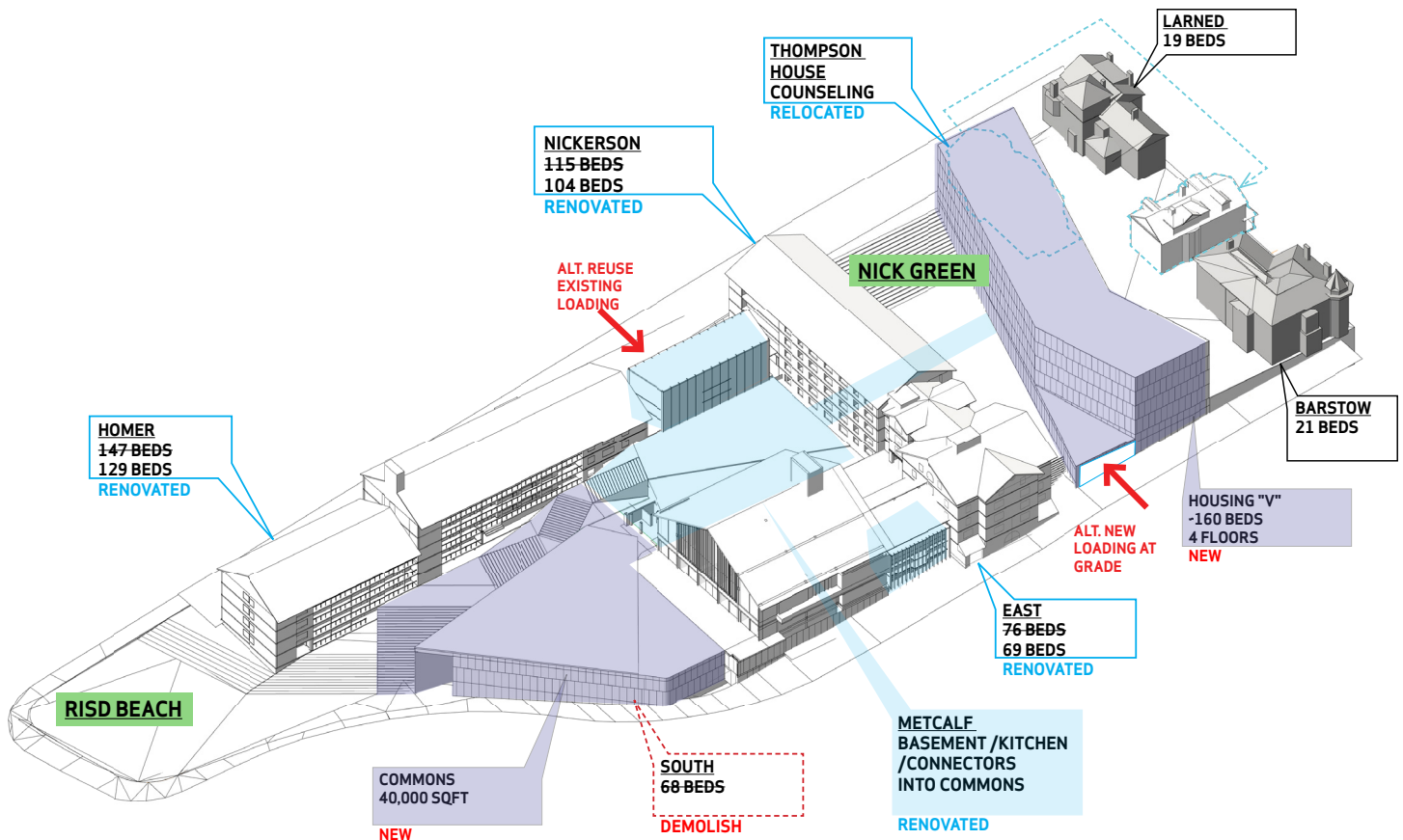

NADAAA is working with multiple public and private stakeholders of The Rhode Island School of Design and the City of Providence, engaging in workshops as well as student drop-ins. The RISD masterplan focus is on the intersection of landscape and architecture creating active urban spaces with a

particular focus on accessibility and safety. New programmatic options that better respond to the art students needs are being proposed including a variety of shared and private studio spaces, more spaces for socializing, and increased safety for the students on their urban block.

TEAM VALUES

Bring our collective imagination and skills to identify principles for urban jails and related programs.

During the PROCESS are:

- **attentive to the issues, concerns, and needs multiple stakeholders**
- **attentive to accessibility and safety**
- **utilize a process that is inclusive in all aspects: communication, planning, etc.**
- **consistent with ethical principles of our field**

Create OUTCOMES, that:

- **foster constructive connections between the institution of the jail and the context in which it is situated**
- **foster the wellbeing of people living and working in and visiting these institutions, including physical and mental health**
- **reduce violence and improve outcome**
- **attend to the role of the built environment in fostering caring and respectful connections among people**
- **provide a secure interface between the jail or detention center and the larger community while encouraging mutually-productive programmatic contacts between those inside and outside**
- **accommodate a wide variety of programmatic activities**
- **permit residents' and workers' contact with nature (e.g., visually, sensorily, or other ways)**
- **allow flexibility for future modifications**
- **teach those who live, work, visit, or are neighbors to the building, by visible example, about sustainable, efficient, through aesthetically engaging design**



Workshops



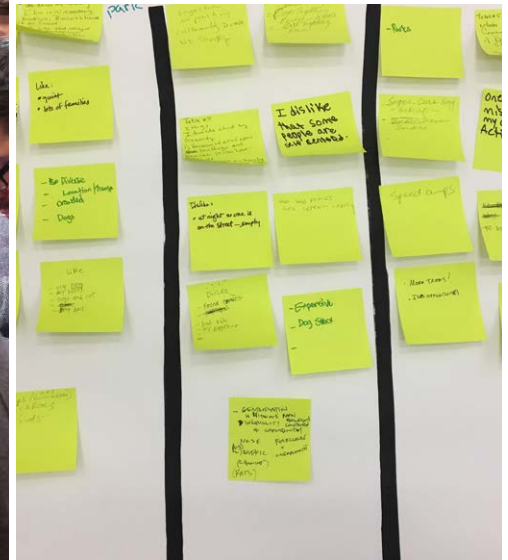

WORKSHOP PROCESS



Wlt

PERCEPTIONS OF JAILS

- Fear
- Punitiveness
- threatening
- Punishment
- Danger
- Old/Outdated
- Dirty
- minorities (targeting) seeking ppl of color
- exploitative
- business
- violent
- impersonal
- unwelcoming/unfriendly
- isolation
- dehumanizing
- damaging
- breakdown families & community
- separation

ADJECTIVES THAT DESCRIBE JAILS.

- Dark
- Noise
- Smell
- Concrete (hard)
- Unpredictable
- grey/gray
- no privacy
- intimidating
- insanity
- degrading
- disrespectful
- designed for men
- Stigmatizing
- Confusion & danger
- dehumanizing
- brutality
- starvation

PERCEPTION OF JAIL

- Financial ~~burden~~
Burden

- NO Peace
- NO Justice

- Isolation
- Cruelty
- Judgementally
→ In humane treatment

- Expensive
- Street Justice
- Money ~~planer~~
- Lost of humanity

- Stressful environment
- Powerless
- Fork in the road
- Lack of family structure

ADJECTIVES ABOUT JAIL DESIGN

- Violence

- Remorse
- No self-esteem
- Distort ✓

- Cold

- Dark
- Separation

- Operation
relate
on people

- Demonic

- Old
- Broken

- Depress

- Stress

- Dirty

- Small

- ~~chaos~~ Chaos

1) STOP Profiling
2) Social Responsibility
Towards rehabilitative
Care.

3) Fair And Just
Safety

4) Punishment
Proportion to
the Client

5) more ~~inferences~~
inferences on
Alternatives for
incarceration

6) Safety

7) Opportunity
Return better
than they Went
in.

8) Speedy indjudi-
cation "Speedy"
Trial

9) Fair Due
Process

Positive
Programming

Justice System
recognize inmate
as a human being
Opportunity to
Provide for my
family. Financial
Economic
Social.

Compliance of
all mandates

Humane family
Visits.

Adequate medical
Physch and housing
Care while incarcerated

- Rehabilitation
- Mental Health
- access ←
- Transparency
- Safety ←
- Clean ←
- Automate
- Small ←
- Education Services
- Medical Services
- Light
- Easy lawyer access
- Speedy trial Law

- expense

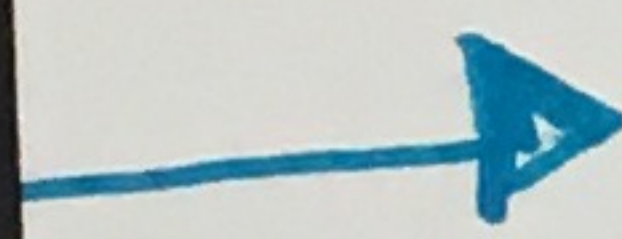
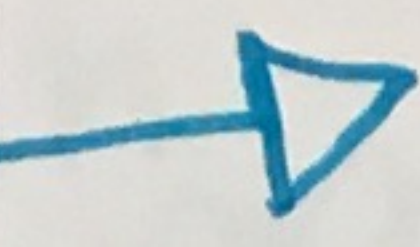

~~Separate~~ building
Separate

- Smaller housing Area.

- Support
- Independence

- Clean
- Technical
- places of gathering
- Outside Programs
- Nature
- Places of Green
- Similar to outside Community
- Programs to help us think outside the Box.

HOPE

Guidance
Opportunity
Don't Return
JOB

HOUSING

~~T~~reatment

Welcome
Training
Preparation

EMOTIONS

Safe

Welcomed

Respected

Accepted

Productive

Confident

Feeling of opportunities

directions

believed

Sense of freedom

SLAVED

DISFRANCHISED

UN-SUPPORTED







COMMUNITY CONNECTIONS AND THE CIVIC EXPERIENCE

CITY LIVING: A DAY IN THE LIFE

People engage city elements in specific ways and share coincidental connections. Realizing our connectedness can help shape a positive understanding of who we are and how we define New York City.

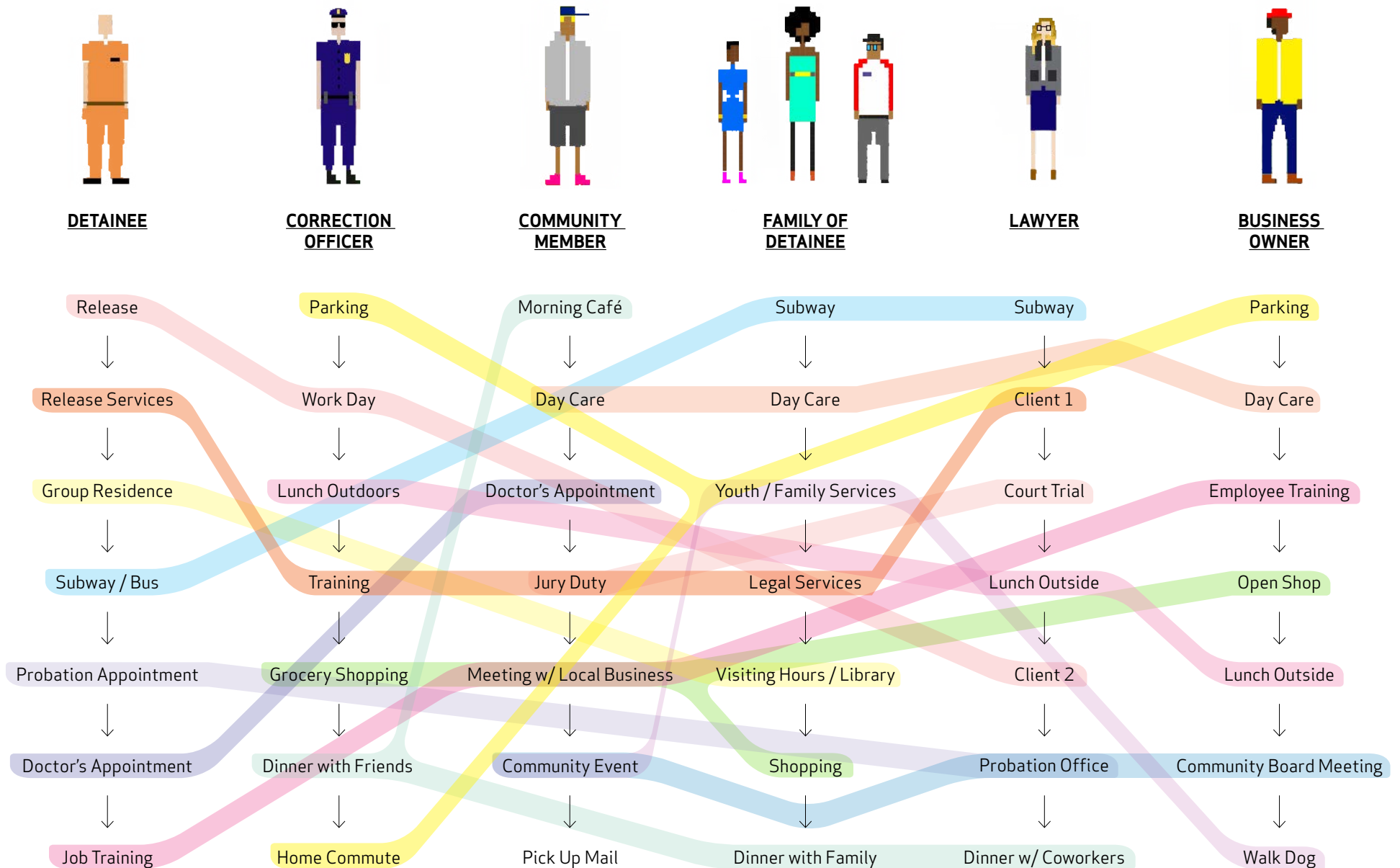

CITY LIVING / CIVIC CONNECTIONS

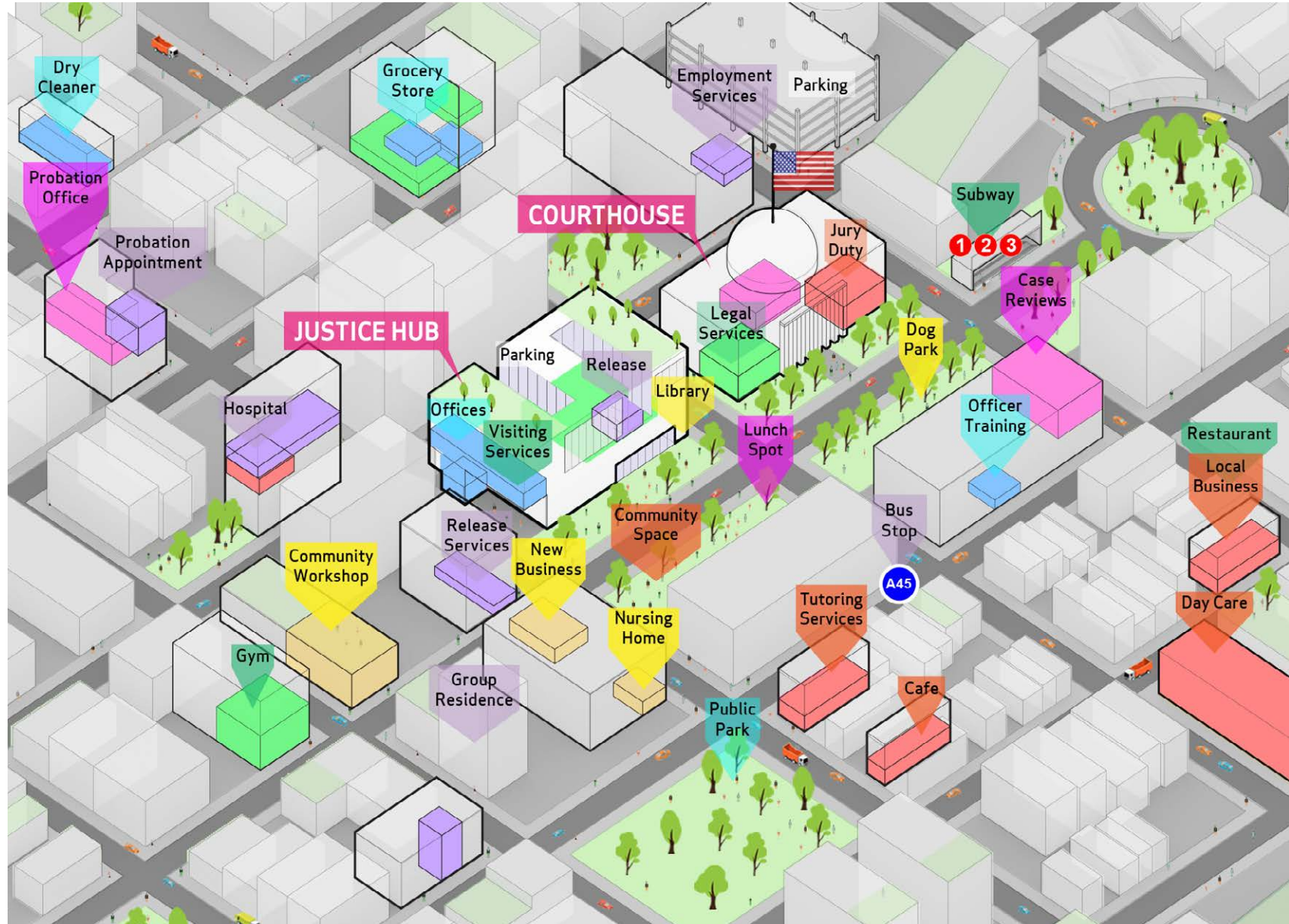
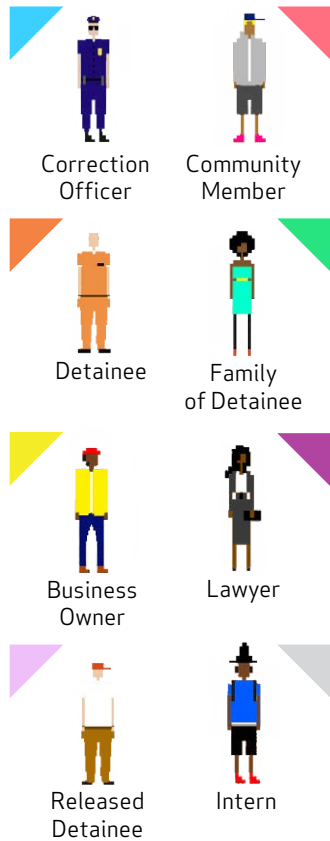



JUSTICE HUB IN THE CITY

A building in proximity to
courts and other civic uses

JUSTICE HUB IN THE CITY

A building open and inviting to
all with programs to benefit all
aspects of the community

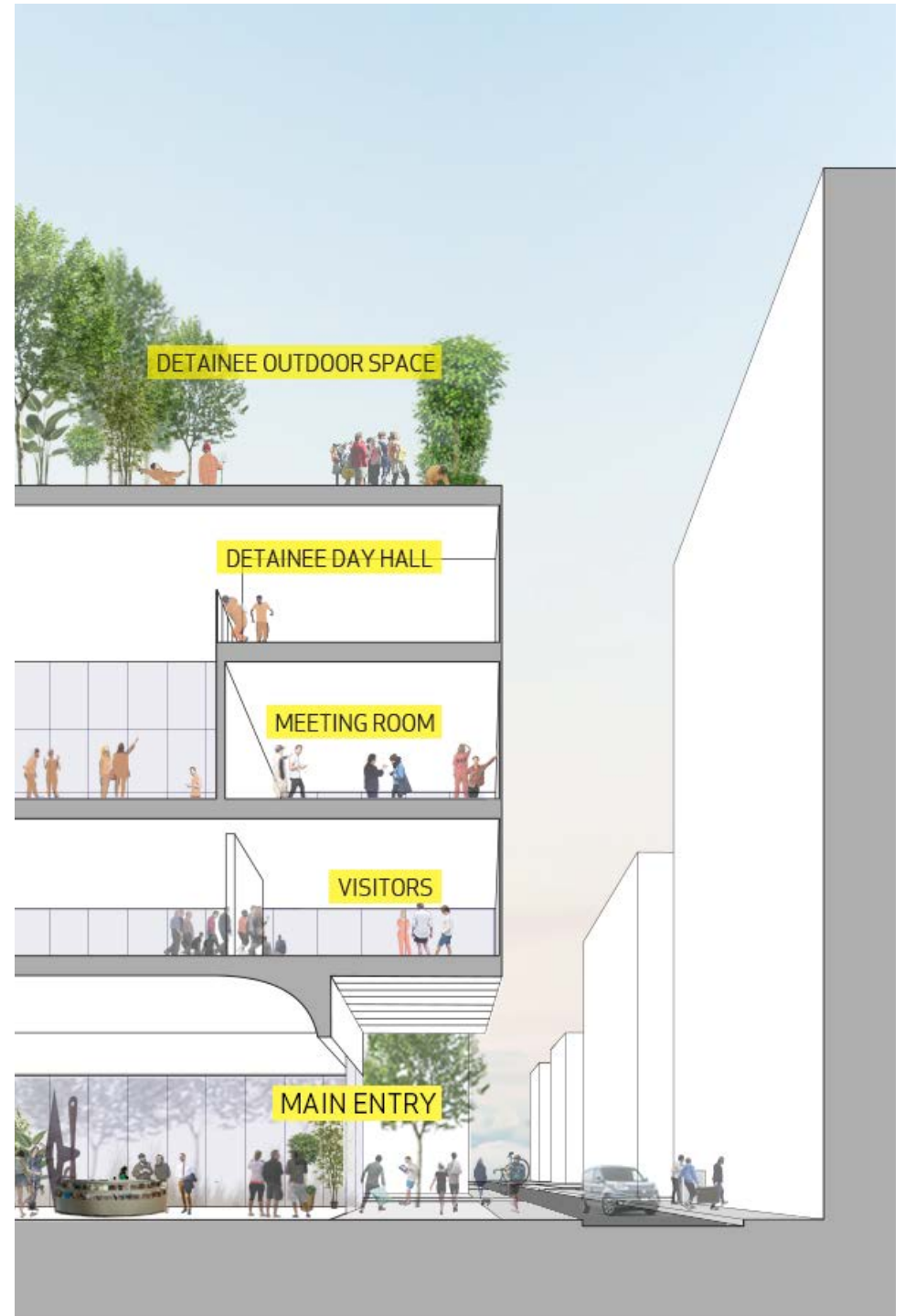

Section indication subway entrance, parking garage, Justice Hub, and courthouse

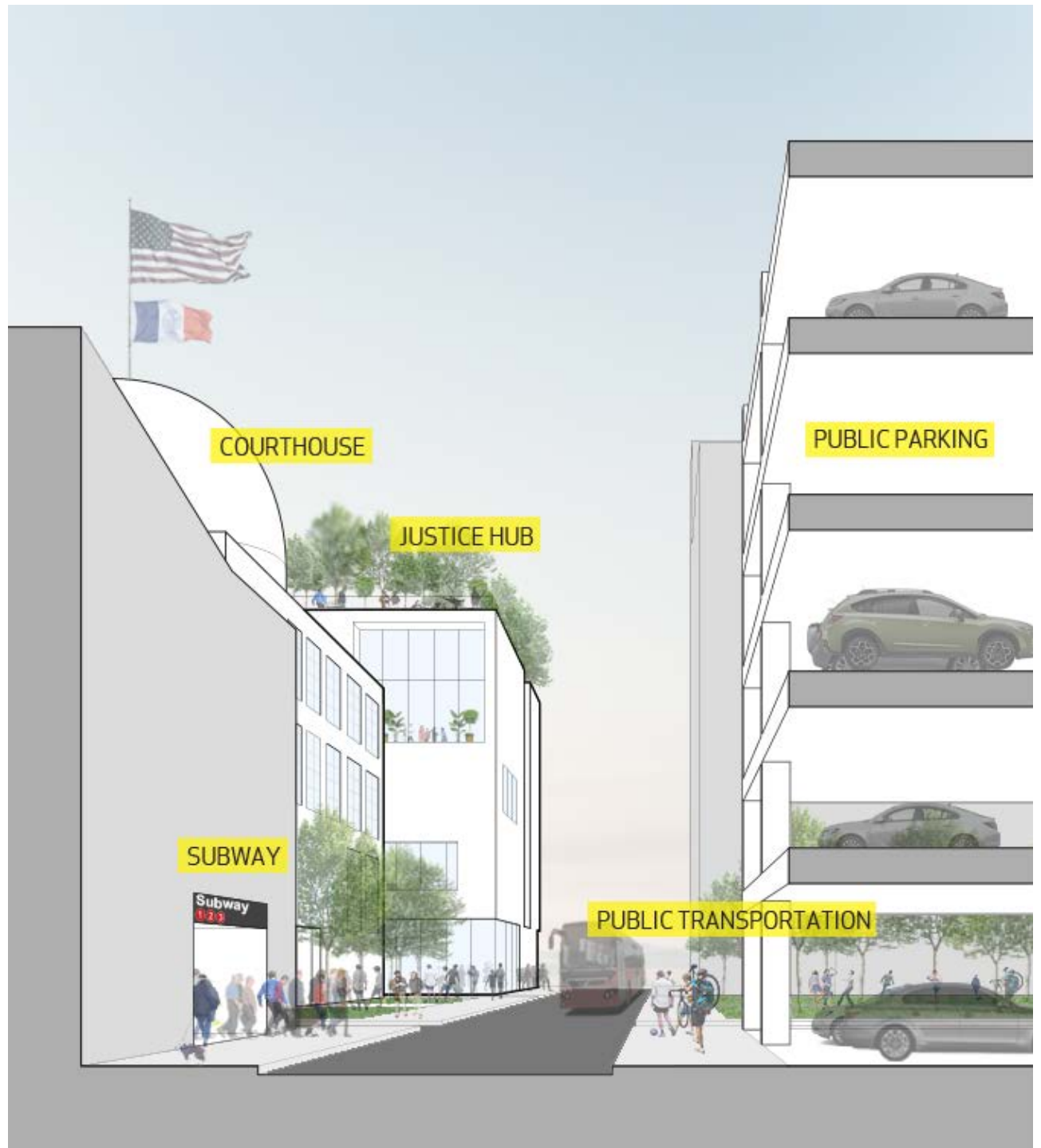

Steps Forward

CONCLUSION
IMPERATIVE FOR CHANGE