

2011 AAJ National Conference

POETIC PRAGMATISM

NOVEMBER 2-4, 2011
LOS ANGELES, CA

CELEBRATING CREATIVE, COST EFFECTIVE, AND
FUNCTIONAL DESIGN FOR JUSTICE FACILITIES



THE AMERICAN INSTITUTE
OF ARCHITECTS
Academy of Architecture for Justice

www.aia.org/aaaj

A MESSAGE FROM THIS YEAR'S CONFERENCE CHAIR



Welcome to the Los Angeles Biltmore and the AIA Academy of Architecture for Justice annual fall conference. This year's conference theme is Poetic Pragmatism: Celebrating Creative, Cost Effective, and Functional Design for Justice Facilities. The theme is a kind way of stating the question: Sure, it is a beautiful building, but does it function? Did it meet the user's needs? Did it meet the budget? Is it easy to maintain?

Most of this year's presentations were selected because in some way, they addressed both the poetic and pragmatic aspects of justice architecture. As the conference co-chair, Kelly Quinn, who oversees planning for the construction program for the California Administrative Office of the Courts, guided the conference theme towards addressing the challenges owners, users, designers, and builders face with limited resources in these tough economic times. This is reflected not only in the conference theme, but in each conference panel, which weaves in the owner's or user's perspective. In addition, I would like to thank Kelly for arranging for Chief Justice of California, Tani Cantil-Sakauye, to join us as our keynote luncheon speaker.

Joining us on our conference planning committee is Michael LeBoeuf, FAIA as the court track leader. Marayca Lopez, PhD is the detention/corrections track leader. Kyle Yardley, AIA is track leader for law enforcement and other projects which either fall outside these categories or address more than one. Each of these track chairs has made significant contributions to this conference with their time and efforts.

I cannot express how much the national AIA assisted with this conference. Douglas Paul was along for the ride since we began the process in December of 2010, and I often wondered how he supported other events. Chris Capistrant was involved early on, securing the hotel and researching all of the venues. Andrea Cathy seamlessly took over for him when he moved onto other projects. Tonya Horsley was integral to wrapping up the details and securing the venue for the JFR dinner.

Steven Fong from my office worked to develop all of the conference graphics, Power-Point masters, and this program document. Dwight Mitsunaga, AIA helped categorize and grade presentation submittals. Rick Macia, AIA and AAJ Advisory Group offered his support and advice. Nick Seierup, FAIA and Dan Sandall, AIA offered assistance from the newly formed AAJ Los Angeles chapter.

Finally, I wish to extend my gratitude to Susan Oldroyd, FAIA, for her support from the sidelines. She was integral in arranging both the opening and closing plenaries.

I hope you find the conference both entertaining and educational. I also hope you find time to enjoy Los Angeles and southern California. Thank you for attending, and helping to ensure this conference is a success.

Sincerely,

A stylized, handwritten signature in white ink, appearing to read 'Lorenzo Lopez'.

Lorenzo Lopez, AIA
Conference Chair, AAJ 2011



PROGRAM CONTENTS

Message from the Chair	1
Contents	2
Message from the AAJ	4
Conference Schedule	5
Concurrent Sessions	6
Architectural Tours	8
Plenary and Keynote	9
Session Descriptions	10
Speaker Biographies	16
Exhibitor Information	28
Conference Map	30
Eat, See, and Play	32
Saturday Workshop	34

A MESSAGE FROM THE AAJ ADVISORY GROUP



As we enter another year of continuing economic challenges it is with great pride that I can report that the Academy of Architecture for Justice (AAJ) is as strong as ever. Through the incredible efforts of our many hard working volunteers and the renewed support from the AIA we have been able to once again put together our complete program of activities for 2011. As one of the national Knowledge Communities of the AIA it is our mission to generate and disseminate knowledge related to design for the justice community. I hope you enjoy our 2011 conference and find it helpful and informative.

The AAJ's eight committees are responsible for ensuring that all of our many activities are successful. They include our Conference Committee, this year chaired by Lorenzo Lopez with Kelly Quinn as co-chair. They have put together an excellent program for our Los Angeles conference, including three full tracks and great keynote speakers. Ryan Critchfield, as chair of the Justice Facilities Review Committee, has supervised the production of another wonderful edition of our JFR publication. April Pottorff has done an excellent job in getting out our quarterly electronic newsletter as chair of the Communications Committee. Susan Oldroyd (Justice Partners), Ken Ricci and Julia Hughes (Sustainability), Frank J. Greene (Local Components), Jay Farbstein and Melissa Farling (Research) and Linda Bernauer (Sponsorships) have worked diligently on the many other facets of our Knowledge Community.

Lastly, as chair of the Advisory Group, I would like to thank my fellow Advisory Group members, Larry Hartman, Herb Roth, Liz Minnis and Catherine Chan for their unwavering support and assistance.

Enjoy the Conference and enjoy Los Angeles!

Sincerely,

A handwritten signature in dark ink, appearing to read 'Enrique Maciá'. The signature is fluid and cursive, with a long horizontal stroke extending to the right.

Enrique Maciá
2011 Advisory Group Chair

SCHEDULE AT A GLANCE

WEDNESDAY, NOVEMBER 2ND

11:00 AM	Registration Begins
12:00 PM — 1:00 PM	Self Guided Tours Of Disney Concert Hall
1:00 PM — 2:00 PM	AAJ Committee (open to anyone interested in leadership)
1:30 PM — 3:00 PM	Tours Of Cathedral
4:00 PM — 5:30 PM	Opening Plenary In Crystal Ballroom: Daniel Patrick Moynihan "Guiding Principles 50 th Anniversary"
5:30 PM — 7:30 PM	Welcome Reception With Exhibitors

THURSDAY, NOVEMBER 3RD

7:00 AM — 8:00 AM	Continental Breakfast With Exhibitors
8:00 AM — 9:30 AM	Concurrent Sessions
9:45 AM — 11:15 AM	Concurrent Sessions
11:30 AM — 1:00 PM	Keynote Lunch in Crystal Ballroom: Hon. Tani Cantil-Sakauye, Chief Justice of California
1:15 PM — 2:45 PM	Concurrent Sessions
2:45 PM — 3:30 PM	Afternoon Break With Exhibitors
3:30 PM — 5:00 PM	Concurrent Sessions
5:00 PM — 6:00 PM	Reception With Exhibitors
7:00 PM — 10:00 PM	JFR Awards Banquet— Gold Room, Millennium Biltmore

FRIDAY, NOVEMBER 4TH

7:00 AM — 8:00 AM	Continental Breakfast With Richard Ross Exhibit
8:00 AM — 9:30 AM	Concurrent Sessions
9:45 AM — 11:45 AM	Corrections/Detention Track Session
9:45 AM — 10:40 AM	Court Track Session
10:50 AM — 11:45 AM	Court Track Session
9:45 AM — 1:30 PM	Tours
11:45 AM — 1:30 PM	Lunch On Your Own / Tours Available
1:45 PM — 3:15 PM	Concurrent Sessions
3:30 PM — 5:00 PM	Closing Plenary in Crystal Ballroom: "Do You Hear What I See? Helping The Prosaic Become Poets"

SATURDAY NOVEMBER 6TH

9:00 AM — 2:00 PM	LJ Workshop, Aecom, 555 South Flower Street, Suite 3700
-------------------	---

CONCURRENT SESSIONS

	COURTS	CORRECTIONS/DETENTION	LAW ENFORCEMENT/OTHER
WEDNESDAY	CRYSTAL BALLROOM		
4:00PM	Opening Plenary: Leslie Shepherd “Daniel Patrick Moynihan Guiding Principles 50th Anniversary” 1.5 Hours		
THURSDAY	HEINSBERGEN	ROMAN	CORINTHIAN
8:00 AM	CT-01: 1.5 Hours Designing the Contemporary Courtroom SPEAKERS: Frank J. Greene, FAIA Lorenzo Lopez, AIA, LEED AP Chuck Oraftik, FAIA S. Ernest Swickard, AIA	CD-01: 1.5 Hours Five Principles of a High Performance Detention Center SPEAKERS: Jeff Goodale John Pulley Gary Retel, AIA, NCARB, LEED AP	LE/OT-01: 1.5 Hours Forensic Science Facilities “When a Laboratory is not a Laboratory” SPEAKERS: James Aguilar, AIA Dr. Eric Buel Russell McElroy Michael Moxam, OAA, LEED AP, Int. Assoc. AIA
9:45 AM	CT-02: 1.5 Hours Creative Process + Collaboration + Trust = Design Ingenuity SPEAKERS: Rebecca L. Binder, FAIA (moderator) Hon. Mark A. Cope Tom Donaghy, AIA, LEED AP Jay Farbstein, PhD, FAIA Ken Jandura, AIA Hamid Omidvar, AIA S. Ernest Swickard, AIA Timothy Young	CD-02: 1.5 Hours Measuring Effectiveness: Evidence-Based Detention Facilities Design SPEAKERS: Frank Guzzo Laura Maiello, BSW, MA Ken Ricci, FAIA	LE/OT-02: 1.5 Hours Evolution of a Design: Prototypes Police Stations SPEAKERS: Brandon Anderson, AIA, LEED AP Kelly Smith, AIA, LEED AP
11:30 AM	Keynote Lunch: Hon. Tani Cantil-Sakauye, Chief Justice of California 1.5 Hours		CRYSTAL BALLROOM
01:15 PM	CT-03: 1.5 Hours New European Courthouses: Critique, Irony, Theatrics (poetics) SPEAKERS: Frank J. Greene, FAIA Jay Farbstein, PhD, FAIA	CD-03: 1.5 Hours Creative Interpretation of Prototype Design for Corrections SPEAKERS: Timothy Gibson, AIA, LEED AP (moderator) Joe Haines, AIA Tom Robinson, AIA	LE/OT-03: 1.5 Hours Accessibility for Justice Facilities SPEAKERS: Rod Higgins, CASp, DSA Lorenzo Lopez, AIA, LEED AP Eric Sifuentes, CASp
03:30 PM	CT-04: 1.5 Hours Getting Better Court Facilities in Challenging Times SPEAKERS: Thomas Bonner Robert Fisch, AICP, LEED AP April Pottorff, AIA	CD-04: 1.5 Hours An Architectural Viewpoint on Female Incarceration SPEAKERS: Kerry Feeney, BES, B.Arch, MAA, LEED AP Margo Lee Barrie Ottenbreit, Partner, MAA, OAA, MAAA Kristen Sidoryk, BID, BA, PIDIM, NCIDO, LEED AP	LE/OT-04: 1.5 Hours Justice in the Public Realm. Two Solutions for Urban Police Facilities SPEAKERS: Fred Basch, AIA Christopher Gembinski Tom Kyle, OAA, LEED AP Michael Moxam, OAA, LEED AP, Int. Assoc. AIA
07:00 PM			LE/OT-05: JFR Banquet 1 Hour JFR 11 Jury - Creating an On-going Dialogue about Justice Architecture SPEAKERS GOLD ROOM Elizabeth Minnis, AIA & JFR ‘11 Jury Members



	COURTS	CORRECTIONS/DETENTION	LAW ENFORCEMENT/OTHER
FRIDAY	HEINSBERGEN	ROMAN	CORINTHIAN
8:00 AM	CT-05: 1.5 Hours Commitment to the Aging American Courthouse SPEAKERS: Kevin Kampschroer Michael LeBoeuf, FAIA (moderator) Patrick McGrath, CFM John Woelfling, AIA	CD-05: 1.5 Hours Justice Design for a New Economy SPEAKERS: Eric Hackman, LEED AP Robert Schwartz, LEED AP	LE/OT-06: 1.5 Hours LEED-J: Developing a Sustainability Rating System for Justice SPEAKERS: Melissa Farling, AIA, LEED AP Frank Green, FAIA Julia Hughes, AIA, LEED AP BD+C Susan Oldroyd, FAIA, LEED AP Beverly Prior, FAIA, NCARB, LEED AP Ken Ricci, FAIA Raphael Sperry, AIA, LEED AP BD+C O+M
9:45 AM	CT-06: 55 minutes New Model for Safety & Efficiency in Urban Courthouse Design SPEAKERS: David Evans, AIA Todd McMillen Tom Perica, AIA, LEED AP Marcus W. Reinkensmeyer	CD-06: 2 Hours Design/Build in Corrections Environments: Good, Bad, or Indifferent? SPEAKERS: Andrew Bohnert Mike Courtney, DBIA William H. (Buddy) Golson, Jr., AIA, NCARB Jeff Goodale James R. Kachik Sam Kaplan, NAVFAC SW Andrew Morgan, CCM James W. Mueller, AIA Chuck Oraftik, FAIA Alan Petrasek, CMAA Beverly Prior, FAIA, LEED AP, NCARB Dave Roach Steven A. Ruether Craig Unger Tina Wells, DBIA LEED AP Leann Wooten, NAVFAC SW, LEED AP	LE/OT-07: Overlapping 1 Hour Tours Tour of LAPD Police Administration Building
10:50 AM	CT-07: 55 minutes Rethinking Civic Architecture in Mississippi: Lessons Learned from the Jackson Federal Courthouse Project SPEAKERS: Daria Pizzetta, AIA Jack Martin, AIA, LEED AP Laura Shadix	(Continued from CD-06)	(Continued from LE/OT-07)
11:45 AM	Lunch Break		
01:45 PM	CT-08: 1.5 Hours Planning for and Designing New Courthouses, Large and Small: Lessons Learned from the California Court Building Program SPEAKERS: S. Pearl Freeman, AIA (moderator) Michael Duncan, AIA Tamara Dinsmore, AIA, LEED AP Hon. Douglas M. Elwell Jose O. Guillen Rona G. Rothenberg, FAIA Dan L. Wiley		LE/OT-08: 1.5 Hours Best Value - Alternative Delivery Methods SPEAKERS: Eric Fadness, AIA Joel Griffith Paul Lindsteadt Lorenzo Lopez, AIA, LEED AP (moderator) Andrew McPherson, AIA, LEED AP Rick Milletello Rob Uvalle
03:30 PM	Closing Plenary: Do You Hear What I See? Helping the Prosaic Become Poets 1.5 Hours SPEAKERS: Hon. Celeste F. Bremer Ray Greco, FAIA David J. Insinga, AIA, NCARB		
			CRYSTAL BALLROOM

ARCHITECTURAL TOURS



Walt Disney Music Hall

- Free self-guided audio tours (10:00 AM to 2:00 PM)
- Must bring photo I.D.
(preferably drivers license or passport, no credit cards)
- Meet in the Grand Lobby of Disney Hall and check in with Tour Staff
- Tour is 60 minutes
- 2:00 PM is the last hour guests can begin the tour



Cathedral of Our Lady of the Angels

- Free self-guided tour (7:30 AM to 6:00 PM)*
- Free docent-guided tour (1:00 PM)

*Alter area not accessible during mass (12:10-12:40 PM)

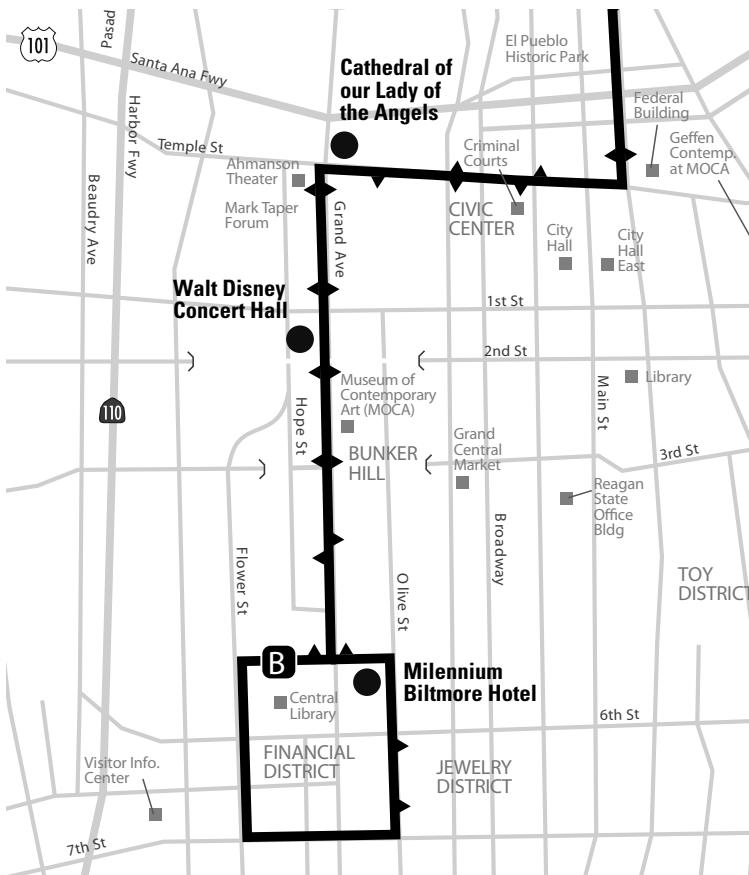

B DASH ROUTE B CHINATOWN / FINANCIAL DISTRICT Every 8 Minutes from 5:50 AM - 6:30 PM

AVAILABLE WEEKDAYS ONLY

DASH FARES

RIDER	FARE
Regular Fare	50¢
Persons 65 years of age or older* Persons with disabilities* Medicare card holders**	25¢
* with government agency issued proof of age or disability and photo ID ** with photo ID	
LADOT or DASH Monthly Pass holders	Free
EZ transit pass holders	Free
Metrolink Ticket/Pass holders (valid one-way, round trip or 10 trip ticket/monthly pass)	Free

PLENARY AND KEYNOTE

OPENING PLENARY

Daniel Patrick Moynihan Guiding Principles 50th Anniversary

Wednesday, November 2, 2011
4:00 – 5:30 PM

Les Shepherd will reflect on the relevance of Daniel Patrick Moynihan's Guiding Principles on their 50th anniversary. The Guiding Principles were created to ensure that federal architecture represented American ideals of dignity and stability, and embodied the finest architecture of its time. How have the Guiding Principles shaped justice architecture over the last half century? How successful have these designs been in providing the poetic and satisfying the pragmatic? How will the Guiding Principles affect the next 50 years of justice design?

Speaker

Leslie Shepherd, AIA
Chief Architect
Office of the Chief Architect

CLOSING PLENARY

Do You Hear What I See? Helping the Prosaic Become Poets

Friday, November 4, 2011
3:30 – 5:00 PM | CR

Reflecting on "Poetic Pragmatism", the closing plenary examines ways that architects, judges, users and project managers can be more effective in communication – helping each other "see" design opportunities – and making courthouses that inspire and move even the most prosaic to advocate for good design.

Speakers

David J. Insinga, AIA, NCARB (moderator)

Director for the Rocky Mountain and Pacific Zone in the Office of Design and Construction at the General Services Administration DC

Hon. Celeste F. Bremer, J.D., Ed.D.

US Magistrate Judge, Southern District of Iowa

Ray D. Greco, FAIA

KEYNOTE LUNCH

Access to Justice and California's Courthouses: Vision and Reality

Thursday, November 3, 2011
11:30 - 1:00 PM

The California court system has undertaken a visionary program to build and renovate more than 50 of the most urgently needed courthouses statewide, funded almost entirely by court users. The state's fiscal crisis, which has dramatically affected the court system, challenges this vision with stark new financial and political realities. Chief Justice Tani Cantil-Sakauye will address the significance of the California judicial branch's management of courthouses as a fundamental reform and the importance of vision, collaboration, flexibility, and pragmatism to continue progress toward the goal of improving the public's access to justice.

With an introduction by:

Ronald G. Overholt, Interim Administrative Director of the California Courts

Speaker

Hon. Tani Cantil-Sakauye,
Chief Justice of California

CR	Continuing Education Credit
HSW	Health, Safety and Welfare Credit
SD	Sustainable Design Credit
CAB	California SB 1608 Accessibility Credit

SESSION DESCRIPTIONS

COURTS

Designing the Contemporary Courtroom

Thursday, November 3, 2011

8:00 - 9:30 AM | CR

This session analyzes courtroom configurations: corner bench, center bench and re-centered bench. This includes case studies of recently completed courtrooms that represent the latest thinking in courtroom design. The Pros and Cons of each layout are discussed as well as challenges that are addressed during design.

SPEAKERS

Frank J. Greene, FAIA

Lorenzo Lopez, AIA, LEED AP

Chuck Oraftik, FAIA

S. Ernest Swickard, AIA

Judicial Council of California-Administrative Office of the Courts

Creative Process + Collaboration + Trust = Design Ingenuity

Thursday, November 3, 2011

9:45 - 11:15 AM | CR HSW CAB SD

The Courthouse is a civic monument and a public space, representing justice and the highest levels of dignity in society. This panel focuses on the process of the design team's establishing collaboration and trust with the Judicial Branch and client, and maximizing the public's investment in secure and accessible courthouse facilities in a depressed economy.

SPEAKERS

Banning Justice Center

Rebecca L. Binder, FAIA (moderator)

Hon. Mark A. Cope

Assistant Presiding Judge, Superior Court of California, County of Riverside

S. Ernest Swickard, AIA

Judicial Council of California-Administrative Office of the Courts

Jay Farbstein, PhD, FAIA

Montgomery County Circuit Courthouse Renovation and Expansion

Tom Donaghy, AIA LEED AP

Ken Jandura, AIA

Hamid Omidvar

Chief, Office of Special Projects, Montgomery County Dept. of General Services

New European Courthouses: Critique, Irony, Theatrics (poetics)

Thursday, November 3, 2011

1:15 - 2:45 PM | CR SD CAB

New courthouses in Europe base their formal strategies on partis conceptually distinct from those widely used for new courts in the US and Canada. Based on observations gained on a recent tour sponsored by the Court of the Future network the insights gained suggests more critical and nuanced opportunities and sources of inspiration for the courthouse designer

SPEAKERS

Frank J. Greene, FAIA (moderator)

Jay Farbstein, PhD, FAIA

Getting Better Court Facilities in Challenging Times

Thursday, November 3, 2011

3:30 - 5:00 PM | CR

During difficult economic times, it has never been harder to get courthouse renovation, expansion or new construction projects funded and approved. This session explores how public works and court users can justify their space and operational needs to make the most of scarce capital construction dollars. In addition to meeting operational needs, this can also be an opportunity to upgrade existing older buildings to meet current sustainable standards.

SPEAKERS

Thomas Bonner

Executive Director of Operations, City of New York, Office of the Criminal Justice Coordinator

Robert Fisch, AICP, LEED AP

April Pottorff, AIA

Commitment to the Aging American Courthouse

Friday, November 4, 2011

8:00 - 9:30 AM | CR HSW SD

As the landlord of the largest inventory of civic buildings, the GSA plays a significant role in how we cope with the aging of our American courthouses. The AOC in California is founded on similar principals. How do both agencies evaluate existing courthouse inventories and decide to reinvest in these buildings through high performance and functional efficiencies.

SPEAKERS

Michael LeBoeuf, FAIA (moderator)

Kevin Kampschroer

Director of the Office of Federal High-Performance Green Building, General Administration Services

Patrick McGrath

Judicial Council of California-Administrative Office of the Courts

John Woelfling, AIA



New Model for Safety & Efficiency in Urban Courthouse Design

Friday, November 4, 2011
9:45 - 10:40 AM | CR HSW

The Maricopa County Court Tower project is a model for collaboration and design innovation that has yielded a progressive approach to public safety and the administration of justice. The Court Tower adds a new dimension to safety through the programming of spaces for the victims of crime. This panel will discuss design solutions that result in a safe and efficient courthouse for all users.

SPEAKERS

Tom Perica, AIA LEED AP (moderator)

David Evans, AIA

Todd McMillen
Gilbane Building Company

Marcus W. Reinkensmeyer
Court Administrator, Judicial Branch of Arizona in Maricopa County

Rethinking Civic Architecture in Mississippi: Lessons Learned from the Jackson Federal Courthouse Project

Friday, November 4, 2011
10:50 - 11:45 AM | CR HSW

This presentation examines the challenges, complexities, and lessons learned in creating a new federal courthouse as part of the GSA's Design Excellence Program. Using the new 400,000 square foot Federal Courthouse in Jackson, Mississippi as the case study, representatives from the project team will discuss how a myriad of issues are carefully balanced.

SPEAKERS

Jack Martin, AIA, LEED AP

Daria Pizzetta, AIA

Laura Shadix
Senior Project Manager, General Services Administration

Planning for and Designing New Courthouses, Large and Small: Lessons Learned from the California Court Building Program

Friday, November 4, 2011
1:45 - 3:15 PM | CR HSW SD

In its short history, Judicial Council of California-AOC has achieved a portfolio of 59 courthouse projects (56 trial courts and 3 appellate courts) including 9 completed projects, 8 projects under-construction or pending construction this year, 13 projects in design and 29 projects in site acquisition. The panelists will discuss numerous lessons learned from the planning and design of these courthouses from the perspectives of the Owner (AOC), the User, (superior court) and the Design Team (court planner and architect) using courthouse examples from the AOC capital project program.

SPEAKERS

Tamara Dinsmore, AIA, LEED AP

Hon. Douglas M. Elwell
Presiding Judge, Superior Court of San Bernardino County

Michael Duncan, AIA

S. Pearl Freeman, AIA
Judicial Council of California-Administrative Office of the Courts (moderator)

Jose O. Guillen
Court Executive Officer, Superior Court of Sonoma County

Rona G. Rothenberg, FAIA
Judicial Council of California-Administrative Office of the Courts

Dan L. Wiley,
Dan L. Wiley & Associates

TRACK CHAIR: Michael LeBoeuf, FAIA

SESSION DESCRIPTIONS

CORRECTIONS AND DETENTIONS

Five Principles of a High Performance Detention Center

Friday, November 4, 2011

1:45 – 3:15 PM | HSW, SD

Using the recently designed and currently under construction Douglas County, Georgia Detention Center and Law Enforcement Facility as a case study, the course will outline strategies to achieve the five principals of a high performance detention center:

1. Optimize staff environment
2. Support efficient operations
3. Reduced life-cycle costs
4. Optimize budget
5. Contribute to a sustainable community

SPEAKERS

Jeff Goodale

John Pulley

Gary Retel, AIA, LEED NCARB



Measuring Effectiveness: Evidence-Based Detention Facilities Design

Thursday, November 3, 2011

9:45 – 11:15 AM | HSW

Money for new detention facilities is scarce. Architects can help justify the construction of new facilities through a rigorous examination of key challenges that the proposed new facility needs to solve. The effectiveness approach to detention facility design begins in the programming and planning phase. “What will make our new facility effective?” is the key question that architects should be asking their clients. For example, instead of asking “How large should our facility be?” clients should ask “Where is the evidence supporting the need for new beds?”. Perhaps the better formulation is the question “How small should our new facility be and still do its job?” Reducing the building footprint calls for analysis of the justice system activities (police, courts, probation, etc) that create the bed space needs and the development of alternate strategies to divert, treat and speed the adjudication offenders. This in turn reduces the number of admissions, reduces length of stay and results in fewer beds, a smaller building footprint and a more manageable budget.

SPEAKERS

Frank Guzzo

Laura Maiello, BSW, MA

Kenneth Ricci, FAIA

Creative Interpretation of Prototype Design for Corrections

Thursday, November 3, 2011

1:15 – 2:45 PM | SD

Faced with the issue of reuse of an existing prototype and a pre-defined program from our clients, do we, as architects accept this as our basis of design or do we push the creative aspects of the definition of a prototype with a more cost effective, sustainable, and functional solution?

SPEAKERS

Timothy A. Gibson, AIA, LEED AP (moderator)

Joe Haines, AIA

Tom Robinson, AIA



An Architectural Viewpoint on Female Incarceration

Thursday, November 3, 2011

3:30 – 5:00 PM | HSW

Although a small portion of the incarcerated today, women are the fastest rising criminal population in North America and their architectural needs are therefore worthy of our consideration. This presentation focuses on appropriate and effective designs of correctional facilities for women and discusses the new Women's Correctional Centre in Manitoba Canada.

SPEAKERS

Kerry Feeney, BES, B.Arch, MAA, LEED AP

Margo Lee

Barrie Ottenbreit, MAA, OAA, MAAA

Kristin Sidoryk, BID, BA, PIDIM, NCIDQ, LEED AP

Justice Design for a New Economy

Friday, November 4, 2011

8:00 – 09:30 AM | HSW, CAB, SD

Current economic times require governments and their architects to deliver more with less. This presentation utilizes three recent Michigan county detention and court projects to demonstrate methods to improve operation, security and efficiency within limited budgets including review of their needs assessments, schedules, high efficiency building systems, facility re-use, and accessibility strategies.

SPEAKERS

Robert W. Schwartz, AIA, LEED AP

Eric Hackman, AIA, LEED AP

Design/Build in Corrections Environments: Good, Bad, or Indifferent?

Friday, November 4, 2011

9:45 - 11:15 AM

Alternative project delivery methods are being more utilized in the planning, design, and construction of detention and correctional facilities. The various forms of design/build have redefined the roles and responsibilities of the participating parties. What variations exist, pros/cons, and how the design professional is affected will be discussed.

SPEAKERS

Andrew Bohnert

Mike Courtney, DBIA

William H. (Buddy) Golson, Jr., AIA, NCARB

Jeff Goodale

James R. Kachik

Sam Kaplan, NAVFAC SW

Andrew Morgan, CCM

James W. Mueller, AIA

Chuck Oraftik, FAIA

Alan Petrusek, CMAA

Beverly Prior, FAIA, LEED AP, NCARB

Dave Roach

Steven A. Ruether

Craig Unger

Tina Wells, DBIA LEED AP

Leann Wooten, NAVFAC SW, LEED AP

TRACK CHAIR: Marayca Lopez, PhD

CR	Continuing Education Credit
HSW	Health, Safety and Welfare Credit
SD	Sustainable Design Credit
CAB	California SB 1608 Accessibility Credit

SESSION DESCRIPTIONS

LAW ENFORCEMENT AND OTHER

Forensic Science Facilities “When a Laboratory is Not a Laboratory”

Thursday, November 3, 2011
8:00 - 9:30 AM | CR HSW SD

This session will present a discussion on what makes a forensic laboratory project unique. You will learn what building types fall under the umbrella of “forensic science facility”. You will learn the specific spaces and functions which could typically be included in a forensic project. The presentation will also highlight some of the unique functions and design features which impact the design of these specialized facilities. Case studies of completed forensic facilities will be included to highlight the unique features.

This presentation will include lessons learned via a Crime Laboratory Director’s perspective on his expectation and experiences encountered during the design and construction of a recently completed state-of-art crime laboratory.

Speakers

James Aguilar, AIA
Dr. Eric Buel
Russell McElroy, AIA, NCARB
Michael Moxam, OAA, FRAIC, LEED AP, Int. Assoc AIA

Evolution of a Design: Prototypes | Police Stations

Thursday, November 3, 2011
9:45 - 11:15 AM | CR

This session will illustrate how the development and implementation of a simple and iconic prototype for the Colorado State Patrol inspires creative design solutions in larger law enforcement facilities.

Speakers

Brandon Anderson, AIA, LEED AP
Kelly Smith, AIA, LEED AP

Accessibility for Justice Facilities

Thursday, November 3, 2011
1:15 - 2:45 PM | HSW SD CAB

This session will focus specifically on accessibility for court, jail, and prison facilities. It will also stress the value to owners and users of good universal design practices while promoting good design overall. This session was developed in conjunction with Rod Higgins with the Division of the State Architect, and includes specific accessibility issues he has seen in justice projects under his purview.

Speakers

Rod Higgins, CASp, DSA
Lorenzo Lopez, AIA, LEED AP
Eric Sifuentes, CASp

Justice and the Public Realm | Two Solutions for Urban Police Facilities

Thursday, November 3, 2011
3:30 - 5:00 PM | CR HSW SD

This session is split into two individual case studies for urban police facilities.

Case Study 1: Police Facility as Urban Citizen. Community history, culture and resident aspirations are core to the development of vital urban neighborhoods. Fundamental to their health and wellness are law enforcement facilities. The principal of community policing are founded in the full participation of community representatives in the design process. This case study of the Toronto Police 11 Division demonstrates the collaborative power of architecture to achieve community and police interests.

Speakers

Tom Kyle, OAA, LEED AP
Michael A. Moxam, OAA, LEED AP, Int. Assoc. AIA

Case Study 2: From Barn to Police Station: Central Park Police Precinct: A graphic presentation of the Central Park Police Station renovation that will highlight the creative strategies used to guide the design process. This presentation will focus on building design, preservation, building security and materials and systems used to transform a 140 year old building into a modern law enforcement facility.

Speakers

Fred Basch, AIA
Christopher Gembinski

LEED-J: Developing a Sustainability Rating System for Justice

Friday, November 4, 2011
8:00 - 9:30 AM | CR HSW SD

Justice facilities have unique challenges and opportunities for achieving sustainability. Building on the AAJ Sustainable Justice Committee's 2011 "Green Guide for Justice" and informed by the LEED for Healthcare rating system, this work session will be an opportunity to review and discuss a draft sustainability rating system for justice facilities.

Speakers

Melissa Farling, AIA, LEED AP
Frank Green, FAIA
Julia Hughes, AIA, LEED AP BD+C
Susan Oldroyd, FAIA, LEED AP
Beverly Prior, FAIA, NCARB, LEED AP
Ken Ricci, FAIA
Raphael Sperry, AIA, LEED AP BD+C O+M

Tour of the LAPD Police Administration Building

Friday, November 4, 2011
9:45 - 1:30 AM | CR

The new Los Angeles Police Department Police Administration Building in downtown Los Angeles was built to replace the nearly 60 year old Parker Center, the former headquarters of the LAPD. In designing the replacement for their aging and unsafe headquarters, the main goal of the LAPD was to make manifest their desire for increased transparency while at the same time maintain a secure and safe environment for the building's users and visitors. Located at the threshold between the civic core and the historic district, the building site offered a unique opportunity to link between the center of government at City Hall, and the nearby growing residential population. At nearly 500,000 SF and 10 stories above grade, the new Police Administration Building responds to the department's functional needs and also offers the surrounding community much needed public open space and freely accessible amenities throughout the site.

One hour tours are scheduled to begin at 15 minute intervals from the auditorium. As many as 12 tours will be scheduled and each will be limited to a maximum of 10-12 persons at the request of LAPD. A sign-up sheet at the registration counter will be used to schedule the tours for individuals.

Best Value – Alternative Delivery Methods

Friday, November 4, 2011
1:45 – 3:15 PM | CR

This session will focus on two unique alternative delivery methods for civic projects:

First, the California AOC's first Design Assist project, a court-set renovation in Fairfield, CA. The project included new accessible courtrooms, holding, chambers, and support space in an existing building with a variety of unknowns.

Second, a Best Value, Design-Build Competition for a central utility plant, designed for California's DGS, located in downtown Sacramento. The delivery method allowed flexibility that eventually allowed the DGS-Central Plant Renovation to become a replacement project, resulting in one of the most efficient plants in the country, recently certified LEED Platinum.

This panel discussion will examine these alternate delivery methods and outcomes with input from the architect, contractor and owner, reviewing their impact on the poetic and pragmatic.

Speakers

Lorenzo Lopez, AIA, LEED AP (moderator)
Eric Fadness, AIA
Joel Griffith
Project Director III, California Department of General Services
Paul Lindsteadt
Principal, Bullard Construction
Andrew McPherson, AIA, LEED AP
Rick Milletello
Area General Manager, Skanska
Rob Uvalle
Senior Project Manager, California Administrative Office of the Courts

TRACK CHAIR: Kyle Yardley, AIA, LEED AP

SPEAKER BIOGRAPHIES

James Aguilar, AIA Stantec Architecture

James Aguilar has over 21 years of experience in the programming, design and construction of various forensic science facilities throughout North America. His daily involvement in the design and construction of crime laboratories and medical examiner facilities has resulted in a wealth of knowledge in the design of these complex projects.

J. Brandon Anderson, AIA, LEED® AP Roth Sheppard Architects

J. Brandon Anderson is an Architect with Roth Sheppard Architects in Denver, Colorado. Mr. Anderson has provided his expertise in programming and design for public safety facilities such as LAPD Police Administration Facility, Colorado Bureau of Investigations Headquarters and multiple law enforcement facilities across the nation.

Mr. Anderson's ability to listen, understand and collaboratively integrate the needs of clients stems from his personal objective to serve those directly and indirectly impacted by his projects and profession. It is this objective that has provided his clients with award-winning facilities that improve the communities they serve. His varied portfolio of public and private projects range from the Lance Armstrong Foundation Headquarters, listed on the 2011 AIA/COTE top ten list to the LAPD Police Administration Facility. Mr. Anderson's latest design of the Windsor Police Station provides a sustainable approach to law enforcement using an iconic form with contextual responses to adjacent buildings.

Fred Basch, AIA Fred Basch Architect

Fred Basch is the principal of Fred Basch Architect. He is currently serving as a consultant to the New York City Department of Design and Construction and the NYPD for the renovation of the Central Park Police Precinct. Mr. Basch was the Project Manager and designer of the Central Park Police Station project for Karlsberger Architecture P.C. until they closed their doors at the end of June, 2011. He has been involved in the project since its inception in 2001. Mr. Basch has a long history of delivering successful projects to the NYPD and NYC Department of Design and Construction. His extensive

knowledge and experience with renovating theatres and criminal justice facilities made him the perfect fit for this restoration project. He has led the design efforts for many award-winning projects including the American Airlines Theatre Renovation, the Harold and Miriam Steinberg Center for Theatre and this precinct renovation.

Rebecca L. Binder, FAIA R. L. Binder FAIA Architects, LLP

Rebecca Binder, FAIA, (NCARB certified) has lectured on architectural programming and design for over three decades and has received local, regional and national design awards. Her work has been exhibited nationally and internationally and includes numerous program types, including a 70,000 square foot courthouse for the Judicial Council of California, Administrative Office of the Courts.

Tom Bonner Office of Criminal Justice Coordinator, City of New York

Tom Bonner is the Executive Director of Operations for the Office of the Criminal Justice Coordinator, a part of the Office of the City of New York. In that role, Tom is responsible for managing renovation and rehabilitation projects in New York City's court facilities. Tom monitors over \$500 million in capital budget funding for court facility projects, facilitates resolution of court stakeholder issues, manages construction projects, and interfaces the City's Office of Management and Budget (OMB) to secure budget funds for planned court needs. Prior to working in the Mayor's Office, Tom administered agency capital and expense budgets for OMB. Tom earned a Masters degree in Urban Planning in 2005.

Hon. Celeste F. Bremer US Magistrate, Southern District of Iowa

U. S. Magistrate Judge Celeste F. Bremer is liaison with GSA for court construction projects in the Southern District of Iowa. A member of the U. S. Judicial Conference Space & Facilities Committee, she teaches at the Federal Judicial Center, trains mediators nationally and internationally, and teaches Organizational Leadership at Drake University.

Dr. Eric Buel

Dr. Eric Buel has over 30 years of forensic laboratory experience. As a past laboratory director of the State of Vermont Forensic Laboratory and scientist, Dr. Buel has worked or supervised in the areas of drug analysis, serology, DNA analysis, trace evidence, fingerprints, and firearms. He is a past board member of the American Society of Crime Laboratory Directors and has extensive knowledge of the current trends in forensic science. Dr. Buel recently participated in the design and construction process for the new Vermont Public Safety Forensic Laboratory in Waterbury, Vermont.

Hon. Tani G. Cantil-Sakauye Chief Justice Of California

Chief Justice Tani Gorre Cantil-Sakauye was appointed to the California Supreme Court by Governor Arnold Schwarzenegger. Following her confirmation hearing and statewide election, she was sworn into office on January 3, 2011 as the first Asian-Filipina-American and the second woman to serve as Chief Justice of California. She chairs the Judicial Council of California, the administrative policymaking body of state courts, and the Commission on Judicial Appointments. Chief Justice Cantil-Sakauye served for more than 20 years on California appellate and trial courts before her appointment to the California Supreme Court. She received her B.A., with honors, from the University of California at Davis, in 1980 and her J.D. from U.C. Davis, School of Law, in 1984.

Hon. Mark A. Cope Superior Court of California, County of Riverside

Judge Mark A. Cope is the Assistant Presiding Judge in the Superior Court of California, County of Riverside and recently served on a design panel which included AOC Office of Court Construction and Management, design professionals and Advisory Group members engaged in court construction projects. He is instrumental in shaping Riverside County's next century of court facilities.

Mike Courtney Vanir Construction Management

Mike Courtney has almost 30 years' experience in developing and building facilities. He has a Bachelors of Science degree in Industrial Construction Management and has managed all phases of proj-



ect delivery. As a recipient of DBIA Distinguished Leadership Award, the California Association of General Contractors S.I.R. Achievement Award, and the WCCC Distinguished Service Award, Mike's expertise is comprised of budgeting, entitlements, pre-construction, design, construction administration, real estate development, financing, and building operations.

Prior to joining the private sector, Mike spent 17 years with the State of California in a variety of positions, including serving three years as a governor's appointee in the capacity of the Deputy Director for the Department of General Services Real Estate Services Division. While with the State, he played an integral role in the development of the State's design-build procurement laws and contracts.

In addition to presentations made to the California State Legislature, the California Association of General Contractors, the Design/Build Institute of America, and the Construction Management Association of America, he also chaired a workshop on the State's Design/Build Program at the AIA's National Conference.

Mike's project experience includes more than four million square feet comprised variously of public safety, healthcare, and research facilities.

**Tamara Dinsmore, AIA, LEED AP
SOM**

Tamara travelled around the globe with Skidmore, Owings & Merrill (SOM) prior to joining the San Francisco office where she immediately began working on the award-winning renovation of the 9th Circuit U.S. Court of Appeals. Today, Tamara is overseeing the interior design of four new California courthouses including the new Modesto Courthouse, the San Bernardino Justice Center, the new Ukiah Courthouse, and the new San Diego Courthouse. In addition to her experience with the Administrative Office of the Courts, Tamara has undertaken a wide range of interior design projects including corporate headquarters, as well as commercial, institutional, and hospitality facilities.

**Tom Donaghy, AIA
AECOM**

Tom Donaghy, AIA, LEED AP is an Associate Principal and architectural design leader for AECOM's National Capital Office. Mr. Donaghy has over 17

years of experience with emphasis on architectural design and planning. Mr. Donaghy has championed the pursuit of complex, high-profile urban projects, bolstering AECOM's reputation for designing distinctive buildings with sensitivity to time and place. He provides architectural leadership, focus, and direction, fostering a commitment to design excellence throughout the project team.

Mr. Donaghy's justice projects have been published in the AIA, National Center for State Courts, leading justice magazines, and World Architecture News. His projects have won numerous awards and he's taken his time to critique at local Universities to the DC area.

**Michael Duncan, AIA
SOM**

As a Design Director in the San Francisco office of Skidmore, Owings & Merrill (SOM), Michael Duncan has extensive experience in the design of complex projects including major civic, retail, residential, corporate, and academic buildings throughout the world. He is currently the designer for the new Modesto County Courthouse and the new San Bernardino Justice Center. These important new facilities will provide flexible, modern, and sustainable centers for justice that will meet the needs of the Superior Court for future generations. Michael received a Bachelor of Science in engineering from Stanford University and a Master of Architecture from Harvard University's Graduate School of Design.

**Hon. Douglas M. Elwell
Presiding Judge, Superior Court of San
Bernardino County**

The Hon. Douglas M. Elwell is completing his thirty-fourth year in the legal profession, during the last sixteen of which he has served as a judge in San Bernardino County, California. His judicial career has been capped these last two years by his tenure as the Presiding Judge of the Superior Court of San Bernardino County. Over the past four years, Judge Elwell has been intimately involved in the planning of a stunning new courthouse which will soon begin construction in downtown San Bernardino. This high-rise thirty-six courtroom courthouse will in many respects serve as one of the primary models for

new courthouse construction throughout the state of California.

**David Evans, AIA
Gould Evans Associates**

David Evans is a founding Principal of Gould Evans Associates and brings over 35 years of experience designing and managing public projects. David is the Principal-in-Charge and Design Principal of the Maricopa County Court Tower. In addition to being the firm's spoke person for this important project, he has made numerous public presentations and participated in numerous educational seminars and panels. David has served as Chair of the Lawrence, KS Chamber of Commerce, on the Board of the Kansas University Alumni Association, on the Board of the KU Natural History Museum and on the advisory Board of the KU School of Architecture.

**Eric Fadness, AIA
Nacht & Lewis Architects**

Eric is a principle with Nacht & Lewis Architects, focusing on justice facilities for 20 years. Eric has acted as Project Manager or Project Architect on several courthouse projects, including the Robert Matsui Federal Courthouse in Sacramento, California, the Superior Court of California, Merced, and the Superior Court of Solano, Fairfield.

**Jay Farbstein, PhD, FAIA
Jay Farbstein & Associates, Inc.**

Jay Farbstein, PhD, FAIA (also a member of NACM) has provided planning and programming for court facilities for 30+ years and lectures widely. Some recent engagements include presenting the Red Hook Community Court to the California AOC's consultant convocations and moderating an all day session on Neuroscience Applications to Courthouse Design following the AAJ's annual conference in Brooklyn. He recently addressed the annual NACM conference in Las Vegas. He is currently the court planner on about a dozen AOC projects.

**Melissa Farling, AIA, LEED AP
Jones Studio**

Melissa Farling, AIA, LEED AP is a Project & Research Director at Jones Studio who is actively investigating the affects of architecture

SPEAKER BIOGRAPHIES

on behavior. She is Vice-Chair for the National AIA's Academy of Justice for Architecture (AAJ) Research Committee, serves as a member on the AAJ Sustainable Justice Committee, and is a Research Associate for the Academy of Neuroscience for Architecture. Her more than twenty years of experience has focused on the design and project management of criminal justice facilities and large-scale public projects.

Ms. Farling has led or been part of many sustainable projects including Arizona's first LEED Platinum project, Arizona State University Bidesign Institute (while with Gould Evans). She is currently working on two other LEED Platinum projects, the Mariposa Land Port of Entry in Nogales, Arizona and a new Jones Studio office – also working towards "Living" certification.

Ms. Farling is a registered architect in Arizona and holds a Bachelor's degree in Architecture from the University of North Carolina at Charlotte, and Bachelor of Architecture and Master of Architecture degrees from the University of Arizona. Melissa gives frequent presentations on evidence-based design applications in justice projects. She is one of the principal investigators on a National Institute of Corrections funded study to examine the impacts of views of nature on stress in a jail intake area.

Kerry Feeney, BES, B.Arch, MAA, LEED®AP

Ms. Feeney is the Project Architect for the New Women's Correctional Centre in Headingly, Manitoba. Her professional area of interest is institutional building, with a specific focus on high security and correctional facilities. Her recent experience includes the East District Police Station and the Treaty Three Police Service Building, Kenora, ON.

Robert Fisch, AICP, LEED AP RicciGreene Associates

Rob Fisch is a Principal at New York City-based Ricci Greene Associates, Architects and Planners, where he leads the planning, programming and pre-design work for many of the firm's major courthouse projects. Over the past 22 years, Mr. Fisch has served as a consultant to judges, county executives, mayors and legislators on courts projects of all jurisdiction levels throughout the country. He develops facility master plans, feasibility studies, and strategic operational plans, and he lectures frequently on courthouse planning and design issues. Mr. Fisch, a graduate

of SUNY Buffalo Environmental Design program, is a member of the American Institute of Certified Planners and is LEED accredited.

S. Pearl Freeman, AIA California Administrative Office of the Courts Office of Court Construction and Management

S. Pearl Freeman is a Senior Project Manager and a licensed architect in the State of California who holds a Master of Architecture degree from Washington University in St. Louis and a Bachelor of Arts degree from the State University of New York at Buffalo. At the AOC, Pearl has been project manager for significant new courthouses, currently responsible for over \$800M of project cost. She is considered a leader in the development of the capital program's project management procedures and sustainable design focus.

Christopher Gembinski Building Conservation Associates, Inc.

Mr. Gembinski has been with Building Conservation Associates, Inc. since 1998. Through his work on numerous large-scale historic preservation projects, including the Metropolitan Life Insurance Home Office, Grand Central Terminal, Moynihan Station, and Central Park Police Precinct, Mr. Gembinski is versed in a wide range of restoration design and material treatments for historic buildings, and as an experienced conservator, he has performed laboratory analyses to characterize a variety of historic architectural materials. Mr. Gembinski also worked as the Superintendent and Project Manager for the restoration of Washington Square Arch under Archa Technology, Ltd., a restoration contractor that is BCA's sister company. Mr. Gembinski is a graduate of the University of New Hampshire and received an MS in Preservation from the University of Pennsylvania.

Timothy A. Gibson, AIA, LEED AP (moderator)

Tim Gibson has spent the majority of his architectural career specializing in Justice, Correctional and Government facilities. He has been directly involved with the design of Adult Correctional Facilities (over 10,000 beds), Juvenile Detention Facilities, Courthouses, Administration Buildings, Law Enforcement Facilities and Juvenile Boot Camps.

Specializing in the Justice, Correctional and Government architectural sector has allowed Tim to have a unique understanding of the operational needs for these specific project types. Tim's experience and unique knowledge of all aspects of judicial design is

a direct benefit to each of his clients.

He is the current project manager of the Bledsoe County Correctional Complex, one of the largest construction projects underway in the State of Tennessee. His role has been the overall management of the design team and the direct interface with the TN department of Finance and Administration, the Construction management team, and onsite representatives.

William H. (Buddy) Golson, Jr. AIA, NCARB Rosser International, Inc.

William H. (Buddy) Golson, Jr. AIA, NCARB is a Principle, board member and Vice President of Rosser International, Inc., Atlanta, Georgia. He is the director of Rosser's criminal justice planning and design division. He has over 35 years experience in the planning and design of criminal justice facilities in the United States, Puerto Rico, the Virgin Islands and Canada. Mr. Golson's projects in this building type total more than 3 billion dollars. He is a member of the American Correctional Association, the Juvenile Justice Association and the Justice Design Committee for the American Correctional Association. His experience in the Design Build delivery of criminal justice projects is exceptional. He has provided services as the Bridging Documents designer as well as the Architect of Record for the Design Build entity. Mr. Golson's projects in this delivery method exceed \$950 million.

Jeff Goodale HOK

Jeff Goodale is a Senior Vice President and HOK's firmwide Justice Director. He has been active in the justice industry for over twenty years, and has planned, programmed, designed and built facilities across the country from Washington and California, to Illinois and Texas, to North Carolina and Florida. A recognized leader in the business, he has delivered talks and written several articles on justice and project delivery issues over the years, as well as being involved with collaborations on a book and documentary dealing with justice issues and human rights.

In addition to the justice practice, Jeff has been dedicated to understanding and adapting to trends in the architecture and construction business. With a background in construction as well as architecture, he is aware of the linkage that exists between these disciplines, and the rapidly changing place of architecture in the market.

Along with traditional delivery, he is involved in understanding and applying best practices in design/build, public private partnerships, IDIQ and project development.

**Ray D. Greco, FAIA
AECOM**

Ray Greco is nationally recognized for his achievements in the specialized area of courts design. Ray is a GSA Design Excellence Program National Peer, College of Fellows Regional Representative, past AAJ conference Courts Track Chair, and an AAJ Sustainable Justice committee member developing Sustainable Justice 2030: Green Guide to Justice.

**Frank J. Greene, FAIA
RicciGreene Associates**

A leading designer of justice facilities and principal at RicciGreene Associates, Frank is committed to the application of sustainable principles to the buildings and systems that his firm plans and designs. He is past chair of the Academy of Architecture for Justice Advisory group, original member of the NY Chapter AAJ, and founder of the Sustainable Justice committee. He is a frequent speaker at justice conferences, a writer on key justice issues, and has received numerous awards for his design work. He is editor of Sustainable Justice 2030: Green Guide to Justice.

**Joel Griffith
Project Director III, California Department
of General Services**

Joel Griffith received a BA in Architecture and a BS in Building Construction Management from the University of Washington in 1987. After graduation, he worked for a General Contractor and was the Project Manager on a variety of Federal, State, County and School District projects. Since 2000, Mr. Griffith has been a Project Director with the State of California, Department of General Services, Real Estate Services Division, Project Management Branch; and has had the privilege of working on two of the State's large design-build projects, The Capital Area East End Office Complex and The Central Plant Renovation Project. Mr. Griffith is currently working as the Program Manager for the California Highway Patrol and supervising a variety of projects for the Department of Motor Vehicles, Cal Fire, DGS and the Board of Equalization.

**Jose O. Guillen
Court Executive Officer, Superior Court of
Sonoma County**

José Octavio Guillén is the Court Executive Officer for the Superior Court of Sonoma County, California and has more than 30 years experience with trial courts and court administration. He started his court career in the Superior Court of Los Angeles County in 1975. He later served as Executive Officer for the Superior Courts of Napa, Riverside, and Imperial Counties and as Trial Court Services Director for the Administrative Office of the Courts in California. In addition to this varied trial court experience, Mr. Guillén has shared his expertise in various international justice reform projects since 1992, including those under the auspices of the U.S. Agency for International Development in many South American countries and Afghanistan. He has also served on various California Judicial Council Advisory Committees and on the Board of Directors of the National Association for Court Management.

Frank Guzzo

Frank Guzzo has served as Union County's Director of the Department of Human Services since 1990. He leads the largest government service unit with a staff of 740 and a budget in excess of \$71 million. Mr. Guzzo's responsibilities include the oversight and management of Union County's Juvenile Detention Center. The original Juvenile Detention Center was housed above a six story parking garage in Elizabeth, NJ. Designed in 1968 with a capacity of 34 beds, the facility was chronically overcrowded with as many as 90 youth. The facility's age, configuration, and crowding resulted in operational and program deficiencies. Despite reported deficiencies and criticism by the New Jersey Juvenile Justice Commission, there was reluctance on the part of elected officials to spend limited resources on a new facility. Two separate Freeholder Boards were challenged to address the need for a new detention center, and two attempts to construct a new juvenile detention center failed.

Beginning in 2002, Mr. Guzzo directed a Needs Assessment to keep up the pressure to build a new facility while identifying detention alternatives to ease overcrowding. A critical incident in 2003 convinced the Board to act on the need to build a new Juvenile Detention Center - presenting an opportunity to improve not only the facility, but also the entire operational system to better serve the juvenile population. The projected capacity was reduced by almost 20% based on system

improvements, and the facility was designed to promote positive youth development through programs and meaningful connections with staff, community, and family.

Eric Hackman, AIA LEED AP

Eric is a Project Manager for Tower Pinkster in Kalamazoo, Michigan. He has 16 years of experience and has been focused on justice facilities in Michigan since 2007. Selected past projects include the Kalamazoo District Courts, Midland County Jail, Maxey Boys Training School (Michigan Department of Human Services) and Washtenaw County Justice Project. The Michigan economy has been severely hit with decade long recession tendencies; pinched for operational funding, like most municipal agencies across the nation, each client proposes projects which are underfunded and in near desperate need to implemented. Eric brings a unique perspective and a creative approach to facilitate designs that meet demanding budgets and deliver the programmatic requirements.

Joe Haines

Joe Haines specializes in justice facility project development, management and design. Since 1976, he has had varying degrees of involvement in over 250 criminal justice-related planning, development, finance, design and construction projects. He is been involved in correctional architecture on a national level for the majority of his career and served as a sub-committee chairperson of the American Institute of Architects Committee on Architecture for Justice (AIA/CAJ), is a member of the National Institute of Corrections Task Force on Prison Construction Standardization & Techniques, and served as a board member for the Nebraska Jail Standards Board from 1995 to 2000.

Joe's experience spans the U.S. from coast to coast and in foreign countries. His work includes city, county, state and federal government clients and private corrections operators. His criminal justice planning and design experience includes juvenile facilities, county detention facilities, state correctional facilities, police and law enforcement facilities, federal government facilities, special needs facilities and private correctional facility design-build-finance developments.

**Rod Higgins, CASp, DSA
Senior Architect, California Division of the
State Architect**

Mr. Higgins received his Bachelor of Architecture

SPEAKER BIOGRAPHIES

from the California Polytechnic State University, San Luis Obispo in 1974. As a licensed architect since 1979, Rod has provided services in a wide range of projects which includes religious, residential, retail/commercial institutional and educational scope. He became personally involved with various issues of access barriers while helping to provide care for a disabled family member from 1980-1991. The experience left him with a drive to become more involved in the process of advocating accessible architecture. The last 10 years of his career as Principal Architect in his private practice was primarily focused on access-surveying, consulting and design. In 2000 he decided to join the "other side" and came to work for the Division of the State Architect at the San Diego Regional office as an access plan-reviewer and intake specialist. In 2002 he left San Diego and moved to DSA Headquarters in Sacramento to work as Senior Architect (Supervisor) on development of Statewide Access Training and Quality Assurance programs mandated by SB 1242 – Ortiz (Building standards: tactile signage), along with being Project Director of Certified Access Specialist (CASp) Program developed for implementation mid 2008, under mandate from SB 262 – Kuehl (Buildings: access; enforcement). In October 2007 he relocated to the Sacramento Regional Office of DSA to take on the present-day duties of Senior Architect, Access Compliance Section Team Lead, and Certified Access Specialist. In 2008 he was asked to be the primary access plan-reviewer for all CA courthouse projects being developed under the jurisdiction of the Administrative Office of the Courts and, since then, has reviewed approximately 29 courthouse related projects.

Julia Hughes, AIA, LEED AP BD+C HMC + Beverly Prior Architects

Ms. Hughes currently chairs the AIA Academy of Architects for Justice Sustainable Justice committee and was instrumental in developing the "Sustainable Justice 2030: Green Guide for Justice" white paper. Julia's focus on justice architecture over the past 16 years has included award-winning courthouse and detention/corrections facilities on the east and west coasts and various communities in-between. Particularly noteworthy is the recent World Architecture News Effectiveness award of the Union County Juvenile Detention Center (done while with Laura Maiello while at RicciGreene Associates) - "aiming to find the best in architectural design that has profoundly impacted society, transcending the requirements of the client brief and aesthetic appeal... (that) benefited its users, the surrounding community and beyond."

David J. Insinga, AIA General Services Administration

David Insinga is the Director for the Rocky Mountain and Pacific Zone in the Office of Design and Construction at the General Services Administration in Washington, DC. His work focuses on the planning, design and construction of federal courthouses, land ports of entries and federal office buildings.

Ken Jandura, AIA AECOM

Kenneth J. Jandura, AIA is a principal and justice market sector leader for AECOM's National Capital Office. Mr. Jandura has over 24 years experience in the field of justice planning and design and is responsible for the pursuit and quality performance of studies, planning and design for court facilities worldwide.

In addition to his project experience, Mr. Jandura was a co-presenter at the 2009 AIA Design DC Conference, "Bringing New Life of Old Buildings." He was a co-chair and presenter at the 2007 AIA Justice Conference, "Breaking New Ground in Justice: innovations in Design, Construction, and Operations." He has served as an adjunct faculty member for the Institute for Court Management where he conducted a seminar on "Building a Better Courthouse" in April 2003 in Denver, Colorado. Furthermore, Mr. Jandura has written articles for leading justice magazines, and wrote a chapter on courthouse security for Building Security: Handbook for Architectural Planning and Design published by McGraw Hill in 2004.

James R. Kachik

James Kachik is a Deputy Director of the General Services Agency of the County of Alameda. He leads the award-winning Technical Services Department (TSD) of the GSA and its staff of 38. TSD has management responsibility for five County-wide program areas: Capital Project Design and Construction Management; Energy Program Management; Environmental Project Management; the County's Sustainability Program, and the Medical Facilities Development Program.

TSD's Capital Project portfolio currently totals approximately \$1.2 billion in approved projects, including the \$682 million Highland Hospital Acute Tower Replacement project. TSD's portfolio of Design Build projects includes the County's first LEED Gold Juvenile Justice facility; the Highland Project, a new Courthouse and others totaling approximately \$950 million. TSD also leads the

County's nationally-recognized, multiple award winning Energy program; and the County's leading-edge Sustainability program.

Kachik is an Architect licensed in California since 1974. He has been with the County since 1997. Prior to being with the County he worked in the private sector for about 25 years, during which time he managed and directed projects totaling more than 1,000,000 square feet for government agencies, private developers, institutional and residential clients. He has also led research projects in treatment facilities for autistic children, the transfer of architectural technology from the NASA space program, and the influence of building technology research on building codes.

The dynamics of delivering projects within the statutory constraints of the Public Sector can provide useful lessons in project management and delivery methodology. Mr. Kachik's experience in the use of the bridging Design/Build method of Integrated Project Delivery (IPD) provides insights into the important role of the Public Sector Owner in successful capital project delivery collaboration.

Sam Kaplan NAVFAC SW

Samuel Kaplan served as NAVFAC's design manager for the 200 bed addition to the Miramar Brig (Consolidated Naval Brig). Prior to the Design/Build phase of the project, he served as design manager overseeing the bridging architect develop the bridging documents that ultimately formed the basis for the Design/Build contract. During performance of the Design/Build contract he served as the Design/Build team's primary liaison with the Brig management and the bridging architect. At NAVFAC since 2008, he has served as design manager or project manager with responsibility for developing RFPs, many of them for Design/Build projects ranging in contract value from \$15,000,000 to \$68,000,000. He has been a licensed architect since 1978 and a licensed contractor since 1980. He has received several awards including internal NAVFAC recognition and a Merit Award from the San Diego chapter of the AIA.

Kevin Kampschroer General Services Administration, High Performance Green Building

Kevin Kampschroer is the Director of the Office of Federal High-Performance Green Buildings at the U.S. General Services Administration (GSA). He has created the framework for which

GSA responds to the challenges of greenhouse gas emissions reductions and of the American Recovery and Reinvestment Act's mandate to move GSA's Federal building inventory toward high-performance green buildings.

Mr. Kampschroer was the Project Manager for the Ronald Reagan Building & International Trade Center, and he has lectured at various universities such as MIT, Harvard and Yale. His most recent publication as a contributing author is the first medical study showing the link between building characteristics on office worker stress and heart function-which showed the beneficial results of good lighting, natural light and IEQ. He has worked for GSA for over 35 years and is a graduate of Yale University.

Tom Kyle, OAA, MRAIC, LEED AP

Tom Kyle is a Senior Associate of Stantec Architecture's Toronto design studio. He graduated from the University of Toronto's School of Architecture and Landscape Design in 1993. Since graduation, Tom has developed expertise in building types for a diverse range public sector clients, ranging from high-security, law-enforcement, laboratory, healthcare, post-secondary, tourism, and other public agencies. Tom applies his knowledge of architecture to all scales of design, ranging from urban design guidelines to integrated building science solutions to furniture detailing.

Tom's approach to law enforcement facilities is based on strengthening links between officers, their colleagues, and the communities they serve. His ability to encourage dialogue between community leadership and law-enforcement leadership has led to some truly inspirational and award-winning projects.

Margo Lee

Ms. Lee is the Superintendent of the Portage Correctional Centre for Women in Manitoba. She is the Project Manager representing Manitoba Justice on the design and construction of the new Women's Correctional Centre.

Michael LeBoeuf, FAIA

Michael LeBoeuf has practiced for more than 30 years, with the majority of his career focused on the design of large urban governmental buildings in the United States; projects that represent substantial investments by our society to create buildings that define the urban core of our cities.

Some of his signature projects include the New Castle County (DE) Courthouse, Pueblo County (CO) Courthouse, and the Orange County (FL) Courthouse Complex in his home city of Orlando.

Michael's work has contributed to the evolution of the modern courthouse through design that has enhanced building efficiency and transformed courtroom design and court operations through design excellence. He has served as the lead designer on twelve major courthouses compiled to be over 550 courtrooms and over 8,000,000 square feet of courthouse facilities around the United States.

Paul Lindsteadt Principal, Bullard Construction

Paul Lindsteadt is a principle and secretary for Bullard Construction in Sacramento. Bullard Construction specializes in design-build construction.

Lorenzo Lopez, AIA, LEED AP Nacht & Lewis Architects

Lorenzo Lopez is a Vice President with Nacht & Lewis Architects in Sacramento, CA. He has worked on a variety of justice projects, including courthouses, jails, and prison facilities for 18 years focusing on planning, code compliance, and sustainability. He has also been heavily involved in both local and national components of the Academy of Architecture for Justice, working to facilitate best practices among his peers and clients regarding planning, design, constructability, and code conformance for justice facilities.

Lorenzo was recently made co-chair of the I-3 Occupancy Task Force in California, which has been charged with evaluating the current California Code of Regulations, Title 24 - California Building Code relative to jails, prison, and holding areas within courtrooms. Lorenzo has also worked closely with senior staff at California's Division of the State Architect, the entity charged with enforcing access compliance, on a session designed to inform architects about specific access requirements for justice facilities.

This year, Lorenzo is the chair of the National Conference.

Marayca Lopez, PhD Associate, RicciGreene Associates

Marayca López is a corrections analyst and planner for RicciGreene Associates with an extensive education and background in criminal

justice policy and practice. With a PhD in Law and two Master's Degrees in Criminal Justice and Sanctioning Implementation respectively, Marayca López has extensive academic and field experience in the criminal justice arena, having conducted several studies on correctional issues worldwide. She speaks at national venues and presently serves as the detention facility track chair for the AIA Academy of Architecture for Justice National Conference.

She has particular experience in the development of jail facility needs assessments, inmate population analysis and projections, alternatives to incarceration, operational and architectural space programs, and strategic planning options for correctional jurisdictions at the state, county and municipal levels of government. Dr. López is a member of the Visiting Committee for the Correctional Association of New York and collaborates in conducting research on several topics about prison life: violence and abuse inside prisons; levels of substance abuse; barriers/challenges that inmates face after release; conditions of confinement for women offenders, just to name a few. Recently Dr. Lopez has an invited book review of the British acclaimed book "The effects of Imprisonment" published in Contemporary Justice Review.

Dr. López is highly regarded as an authority on latest trends in juvenile corrections philosophy and best practices in juvenile correctional facility planning, programming and design. She has helped the States of Washington, New Mexico and Massachusetts transform their juvenile corrections systems according to the principles of the Missouri Model of Juvenile Corrections, a nationally recognized approach for dealing with youth offenders, which is nationally recognized as a "A guiding light for reform" (American Youth Policy Forum). Most recently she has participated on a panel with New York State and City Commissioners on "Transforming Youth Corrections in New York: A New Vision", sponsored by the NY AIA Chapter.

Laura Maiello RicciGreene Associates

Laura Maiello is an Associate Principal for Ricci Greene Associates. She has been with the firm for over 25 years. Her correctional facility expertise has assisted many jurisdictions planning for new facilities by developing with the Client a philosophical mission, systems framework and operational context for facility planning and design. Her policy and planning recommendations to governmental decision-makers and clients have resulted in

SPEAKER BIOGRAPHIES

improved juvenile justice systems, programs and facilities at both state and local levels.

Ms. Maiello has presented on a variety of detention and justice facility policy and planning topics nationally at venues such as the National Council of Juvenile and Family Court Judges Juvenile Justice Conference, the National Juvenile Detention and Correctional Associations' Joint Conference on Juvenile Detention and Correctional Services, the American Jail Association, and the University of Wisconsin, Department of Engineering's Professional Development Program on Facility Planning and Design. She is a member of the American Correctional Association, the National Partnership for Juvenile Justice, and the National Council of Juvenile and Family Court Judges where she is a member of the Juvenile and Family Law Advisory Committee. She has served on the Juvenile Justice subcommittee on Juvenile Justice for the American Correctional Association and is co-author of "Juvenile Housing," in Planning and Design Guide for Secure Adult and Juvenile Facilities, American Correctional Association, 1999. Ms. Maiello earned a Bachelor of Social Work degree at Kean University of New Jersey and a Master's Degree in Criminal Justice from Rutgers University.

Jack Martin, AIA, LEED AP

H3 Hardy Collaboration Architecture

A Partner at H3 Hardy Collaboration Architecture, Jack Martin has an unparalleled dedication to solving complicated design and pragmatic challenges. He has over thirty years of experience and has managed a wide variety of complex building projects, including civic, performing arts, and educational facilities. Recent highlights of his portfolio include the U.S. Customs and Immigration Center at Rainbow Bridge, Niagara Falls, NY; the United States Courthouse, Jackson, MS; the Cowin Center Renovation at Teachers College, Columbia University, New York, NY; the National Baseball Hall of Fame and Museum Renovation and Expansion, Cooperstown, NY; and the Adaptive Reuse of Pier A in Lower Manhattan.

Patrick McGrath, CFM

California Administrative Office of the Courts Office of Court Construction and Management

Patrick McGrath, CFM joined the Administrative Office of the Court in September 2008. Patrick began his career in the construction industry in 1984. From building apartment and commercial facilities he progressed to managing the Operations and Maintenance of large portfolios

for Franklin Templeton Investments as well as FPI and BRE Property Management Companies. His work included managing Base Operations Support Services contracts for the NASA Dryden Flight Research Center, and Fort Bliss Army Base located in Texas. In all, he has 24 years of hands-on and management experience in developing and operating Facilities Management programs. As the Acting Facility Operations Manager for the Administrative Office of the Court, his team is responsible for Facility Modifications, Engineering, Customer Service, and Budget functions.

Russell McElroy, AIA, NCARB Principal, McClaren, Wilson & Lawrie Architects

Mr. McElroy leads the Forensic Sciences / Health & Research Laboratories division of McClaren, Wilson & Lawrie. With over 20 years of experience in the programming and design of full service projects, his wide breadth of knowledge includes forensic science labs, forensic DNA labs, BSL3, BSL4 labs, police ID labs and medical examiner/coroner facilities. He also has international practice designing nanotechnology and health laboratories.

Todd McMillen

Gilbane Building Company

Todd McMillen has been the Sr. Project Executive on the Maricopa County Court Tower since late-2007 when the project began design. As Sr. Project Executive, McMillen provides on-site executive oversight to all construction activities, design-assist subcontractor coordination, safety, quality, contracting, client relations, team collaboration and architectural/design management.

Andy McPherson, AIA, LEED AP

Andy is a Vice President and Director of Design of Nacht & Lewis Architects. He has established exceptional credentials over 30 years as an award-winning architectural designer. He is particularly sensitive to the functional and aesthetic aspects of exterior and interior spaces, and has strong skills in creating projects that meet the wants and needs of civic and institutional clients. Andy has embraced sustainable design and leads the firm's efforts in providing our clients with high performance building and site solutions.

Rick Milletello

Area General Manager, Skanska

Rick Milletello, Executive Vice President for Skanska USA Building oversees Skanska's Building business in California. Rick is a 31-year Construction industry veteran and has experience in managing various types of contracts including CM, CMAR, Design-Build, Integrated Form of Agreement, Lump Sum, and General Contracts. His client list includes Alza, Genentech, The Department of General Services, HCA, Johnson & Johnson, Kaiser, Sutter and Stanford University.

Rick has a Bachelor of Science degree from Lawrence Institute of Technology in Southfield, Michigan.

Elizabeth Minnis, AIA

Acting Deputy Commissioner, Office of Planning, Design and Construction Division of Capital Asset Management Commonwealth of Massachusetts

Elizabeth Minnis oversees the Commonwealth's Capital program of planning, design and construction for Higher Education, Public Safety, Judiciary, Human Services and other executive branch agencies and state offices. The average annual investment in the state's facilities is over \$500 million and the projects range from strategic facilities and campus master planning, repairs and renovations, to major new construction.

Ms. Minnis began her architectural career after five years of professional work in the field of human services. She received a Bachelor of Architecture from the Boston Architectural College and spent nearly 10 years at a firm specializing in public architecture for both state and local government agencies. Her dedication to the challenge and value of public architecture was most significantly realized when she took on the responsibility for the planning and implementation of the program for reconstruction of the court facilities for the Massachusetts Trial Court with the Division of Capital Asset Management in 1999. Since that time she has taken on increasing responsibility in overseeing the planning, design and construction for the Commonwealth.

She is a Registered Architect in Massachusetts, a member of the Boston Society of Architects and the 2012 Chair of the Advisory Group of the AIA's Academy of Architecture for Justice Knowledge Community.

Andrew Morgan CCM

Andrew Morgan is a Certified Construction Manager (CCM) who brings more than 40 years experience in the Construction and Construction Management Industry as a Project Manager and Principal in Charge. He has a record of successes including the 1991 National Construction Management Achievement Award from CMAA for the Lassen County Adult Detention Facility; in 2005 the Pima County Jail expansion which was awarded a Kemper Goodwin Award to honor the collaborative efforts of the architect, contractor and owner and in 2008 the first detention facility in the United States to receive LEED Gold Certification (Alameda County Juvenile Justice Center) which was selected as the CMAA Northern California Project of the Year for 2008. He was appointed to the AB 900 Facilities Strike Team in 2007 by Governor Schwarzenegger to expedite implementation of the Public Safety and Offender Rehabilitation Services Act of 2007 where he served as Senior Consultant to the Chief Deputy Secretary of Facility Planning, Construction and Management of the California Department of Corrections and Rehabilitation. In 2008 Mr. Morgan received the Circle of Service Award from the California State Association of Counties for his professional work in support of California Counties.

James W. Mueller

Jim has been employed at KMD for 25 years, is a Principal of the firm, the current Chairman of the Board and since 1990 has served in the role of Executive Director of KMD Justice (KMDJ), a subdivision of KMD. In this capacity, Jim has overseen the professional services provided by KMDJ on over 350 justice related projects which have included detention, corrections and courts facilities for both juvenile and adult/male and female populations, as well as law enforcement, forensic, coroner, and secured healthcare/mental health/special needs facilities. Jim has lead seminars, moderated workshops and made presentations on facility design and project delivery at the national conventions of the American Jail Association (AJA), the American Correctional Association (ACA), the National Commission on Correctional Health Care (NCCCHC), the National Council of Juvenile and Family Court Judges, and at the annual conventions of the International Corrections and Prisons Association (ICPA) in Beijing, China, Vancouver, British Columbia and Bridgetown, Barbados. He has authored several articles in justice industry periodicals, including "Evidence Based Design in Correctional Mental Health Facilities," which appeared in the August 2008 edition of Corrections News to which he was appointed a Contributing Editor.

Michael Moxam, OAA, FRAIC, LEED AP, Int.**Assoc AIA****Vice President, Stantec Architecture**

Michael is committed to excellence in all aspects of the design process, his 26 years of experience in the design and development of complex project types can be characterized by a commitment to design excellence, an emphasis on collaboration and a desire to redefine the "type".

**Susan Oldroyd, FAIA, LEED AP
AECOM**

Susan Oldroyd, a justice principal at AECOM, has planned, programmed and designed a wide variety of regional and federal courts projects. She received AIA fellowship in 2009 for her expertise in courthouse architecture. She has written articles published in professional publications including Architectural Record and the AIA/AAJ Journal. Susan has spoken on sustainability and justice topics at AIA national conventions including "Sustainable Justice: Designing a Green System" (2010), and Sustainable Justice: An Evolving System (2011). She was the founding chair of the AIA Architecture of Academy for Justice (AAJ) Sustainability Committee in 2007, and is a past chair of the AIA-AAJ Bay Area.

Hamid Omidvar, AIA

Hamid Omidvar, AIA, Office of Special Projects. Mr. Omidvar is an architect and urban designer with experience on both private and public projects. He has been working for the Montgomery County Maryland since 1995. His office is in charge of development of large capital improvement projects. Currently he is managing two large portfolios, the Government Core Facilities, and Smart Growth Initiative for a total of approximately \$600 million dollars. His most recent design of the new Judicial Center Annex a seven story courthouse in downtown Rockville was completed in the summer of 2011.

**Chuck Oraftik, FAIA
HOK**

Mr. Oraftik has worked at HOK's San Francisco office for 34 years where he is a Senior Vice-president and Director of their justice group. For 33 of those years his career has been devoted exclusively to the practice of justice architecture. He justice experience includes 24 major courthouses as well as numerous related justice facilities.

Chuck is a nationally recognized authority on court programming, planning, design and delivery issues

and has spoken at conferences of National Association for Court Management, the Metropolitan Council of Large Courts, National Center for State Courts, the Council of Canadian Court Administrators, the Design-Build Institute and others. He has been a member of the Academy of Architecture for Justice for nearly 30 years and was a founder and first chair of the San Francisco AAJ chapter.

Barrie Ottenbreit, MAA, OAA, MAAA

Mr. Ottenbreit is a Senior Partner with years of institutional design and project leadership experience. His work includes the Women's Correctional Centre, the Nunavut Justice Centre in Iqaluit NU, The City of Winnipeg East District Police Station, the Brandon Regional Law Courts and the Brandon Regional Health Centre.

Ronald G. Overholt

Ronald G. Overholt is the Interim Administrative Director of the California Courts. He has been a leader in California's justice system for more than three decades, serving at the state and local court levels, and as a member of the Judicial Council of California, the policymaking body for the largest state court system in the nation.

**Tom Perica, AIA, LEED AP
HDR Architects**

Tom Perica has 17 years experience in architecture, 10 specializing in court planning, design and program management. As a program manager for HDR, Tom holds a key role on the owner's management team for the Maricopa County Court Tower, managing the process and products from the design professions and coordinating with the construction manager at risk. Additionally, he is an advisor to county management, proposing and defining critical capital improvement issues. Prior to moving to HDR, Tom worked for Ricci Greene Associates in New York and has extensive experience in courts programming and planning.

Alan Petrasek

Alan Petrasek joined the company in 1978 as an Assistant Superintendent and has been instrumental in the success of over \$2 billion in construction projects spanning from Washington DC to San Diego, CA. Mr. Petrasek relocated from the east coast to the Western Region in 1998 and added to his resume the Indian Wells Tennis Garden, SDSU Underground Metro Station, and the Save Mart Arena in Fresno, CA. He

SPEAKER BIOGRAPHIES

was instrumental in securing the new Ballpark for the San Diego Padres, PETCO Park, and the Manchester Grand Hyatt Expansion project. Mr. Petrasek relocated temporarily to Washington DC to manage the design/build team on the new Washington National's Ballpark. Upon its completion, he returned to manage Clark's San Diego area operations and assist in business development and the acquisition of new work. Recent local projects include the San Ysidro Land Port of Entry, the design/build Miramar Brig and the design/build UCSD Campus Housing North. He holds a Bachelor of Science degree in Civil Engineering from Rutgers University and Bachelor of Science degree in Business Administration from Monmouth University. He also holds contractor's licenses in Louisiana, West Virginia and California and is a LEED Accredited Professional.

Daria Pizzetta, AIA **H3 Hardy Collaboration Architecture**

As Partner and Project Manager at H3, she is responsible for the programming, planning and design effort for the firm's civic, library, and cultural projects. With over 25 years of experience, she provides primary management, coordinates the team's activities and is responsible for schedule, budget, costs and deliverables. Her recent work includes the United States Federal Courthouse in Jackson, Mississippi; the Brooklyn Academy of Music's Richard B. Fisher Building in New York, the Botanical Research Institute of Texas in Fort Worth; and the Maritime and Seafood Industry Museum in her hometown of Biloxi, Mississippi.

April Pottorff, AIA **RicciGreene Associates**

April Pottorff is an Associate Principal with RicciGreene Associates, an architectural design and planning firm specializing in Justice Facilities. She joined the New York-based firm in 1993 and has managed its Lexington, KY office since 1999. Her knowledge of adult and juvenile detention facilities combined with her expertise in design, planning, and synthesizing user input, enables her to design facilities that support the philosophical mission and operations unique to each project she directs. Ms. Pottorff's experience includes planning and design for Federal, State, County and Municipal courts. Recent projects include the new Franklin County Court of Common Pleas in Columbus, OH; Columbus Municipal Courts Master Plan for the City of Columbus, OH; U.S.

Courthouse in Norfolk, VA; Appellate Court Master Plan for State of South Carolina; U.S. Courthouse in Nashville, TN.

Beverly Prior, FAIA, LEED AP, NCARB **HMC + Beverly Prior Architects**

With 30 years of justice facility planning and design experience, Beverly Prior has participated in a wide range of delivery methods for these projects. Her first design-build jail project, a jail infirmary addition in 1994, was quite successful in meeting the schedule and being a zero change order project. Since then, she has worked both sides of the design-build "aisle" on projects exceeding \$100 million: developing bridging documents for the 786-bed County Jail No. 3 for San Francisco and associate architect on the design-build team for the 300-bed Alameda County Juvenile Justice Center in San Leandro, California. The recent surge in the design-build delivery method both heartens and concerns Beverly. While appreciating the benefits of teaming with the builder, she sees the huge amount of resources demanded from architects to compete on these projects as unsustainable. After 25 years leading Beverly Prior Architects, she merged the firm with HMC Architects in 2011 and is now the Justice Practice Leader of HMC + Beverly Prior Architects.

John Pulley

John Pulley leads a sustainable approach to mechanical engineer from HOK's San Francisco office. His work emphasizes a holistic approach to design that results in elevated, integrated and high performance sustainable design.

Kelly Quinn **California Administrative Office of the Courts** **Office of Court Construction and Management**

Kelly Quinn has 25 years of experience in institutional facilities planning, with an emphasis on planning for court facilities. Since 2004, Kelly has been the Senior Manager of Planning responsible for state-wide, court, and project planning for the multi-billion dollar construction program underway to correct security, safety, and functional problems in courthouses across California. Prior to joining the AOC, Kelly provided consulting services to architectural firms working on court projects in Massachusetts, Maryland, and California. Kelly began her career in Massachusetts, where she was the planning director the commonwealth's \$1 billion-plus courthouse improvement program.

Marcus W. Reinkensmeyer **Court Administrator, Judicial Branch of** **Arizona in Maricopa County**

Marcus W. Reinkensmeyer is the Court Administrator for the Judicial Branch of Arizona in Maricopa County (Phoenix). Previously, he held the posts of Superior Court Administrator, Chief Deputy Court Administrator and Director of Judicial Information Systems in Maricopa County. Prior to moving to Arizona in 1991, Marcus served as Assistant Director of the Administrative Office of the Courts and Court Administrator (17th Judicial Circuit-Illinois). Marcus is Past President of the National Association for Court Management (NACM) and the Arizona Courts Association. He serves on the Executive and Editorial Board for the International Association for Court Administration. His articles on court management have appeared in the Justice System Journal, Judicature, The Judges' Journal, The Court Manager, The Handbook on Court Management and Administration, and The Improvement of the Administration of Justice. Marcus holds a Bachelor's Degree from Michigan State University, a Master's Degree in Public Administration from Northern Illinois University and is Graduate Fellow of the Institute for Court Management. He is the recipient of the Institute for Court Management's Award of Merit (1989), the Supreme Court of Arizona's Distinguished Service Award (2003) and the Warren E. Burger Award of Excellence in Court Administration, National Center for State Courts (2009).

Gary Retel

Mr. Retel is a Senior Justice Designer in the Atlanta office of HOK and is nationally recognized for creating award winning, inventive and sustainable design solutions across a wide range of justice facilities.

Kenneth Ricci, FAIA **RicciGreen Associates**

Mr. Ricci is the Founder of Ricci Greene Associates, Architects and Planners, of NYC. He has devoted his entire career to the field of planning and design of justice facilities, for which he was elected to the College of Fellows in 1998 for his lifelong work in "improving environments for the incarcerated". He has presented numerous seminars at both AIA National Conventions, including "The Power of Project Definition" (1998); "Providing Program Management Services for the Public Owner" (2004); and a seminar on design/build in 1999; and at the AAJ conference in 2005 on the topic "Modern Jails make Good Neighbors".

Mr. Ricci has long experience in delivering training sessions for professionals. He has designed and presented seminars at the University of Wisconsin on the planning and design of modern court facilities and on the planning and design of juvenile treatment and detention facilities. He has served as a trainer for the National Institute of Corrections (NIC) on the Planning and Design of New Institutions. He was asked by NIC and the Office of Juvenile Justice and Delinquency Prevention to design a weeklong training seminar for county officials on the planning and design of modern juvenile justice facilities, and he conducted three week – long seminars annually from 1998 to 2001. He was one of the founders in 1993 of the Committee on Architecture for Justice of the New York Chapter of the AIA and served also on the NY Chapter's Board of Directors from 1999 thru 2001. He is currently serving as Treasurer of the NY Chapter AIA and co-chair of the AAJ Committee on Sustainable Design.

Mr. Ricci is known for his interactive approach to training based on the recognition that adult learning for advanced professionals has to be participatory and concrete with a high level of "take-home" value for participants.

Dave Roach Balfour Beatty Construction

With over 35 years of experience managing large government organizations and facilities, Dave Roach is currently a Senior Vice President of Construction Operations with Balfour Beatty Construction in San Diego, California. Overseeing projects with an active construction value of over \$500 million, he is responsible for budget and subcontract management as well as customer relations. He supervises over 40 personnel on hard bid, agency construction management, lease/lease back, construction management at risk, and design/build projects including the \$221 million San Diego Women's Detention Facility.

Prior to his employment with Balfour Beatty, Dave served as Deputy Director of Architecture & Engineering for San Diego County's Department of General Services where he managed an operating budget of \$1.7 million, a capital improvement budget of \$240 million, and a staff of 29 architects and administrative personnel. His responsibilities often entailed briefing projects to elected and appointed officials within county government, development leaders, and community organizations. His projects included the \$84 million Central Jail and the \$64 million Vista Courthouse.

Previous to his engagement by San Diego County, Dave was the Senior Civil Engineer for all naval stations in the Pacific theater, Director of Acquisition at NAVFAC Southwest, and a Seabee Battalion Commanding Officer.

Tom Robinson, AIA Tennessee Department of Correction

Mr. Robinson is the Director of Facilities, Planning & Construction for the Tennessee Department of Correction which supervises more than 20,000 inmates statewide. His specific expertise is in the management of programming guidelines, design phase optimization, construction management, and alternate project delivery systems for complex, multi-institutional organizations. He exhibits an extraordinary work ethic with a proven track record of managing large-scale facilities' programs working with administrative leaders of state government, the architectural and construction communities and departmental user groups/committees.

Rona G. Rothenberg, FAIA California Administrative Office of the Courts Office of Court Construction and Management

As Partner and Project Manager at H3, she is responsible for the programming, planning and design effort for the firm's civic, library, and cultural projects. With over 25 years of experience, she provides primary management, coordinates the team's activities and is responsible for schedule, budget, costs and deliverables. Her recent work includes the United States Federal Courthouse in Jackson, Mississippi; the Brooklyn Academy of Music's Richard B. Fisher Building in New York, the Botanical Research Institute of Texas in Fort Worth; and the Maritime and Seafood Industry Museum in her hometown of Biloxi, Mississippi.

Steven A. Ruether

Steven A. Ruether has over 29 years of experience in the construction industry, 23 of those years at Bell. For the past 8 years, he has served as President of The Bell Company, LLC and its subsidiaries. He has an excellent track record in Design/Build efforts in correctional projects. He has managed over \$600 million dollars in correctional facilities construction, over \$500 million of that as a Design/Build project delivery. For the FCI Berlin project, Mr. Ruether served as the Executive-in-Charge and the Federal Bureau of Prison's prime contract.

Robert W. Schwartz, AIA LEED AP

Bob has over 35 years' experience, with the last 26 dedicated to justice. As HOK Group Vice President he oversees the programming, planning and conceptual design of all types of justice facilities. His projects are innovative and include twenty-two published in the Justice Facility Review. Past committee work includes the GSA Independent Court Panel on Courthouse Cost; the Courthouse Access Advisory Committee; Chair for the Court Track at the 2009 AAJ Conference and a member of the ACA Facility Design Committee. He was also a major contributor to both additions of the National Center for State Court publication The Courthouse: A Planning and Design Guide for Court Facilities.

Laura Shadix General Services Administration

As a Senior Project Manager for the General Services Administration, Laura Shadix has presented to various GSA management conferences in the region. She also presents regularly at industry conferences, most recently at the 2010 VA Joint Engineering Conference for a presentation entitled "Building Delivery Re-Engineering Techniques that Reduce Project Schedule, Cost and Quality Risks".

Leslie Shepherd, AIA Chief Architect, Office of the Chief Architect

Les Shepherd was named Chief Architect for the U.S. General Services Administration in November 2006, after serving as Acting Chief Architect for 22 months. Prior to this position, he served as the Director of Federal Buildings and Modernization with the Office of the Chief Architect. As Chief Architect, Shepherd is the Senior Advisor to the Administrator of GSA and to the Commissioner of the Public Buildings Service (PBS) regarding federal architecture and design policy and innovation. Current design and construction work in progress consist of more than 350 projects with a value of more than \$17 billion executed by 11 GSA regional offices.

Shepherd's career with GSA has spanned almost 24 years. During this time, he has served as the Director of the Field Support Division and the Director for the Center for Architecture, Engineering and Urban Development. He has also served in GSA's regional office in San Francisco and the Los Angeles Field Office. In San Francisco, Shepherd was the project manager for the modernization of the San Francisco Federal Building and in Los Angeles, he served as the Branch Chief for Design and Construction and project manager for the Las Vegas Federal Building.

SPEAKER BIOGRAPHIES

Shepherd is a licensed architect and a LEED Accredited Professional. He is a professional member of the American Institute of Architects (AIA). In 2010, AIA selected him to receive the Thomas Jefferson Award for Public Architecture. The Thomas Jefferson Award recognizes excellence in architectural advocacy and achievement. Shepherd received his professional degree in architecture from Texas Tech University. In 2010 he received the Texas Tech Distinguished Alumni award and in 2011 he was awarded the Texas Tech Architecture Distinguished Alumni Award.

Kristin Sidoryk, BID, BA, PIDIM, NCIDQ, LEED AP

Kristin Sidoryk is a senior Interior Designer with a Bachelor of Arts degree in Criminology. She is interested in the application of psychology and design to improve the personal experience in corrections and health care facilities. Recent project experience includes the Women's Correctional Centre and Milner Ridge Correctional Centre.

Kelly W. Smith, AIA, LEED® AP

Kelly Smith has managed the design and development of award-winning public and private sector projects for the last 10 years as a designer and project architect at Roth Sheppard. Rooted in a rigorous process where diagram and attention to detail are deliberate, Kelly's passion for design excellence and commitment to intimate understanding of client needs enables the work of Roth Sheppard to set new standards for the next generation of justice facilities and the communities they serve.

Mr. Smith's recent work includes the Town of Milliken Police Station and Meeting House, the Colorado State Patrol Troop Office and Regional Communications Center in Alamosa, Colorado, and the Houston Police Department's Fondren Station where the first of many substation prototypes for HPD is nearing completion. His portfolio also includes extensive private sector work on restaurant, retail and residential projects, both locally and regionally.

Eric Sifuentes

Nacht & Lewis Architects

Eric Sifuentes graduated from California State Polytechnic University at Pomona in 2006 with a Bachelor of Architecture. He has worked on a variety of modernization projects which have included accessibility upgrades to school sites. In April of 2010 Eric was certified as an access specialist under the California Access Specialist

Program administered by the California Department of General Services via the Division of the State Architect (CASp# 189). Current work in accessibility continues at Nacht & Lewis Architects with school modernization projects and consultation on the firm's justice projects which include courthouse and prison projects.

Eric has presented on accessibility at a CSI Product Show and during in-house sessions, each offering California Architect's Board credits required for licensure.

Raphael Sperry, AIA, LEED AP

Mr. Sperry provides strategic planning and LEED consulting as a Senior Consultant at Simon & Associates, Inc. Raphael's projects include high-rise development, industrial and infrastructure properties, facilities for higher education, and LEED for Existing Buildings: Operations and Maintenance. In 2009 Raphael led six major commercial buildings on the West Coast to earn LEED Gold certification in the Existing Buildings: Operations and Maintenance Rating System. He is the LEED consultant for six projects at San Francisco International Airport, including the new Terminal Two.

Mr. Sperry was appointed by the mayor to the City of San Francisco's Existing Buildings Energy Efficiency Task Force in 2009, and has served as the appointed public representative of the Municipal Green Buildings Task Force since 2004. He teaches classes on green architecture at Stanford University and California College of the Arts. Raphael also contributes to the public interest as a current board member and past president of Architects / Designers / Planners for Social Responsibility, where he conceived of and directs the Alternatives to Incarceration campaign, and as a former director of the San Francisco Planning and Urban Research Association (SPUR). In 2004 he was the lead author of the San Mateo Countywide Guide to Sustainable Building. In 2000, he was the architectural project manager for Ridge Vineyards' 17,000 sq. ft. straw-bale winery in Healdsburg, California—the largest straw-bale building in the country at that time.

S. Ernest Swickard, AIA

California Administrative Office of the Courts Office of Court Construction and Management

S. Ernest Swickard, AIA (NCARB certified) is the Assistant Director of the Administrative Office of the Courts (AOC), Office of Court Construction

and Management (OCCM) for Design and Construction Services. Working within the OCCM, Mr. Swickard is primarily responsible for implementation of the current and planned capital projects, as well as major facilities renovations and modifications program for California courts.

Craig Unger

Craig Unger is Principal/CEO of Unger Security Solutions, LLC, providing consulting services for acquisition management; project delivery; and the security and detention environment. He founded the business upon his retirement from the federal government in 2003. Craig was appointed by the Attorney General of the U.S. in 2001 to serve as the Justice Department's Federal Detention Trustee (OFDT), responsible for the oversight of detention of all federal prisoners and undocumented aliens. As a career civil servant, he achieved the highest leadership role (Senior Executive Service) as the Agency Head of the Justice Department's OFDT. Additionally, Craig served as President of the Design-Build Institute of America (DBIA 2003 – 2004) serving as the organization's lead spokesman and advocate for legislative, regulatory and government actions. Craig Unger is regarded as a leader of the integrated project delivery design-build movement in the public sector. Before joining DBIA, he served for 26 years at U.S. Department of Justice, primarily as the Procurement Executive for the Federal Bureau of Prisons where he led the Agency's design and construction program from a one-dimensional "low bid" approach to an integrated delivery system.

Tina Wells

Tina Wells has been with Hensel Phelps for 25 years. She has a BS in Construction from Cal Poly SLO. She has been involved at the project management level in design-build projects for the last 6 years, managing both design and construction phases of the work. She was the design manager on the \$142 million Alameda County Juvenile Justice Center working from the beginning of the proposal preparation stage through design completion. During her tenure in design build, she has worked with 7 different architectural firms, some with the project being their first venture into design-build or first teamed with Hensel Phelps. The architecture firms include: HOK, KMD, HKS, Fentress Architects, Steinberg Architects, WRNS and BCA. Her abilities to lead a team, listen, communicate, make decisions and have fun, have

proven to be assets in her role as design/project manager. Her design build experience ranges from juvenile detention facilities, community colleges, veteran housing facilities and hospital projects, with various levels of programming or bridging documents to begin. Several on the projects owners have been new to the design-build methodology and all have had positive experiences where they now look to design-build as their preferred procurement methodology. Her current project is a 175,000 sq.ft. support facility for Santa Clara Valley Medical Center with Fentress Architects that is for an owner new to design build and wanting to use the methodology to avoid costly change orders and schedule delays.

Rob Uvalle

California Administrative Office of the Courts Office of Court Construction and Management

Robert M. Uvalle, CCM, Manager of the Design and Construction Unit - North Central Regional Office for the Administrative Office of the Courts (AOC). Located in Sacramento, his team holds project responsibilities for 16 Capital Construction Projects with a total value of \$1.75 billion. They also support the ongoing Facility Modification program of existing Court buildings. Rob has been with the AOC since March 2005.

Prior to joining the AOC, Mr. Uvalle was a Project Director for the executive branch of the State of California (DGS) in a variety of major capital outlay projects. He began his career working for Perini International – Western region, a nationally recognized builder of large construction projects such as the Moscone Center in San Francisco. Subsequently, he was project director for Foundation Health Systems/Health Net where he managed the program development, design, construction and start-up of over 14 Health Care Centers throughout California with total project cost of approximately \$100 million.

With 23+ years in the construction project management profession he has a wide range of Program and Project Management experience. His experience includes private and public perspectives as both an Owner and Builder for medical office buildings, healthcare facilities, government projects and interior improvements, using Construction Manager at Risk, Pre-Qualified DBB, Design-Assist and other construction delivery methods. He holds degrees in both Construction Management and Communications.

Dan L. Wiley

Dan L. Wiley & Associates

Dan L. Wiley is President of Dan L. Wiley & Associates, Inc. (DWA) and has been involved with court management and planning for 30 years. Mr. Wiley previously served as Trial Court Administrator for the 15th Judicial Circuit of Florida. In 1992, he formed DWA and has successfully completed consulting engagements coast to coast in the areas of judicial facility evaluation and master planning, courthouse space programming, organization analysis and operations assessment. He has provided technical assistance in strategic planning, service delivery, pattern analysis, design review, security evaluation and planning, long range forecasting and project coordination and management. He has led court facility planning and court operations analysis projects throughout the United States.

John Woelfling, AIA, LEED AP **Dattner Architects**

John Woelfling of Dattner Architects is deeply committed to creating sustainable architectural solutions for urban environments. He leads Dattner Architects' firm-wide sustainability efforts, including the firm's AIA 2030 Commitment. John was the project manager on the Peter W. Rodino Building High Performance Building Modernization for the US General Services Administration. This ARRA-funded renovation is transforming the 465,000 sf federal office building into a dignified, inviting, and efficient Federal facility. His additional experience includes the LEED Platinum Battery Park City Parks Conservancy Maintenance Facility and Battery Park City's PS/IS 276, New York City's tallest and greenest public elementary school.

Leann Wooten **NAVFAC SW**

Leann Wooten has been engaged in the architectural profession for over 27 years. Leann is a registered architect in the State of California and LEED AP. She has been with Naval Facilities Engineering Command SW in the Capital Improvement business line since 2002. NAVFAC SW has been heavily engaged in the design-build arena since the mid-1990's with the majority of SW projects awarded as DB. Leann began her career with SW as Project Lead responsible for managing & developing DB Requests for Proposal (RFPs), participating in contract award process, as well as post award design development and construction oversight. She has worked on

a variety of DB projects over the last 9 years ranging from small demolition projects, BEQ's Hangars, and the 2010 multi-million dollar ARRA Camp Pendleton Replacement Hospital acquisition award. Recently, Leann have been engaged in a cross functional group working to streamline SW's DB acquisition evaluation process.

Kyle Yardley, AIA, LEED AP

Kyle Yardley has 23 years of experience in the technical design and construction of complex projects. While at Roth Sheppard Architects, Mr. Yardley has been responsible for a variety of public safety projects, including police and fire stations, jails, a courthouse remodel, emergency call center, firing ranges and various training facilities for police and fire.

Mr. Yardley is the 2011 National Conference Law Enforcement Chair. He was also involved in the development of the LAPD Police Administration Building and will facilitate tours.

EXHIBITOR INFORMATION

Acorn Engineering Company

15125 Proctor Ave
City of Industry CA 91746
(626) 336-4561
www.acorneng.com

Acorn Engineering manufactures plumbing fixtures, products and systems for institutional and commercial markets. / AcornVac designs, engineers, manufactures, and markets environmentally friendly vacuum plumbing systems.

Ameristar Fence Products

Headquarters
1555 N. Mingo Rd
Tulsa, OK 74116
www.ameristarfence.com

Ameristar®, based in Tulsa, Okla., is the largest ornamental fence manufacturer in the world. From its beginnings over a quarter-century ago, Ameristar® concentrated on enhancing the aesthetic appearance of modern fence products, promoting ease of installation, while increasing strength & durability. Pursuing this focus, Ameristar designed and built a new, environmentally friendly, high-production facility. This resulted in the creation of the highest quality residential, commercial, industrial and high-end security fences in today's market place.

Arconas

5700 Keaton Crescent
Mississauga, ON, L5R 3H5
905) 272-0727
www.arconas.com

Arconas is recognized around the world as a leading designer and manufacturer of exceptional furniture for high-traffic public spaces. We have developed significant expertise in providing the right seating solutions for courthouses, detention, correction, and enforcement facilities. We manufacture with a commitment to excellence, safety, and environmental stewardship.

BASWaphon

3900 Ben Hur Avenue, Suite 10
Willoughby, Ohio 44094
440.951.6022
www.baswaphon.com

BASWaphon Seamless Sound Absorbing Plaster. Premium finish with NRC ratings up to 1.00. Can be vaulted, curved or domed. Match any color. Completely field installed, eliminating incorrect pre-cut dimensions. Up to 95% recycled, no VOC's, USA made components, possibly provides points in 9 LEED categories. Custom finishes. Historical courtroom renovations.

CCC Group, Inc.

5797 Dietrich Road
San Antonio, TX 78219
(210) 662-1610
www.cccgroupinc.com

CCC Group, Inc. provides the engineering, procurement, project management and installation services required to integrate complete lines of physical and electronic security products in turnkey packages for new and existing correctional facilities.

Chief Custom Products

At Chief Custom Products, our five-plus decades of experience in metal fabrication assure optimum quality, strength and security throughout our full range of correctional products. As a manufacturer of detention doors & frames, windows, furnishings, wall panels, and ceilings, we go the extra mile to assure you maximum value for your facility.

Correctional News

1241 Andersen Drive, #N
San Rafael, CA 94901
(415) 460-6185
www.correctionalnews.com

Founded in 1994, Correctional News is the only news magazine specifically dedicated to correctional facility construction, maintenance and operations. Widely read by facility operators and managers as well as architects, contractors and suppliers, Correctional News has become a must read business news publication in this unique market.

Dlubak Corporation

520 Chestnut Street,
P.O. Box 510
Blairsville, PA 15717
(800) 336-0562
www.dlubakcorporation.com

Dlubak Corporation is a manufacturer of forced entry, bullet, and blast resistant glass-clad and laminated polycarbonates for the correctional, embassy, and military vehicle markets as well as other secure structures.

Graham Architectural Products

1551 Mount Rose Avenue
York, Pennsylvania 17403
(717) 849-8100
www.grahamwindows.com

Graham Architectural Products has built its reputation on custom engineered window solutions for

a variety of architectural applications including fixed and operating windows, blast and impact mitigation windows and doors, acoustic windows, curtain wall, storefront and sunshades. Graham is your single source for engineered solutions for your commercial fenestration needs.

Hope's Windows, Inc.

84 Hopkins Avenue
P.O. Box 580
Jamestown, NY 14702-0580
(716) 665-5124
Fax: (716) 665-6107
www.hopeswindows.com

Hope's® is the leading manufacturer of fixed and operable steel and stainless steel detention windows. Our product versatility in secure and non-secure windows and doors allows specifiers to benefit from "the turnkey solution" for all windows and doors. Stream-lined communication leads to savings in time, enhanced coordination and cost effectiveness while maintaining single-source accountability.

Infax

4250 River Green Pkwy
Suite D
Duluth, Georgia 30096
(678) 533-4025
www.courtsight.com

Guide your patrons with a system from Infax. We design, build, and maintain electronic information display systems. Our products help people find their way through airports, train stations, and courthouses. We provide the capability for our clients to communicate to their customers' relevant information such as case information, jury assembly, room scheduling, emergency alerts, and advertising.

JG Innovations, Inc.

P.O. Box 8128
Janesville, WI 53547
(888) 933-2248
www.jgius.com

JG Innovations offers custom interior soffit systems that are designed to conceal any type, size or combination of Fire Sprinkler Systems, Plumbing, Hydronic Piping, HVAC, Electrical or Cable/IT Wiring in an aesthetically pleasing and protective manner. Look to our products for superior solutions and unmatched service when you specify your next institutional, commercial, new construction or retrofit project.



Kane Detention

515 North Fraley Street
Kane, PA 126735
(800) 952-6399
www.kanedetention.com
www.kanescreens.com

KANE Detention is a manufacturer of cell fronts, ceilings, window protection, outdoor rec yards, interview rooms, access doors, US Marshal secured areas, furniture, sally ports, portable holding cells, FBI/GSA commercial properties, stairwells and corridors and more. KANE has over 100 yrs of manufacturing experience.

LIFT U Division of Hogan Mfg., Inc.

P.O. Box 398
Escalon, CA 95320
(209) 838-2400
www.lift-u.com

LIFT U's Courtroom Lifts are advancing Courtroom Accessibility. With innovations like drift free platform support, rigid platforms, out of sight until needed roll up barriers, and the NEW Powered Front Step that converts from a step to the entrance ramp, LIFT U leads the way in reliable, invisible when not in use, and totally independently operable Courtroom Lifts.

Marathon Engineering Enterprises Marathon Engineering Corporation/ DECOfloor Systems

5615 2nd Street West
Lehigh Acres, FL 33971
(239) 303-7378
www.goldmedalsafetypadding.com
www.thedecofloor.com

Manufacturer and installer of gold medal safety padding that provides owners with safe, durable, and easily maintained padded environments. Our padding is specially formulated providing protection in jails, hospitals, detention facilities, schools, and more where are of safety is needed.

Norix

Norix Group, Inc.
1000 Atlantic Drive
(800) 234-4900
www.norix.com

For over 25 years, Norix Group has specialized in providing high quality, intensive-use furniture designed specifically for Correctional facilities. Norix builds extreme durability and security into each piece of furniture. We provide furniture that's as tough as your environment. Norix offers a complete range of furniture for every correctional application.

Oldcastle Products

Oldcastle Precast
200 Keystone Drive
Telford, PA 18969
(215) 453-3605
www.oldcastleprecast.com

Manufacturer of precast concrete correctional cells and modular building components. Custom designed quality prison cells cost effectively. In addition we provide complete perimeter security systems or replacement parts for your existing system. Digital Microwave with Fuzzy Logic, Non Lethal Electric Fence Systems, Infra red Detection Systems and Fence Mounted Cable Detection Systems.

Pyrok, Inc.

Pyrok Inc. manufactures Pyrok StarSilent a new, smooth, seamless sound absorbing plaster system and Pyrok Acoustement acoustical plasters which have formulations for courthouse and correctional facility applications.

Renovo Software

5666 Lincoln Drive, Suite 206
Edina, MN 55436
(952) 931-0790
www.renovosoftware.com

Minneapolis-based Renovo Software is a leading developer of solutions for the video communications industry. Specifically, Renovo partners with customers to design, develop and support powerful, flexible and scalable software solutions that schedule, automate and manage complex video networks.

Rotondo Weirich

681 Harleysville Pike
Lederach, PA 19450
(215) 256-7940
www.rotondoweirich.com

RW is a specialty precast firm; providing durable, sustainable, and secure concrete housing for the global and domestic correctional, military, residential, and hospitality markets. Our unprecedented local or onsite building method allows us to make a positive local economic impact in each area that we build. In addition, it provides for fast construction, unmatched by conventional building methods. We hire specialized, entrepreneurial employees, ensuring that we provide the best quality product, for the best price, in the best way to meet the client's needs.

Thermomass

1000 Technology Drive
Boone, Iowa 50036
(800) 232-1748
www.thermomass.com

At Thermomass, we're passionate about high-performance walls. For over thirty-years, we have helped our clients design and build concrete sandwich walls that exceeded their specifications for durability, energy-efficiency and environmental responsibility. We learned long ago that the best projects are built on two cornerstones: superior products and trusted partnerships.

T.L. Shields & Associates

P.O. Box 6845
Thousand Oaks, CA 91359
(800) 954-3887
www.tshield.net

T.L. Shield has developed the perfect accessibility lift for use where the aesthetic look is important as well as superior lifting capabilities. Installed in courtrooms all across the country, the Invisible Lift could be the perfect solution for your project.

Trussbilt

550 Oak Grove Parkway
Vadnais Heights, Minnesota 55127-8509
(651) 633-6100
www.trussbilt.com

Trussbilt has designed and manufactured high quality security products since 1926. Trussbilt's products are used in over 2,000 prisons throughout the world. We have developed and pioneered performance tests that demonstrate the superiority of hollow metal fabrication for security.

CONFERENCE MAP

GALERIA

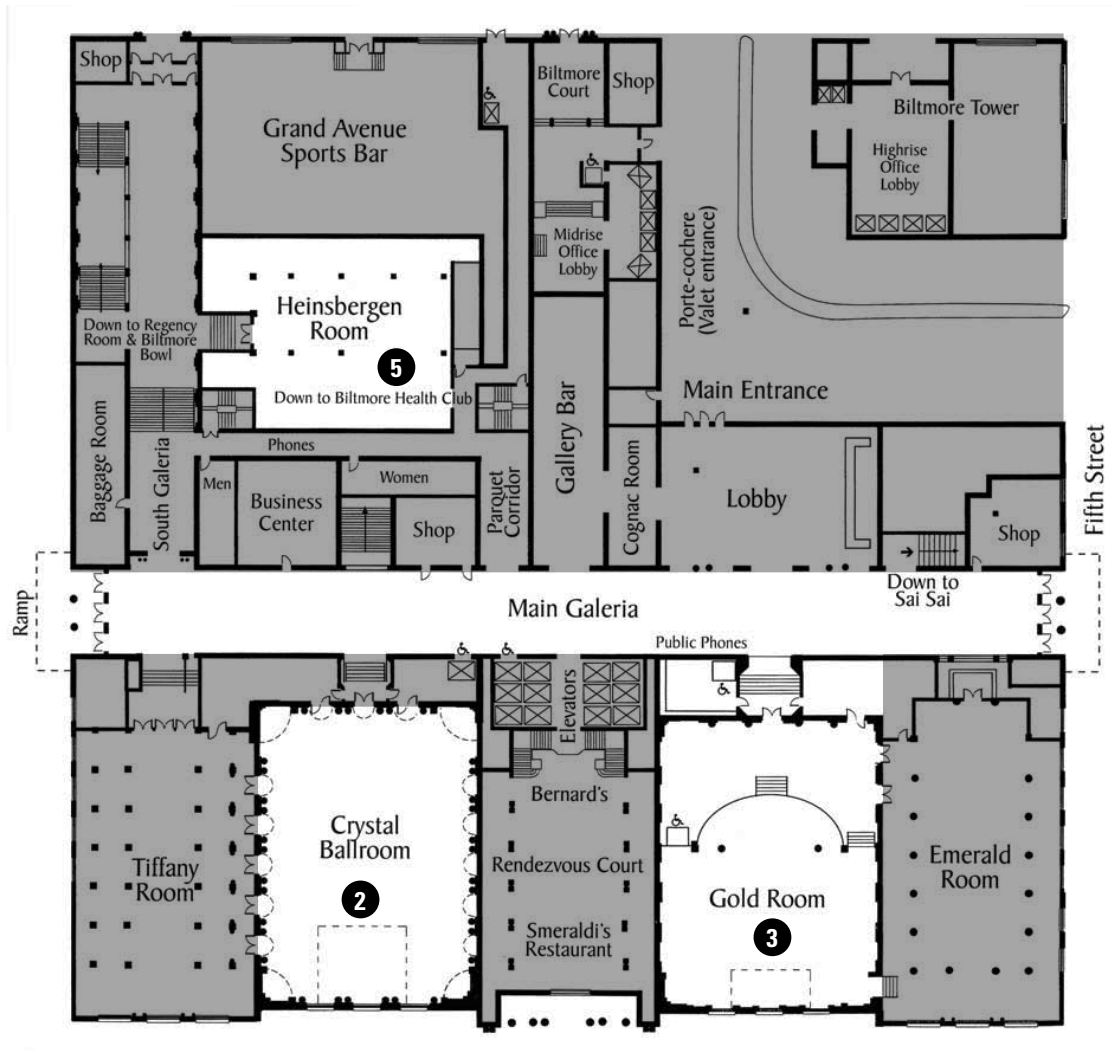

- | | | |
|---|--|---|
| <p>1 BOWL FOYER
REGISTRATION
JFR GALLERY</p> <p>2 CRYSTAL BALLROOM
OPENING PLENARY
THURSDAY KEY-NOTE LUNCH
FRIDAY BREAKFAST
CLOSING PLENARY</p> | <p>3 GOLD ROOM
JFR BANQUET</p> <p>4 BILTMORE BOWL
EXHIBITS
RECEPTION
THURSDAY PM BREAK</p> | <p>5 HEINSBERGEN ROOM
COURT TRACK SESSIONS</p> <p>6 CORINTHIAN ROOM
LAW ENFORCEMENT/ OTHER
TRACK SESSIONS</p> <p>7 ROMAN ROOM
CORRECTIONS TRACK SESSIONS</p> |
|---|--|---|



CONFERENCE / MEZZANINE LEVEL

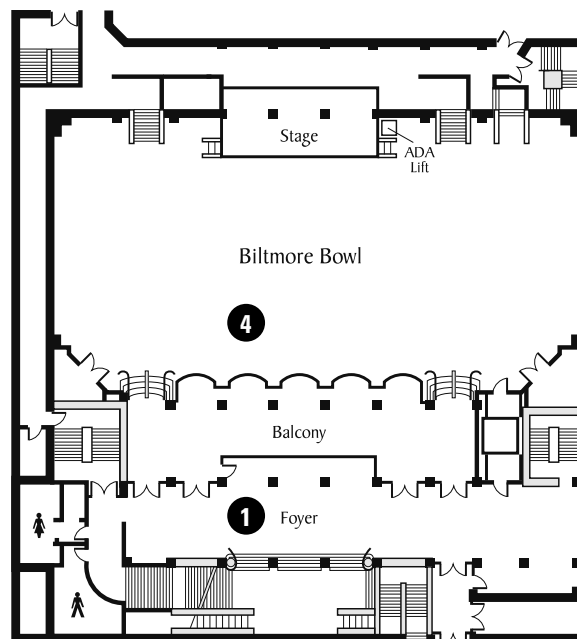
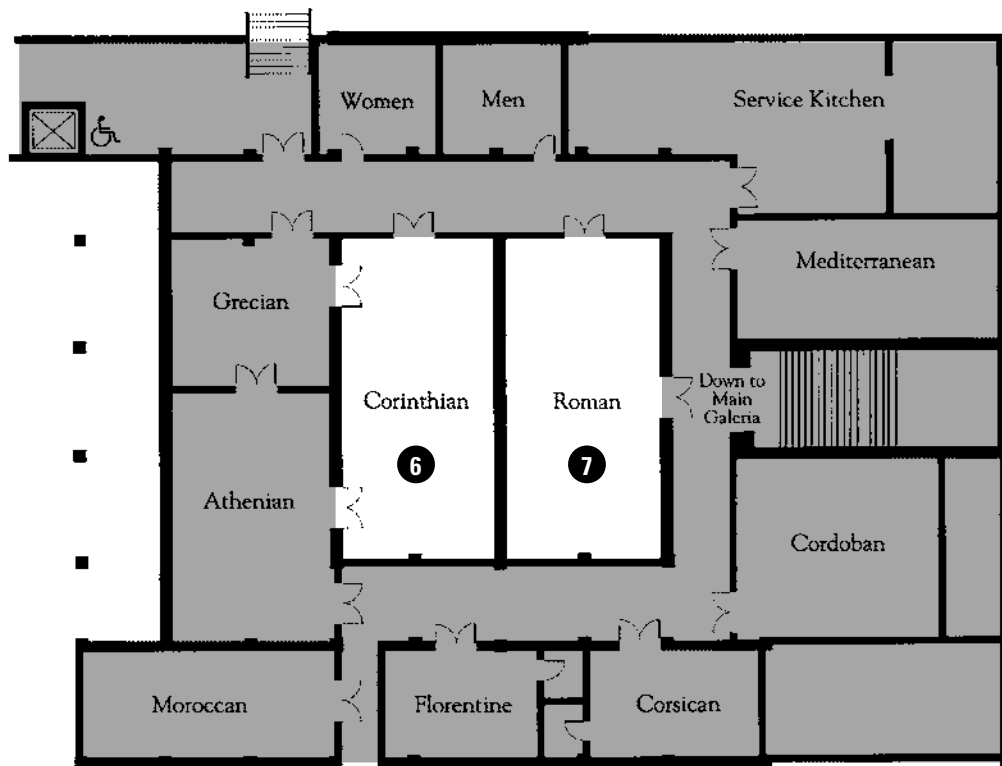

**SOUTH
GALERIA**



EAT, SEE, & PLAY IN DOWNTOWN L.A.

RESTAURANTS IN DOWNTOWN LA (ARCHITECT FAVORITES)

Phillippes: The Original French Dip

213.628.3781 | 1001 North Alameda Street
1930's era sandwich house across from Union Station
Price: \$

The Firehouse (American)

310.396.6810 | 213 Rose Avenue, Venice, CA 90291
Turn of century firehouse converted into restaurant
Price: \$\$

Takami Sushi and Robata

213.623.7100 | 811 Wilshire Boulevard, Suite 2100
Fantastic rooftop views, exquisite food
Price: \$\$\$

Mas Malo

213.985.4332 | 515 W. 7th Street
Fusion Mexican cuisine out of SilverLake, now in downtown
Price: \$\$

Nick + Stef's Steakhouse

213.680.0330 | 330 South Hope Street
Price: \$\$\$

The Water Grill (Seafood)

213.891.0900 | 544 South Grand Avenue
Around corner from the Biltmore, world class seafood
Price: \$\$\$

Blossom (Vietnamese)

213.623.1973 | 426 S. Main Street
Vietnamese pho and other everyday dishes
Price: \$

Daikokuya (Japanese)

213.626.1680 | 327 E. 1st Street
Popular ramen house in heart of Little Tokyo
Price: \$

Patina (French)

213.972.3331 | 141 South Grand Avenue
Award winning architecture by Hagy Belzberg, ground floor of
Disney Concert Hall
Price: \$\$

Lazy Ox Canteen (Gastropub)

213.626.5299 | 241 S. San Pedro Street
Hip newcomer to downtown
Price: \$\$\$

Drago Centro

213.228.8998 | 525 South Flower Street
Huge windows and a leaning tower of wine accompany fantastic
Italian fare
Price: \$\$\$

Chaya Downtown

213.236.9577 | 525 South Flower Street
Asian fusion
Price: \$\$\$

Cole's / Varnish

213.622.9999 | 118 E. 6th Street
The OTHER original French dip, with a cocktail-focused speak-
easy in the back
Price: \$\$

Bottega Louie

213.802.1470 | 700 South Grand Avenue
Excellent Italian, pizza, pastries and LA coffee, if a bit loud
Price: \$\$

Church & State

213.405.1434 | 1850 Industrial Street
French tidbits in a converted industrial space surrounded by lofts
and warehouses
Price: \$\$\$

Yxta Cocina Mexicana

213.622.5540 | 601 South Central Avenue
Delicious upscale Mexican with a stellar happy hour in raw environs
Price: \$\$

Wurstkuche

213.687.4444 | 800 E. 3rd Street
German gastropub with extensive sausage and beer selection
\$\$

Many national chains in LA Live



NEARBY ATTRACTIONS

El Pueblo de Los Angeles Historical Monument at Olvera Street

El Pueblo de Los Angeles Historical Monument, also known simply as Olvera Street, is the location of the oldest remaining structure in Los Angeles, the Avila Adobe. The building itself is often overlooked, since people are primarily drawn to Olvera Street for its Mexican street market and shops that offer a taste of old Mexico.

Chinatown

Chinatown in downtown Los Angeles, sometimes known as New Chinatown, was developed around the Central Plaza in 1938, just west of Old Chinatown, where Union Station is now. Before the move, this area was LA's Little Italy, and is still home to St. Peter's Italian Church and Casa Italiana Cultural Center. The neon pagoda lights and lanterns at Central Plaza make a colorful display at night.

Little Tokyo

Little Tokyo is the Japanese cultural center of Los Angeles, with Japanese shops, restaurants and bakeries populating a few short blocks. Of special note is the Japanese-American National Museum, dedicated to the experience of Americans of Japanese ancestry.

The Fashion District

The Fashion District is a great place to shop for bargain clothes, textiles and flowers. People who can fit into sample sizes will find extreme bargains on designer garb. The Fashion District website includes a photo tour as well as a podcast tour you can download.

Museum of Contemporary Art

The Museum of Contemporary Art (MOCA) is located just down Grand Avenue and across the street from the Music Center and Disney Concert Hall. The museum's collection and touring exhibits feature work created since 1940.

L.A. Live and Staples Center

L.A. Live is a dining and entertainment complex next to the Staples Center in Downtown LA. Multiple live entertainment venues and restaurants surround the Nokia Plaza, which is adorned with a series of high definition outdoor screens with synchronized content to give a "bright lights, big city" feel of a miniature Times Square.

Los Angeles Central Library

Admire the Art Deco architecture, explore the public art installations and temporary exhibits, settle in to read a newspaper or book in any of a dozen languages, or check your e-mail online. There are also extensive public programs including author readings, lectures, discussion panels and performances.

Los Angeles Conservancy Downtown Walking Tours

The Los Angeles Conservancy offers a variety of weekend walking tours featuring different sections of Downtown Los Angeles.

BICYCLE TOURS



Bikes and Hikes LA – LA's 1st and #1 bike/hike touring company invites members of the American Institute of Architects to experience Los Angeles the eco-friendly, health conscious way.

Some of our bike tours:

- **LA IN A DAY Bike Adventure**
start in West Hollywood, bike through Beverly Hills and Bel Air, then hit the beaches exploring Santa Monica and Venice and then return—it's a 32 mile, calorie crunching UNBELIEVABLE tour of the city.
- **LA Bike Architecture tour**
Appreciating architecture on two wheels is a totally different state of mind that riding around in your car. Cruise past residential homes by the likes of Lautner, Ellwood, Schindler and Wright.
- **ULTIMATE HOLLYWOOD TOUR**
See Hollywood up close and personal with this tour which hits every major attraction and includes entrance to the Madame Tussaud's wax museum.
- **CELEBRITY HOMES BIKE RIDE**
See where the stars live and play in this intimate tour of Beverly Hills and Bel-Air which includes a walking tour of the legendary Greystone Mansion.

Book your spot and get more information by visiting: www.bikesandhikesla.com

Danny Roman
Bikes and Hikes LA
8743 Santa Monica Boulevard
West Hollywood, CA 90069
323-796-8555

SATURDAY WORKSHOP

Towards a Sustainability Rating System for Justice

Saturday, November 5, 2011

9:00 - 2:00PM

LJ Workshop, Aecom, 555 South Flower Street, Suite 3700

Course Registration Required

Course Description

Justice facilities have specific requirements that are not addressed by the LEED rating system. Design innovations are being implemented but this progress is incremental, uncoordinated, and beset by institutional obstacles. The AIA-AAJ Sustainability Committee is now working to create an overlay of the LEED rating system to guide architects working on justice projects to higher levels of design and sustainability.

Participating in the collaborative efforts of the AIA-AAJ Sustainability Committee will inform attendees about meaningful, effective and sustainable green solutions for justice facilities and for the justice system, and give attendees an opportunity share their experience and feedback. Specific methodologies and processes for achieving green goals for justice projects will be described including existing, "innovative" LEED points, and LEED pilot credits; options for new as well as existing buildings; and operations and maintenance.

Four Learning Objectives

1. Learn how existing LEED credits are applied to justice facilities
2. Gain knowledge about innovation options that may serve as pilot credits
3. Learn how Existing Buildings Operations & Maintenance issues are applied to justice facilities
4. Gain tools to help clients connect sustainable building goals with the goals of a sustainable community, with a focus toward social justice and economic development

HSW and/or Sustainable Design Credits

1.5 LU / 1.5 LU

GOLD LEVEL SPONSORSHIP BY

SKANSKA

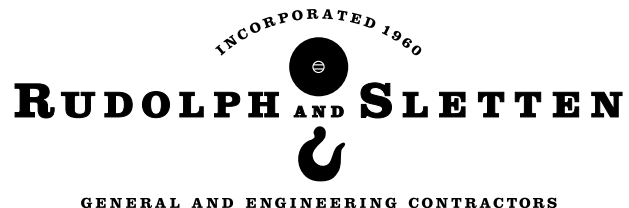

NOTES

This image shows a single sheet of white paper with horizontal ruling lines. The lines are evenly spaced and run across the width of the page. There are no margins, text, or other markings on the paper.

CONFERENCE GRAPHICS AND PROGRAM:
STEVEN FONG, NACHT & LEWIS ARCHITECTS

